

# Royal

## DIAGRAM

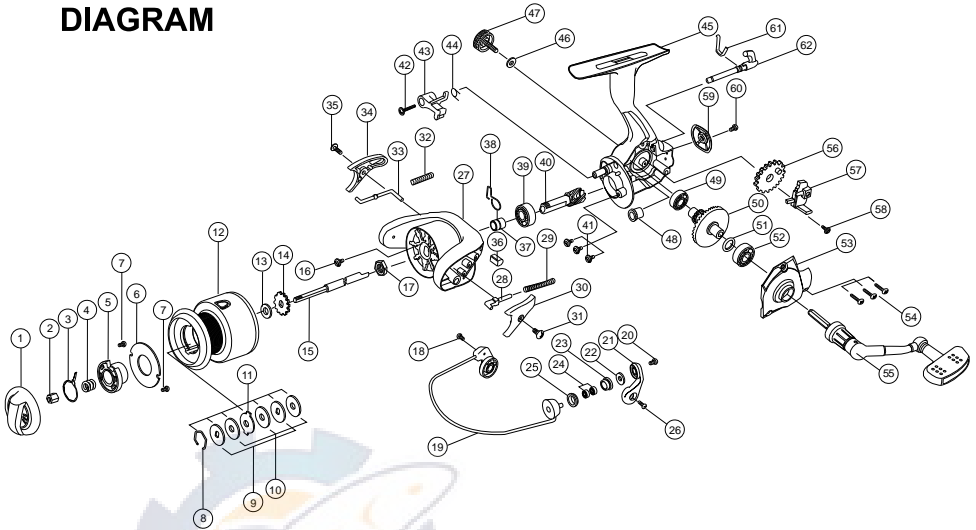

## PART LIST

No.	Part List	No.	Part List	No.	Part List
1.	Drag Knob	22.	Bail w/s	43.	Stopper
2.	Drag Nut	23.	Line Roller	44.	Stopper Spring
3.	Drag Click Claw	24.	Ball Bearing 4 x 7 x 2.5	45.	Body
4.	Drag Coil Spring	25.	Line Roller Bush	46.	Dust Cover w/s
5.	Front Drag Under Cap	26.	Arm Lever s/c	47.	Dust Cover
6.	Drag Knob Cover	27.	Rotor	48.	Main Shaft Bush
7.	Drag Knob Cover s/c	28.	Bail Spring Holder	49.	Ball Bearing 7 x 11 x 2.5
8.	Spool Ring	29.	Bail Spring	50.	Drive Gear
9.	Spool "D" w/s	30.	Bail Spring Cover	51.	Drive Gear Adj. w/s
10.	Spool "B" w/s	31.	Bail Spring Cover s/c	52.	Ball Bearing 7 x 13 x 4
11.	Spool "A" w/s	32.	Kick Lever Spring	53.	Body Cover
12.	Spool Assy	33.	Kick Lever	54.	Body Cover s/c
13.	Spool Adj. w/s	34.	Kick Lever Cover	55.	Handle Assy
14.	Click Gear	35.	Kick Lever Cover s/c	56.	O/S Gear
15.	Main Shaft	36.	Side Balance	57.	O/S Slider
16.	Rotor Nut Lock s/c	37.	Silent Spring Holder	58.	Main Shaft s/c
17.	Rotor Nut	38.	Silent Spring	59.	Body Rear Cap
18.	Bail Holder s/c	39.	Ball Bearing 7x 13 x 4	60.	Body Rear Cap s/c
19.	Bail Assy	40.	Pinion Gear	61.	Stopper Lever Spring
20.	Bail s/c	41.	Pinion Bearing s/c	62.	Stopper Lever
21.	Arm Lever	42.	Stopper s/c		