

### DIAGRAM

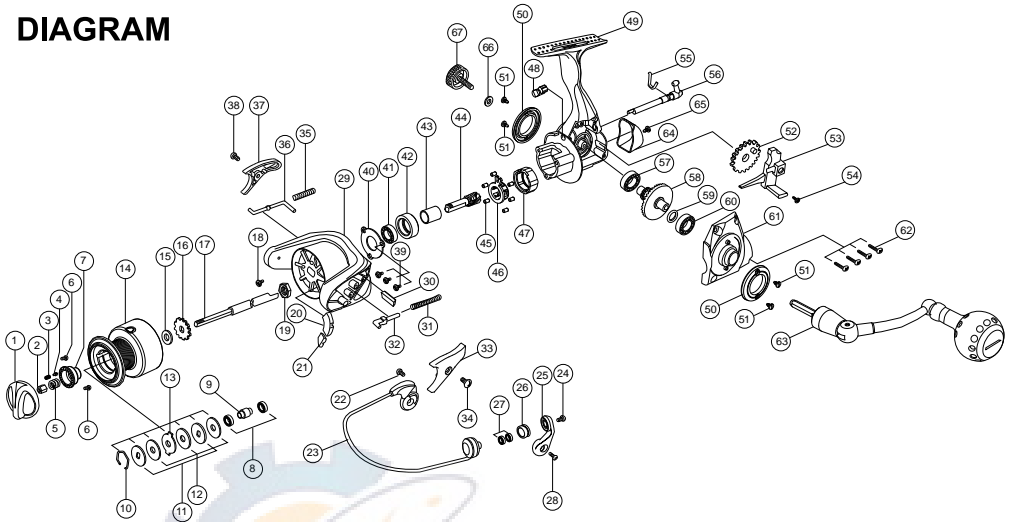

### PART LIST

No.	Part List	No.	Part List	No.	Part List
1.	Drag Knob	24.	Bail s/c	47.	One Way Housing
2.	Drag Nut	25.	Arm Lever	48.	One Way Cam
3.	Drag Click Spring	26.	Line Roller	49.	Body
4.	Drag Click Pin	27.	Ball Bearing 5 x 8 x 2.5	50.	Body Side Cap
5.	Drag Coil Spring	28.	Arm Lever s/c	51.	Body Side Cap s/c
6.	Drag Under Cap s/c	29.	Rotor	52.	O/S Gear
7.	Drag Under Cap	30.	Side Balance	53.	O/S Slider
8.	Ball Bearing 5 x 9 x 3	31.	Bail s/p	54.	Main Shaft s/c
9.	Spool Bush	32.	Bail s/p Holder	55.	Stopper Lever s/p
10.	Spool Ring	33.	Bail s/p Cover	56.	Stopper Lever
11.	Spool "D" w/s	34.	Bail s/p Cover s/c	57.	Ball Bearing 8 x 14 x 4
12.	Spool "B" w/s	35.	Kick Lever s/p	58.	Drive Gear
13.	Spool "A" w/s	36.	Kick Lever	59.	Drive Gear Adj. w/s
14.	Spool Assy	37.	Kick Lever Cover	60.	Ball Bearing 8 x 14 x 4
15.	Spool Adj. w/s	38.	Kick Lever Cover s/c	61.	Body Cover
16.	Click Gear	39.	Ball Bearing Cover s/c	62.	Body Cover s/c
17.	Main Shaft	40.	One Way B/B Cover	63.	Handle Assy
18.	Rotor Nut Lock s/c	41.	Ball Bearing 8 x 14 x 4	64.	Body Rear Cap
19.	Rotor Nut	42.	Ball Bearing Holder	65.	Body Rear Cap s/c
20.	Center Balance	43.	One Way Sleeve	66.	Dust Cover w/s
21.	Center Balance	44.	Pinion Gear	67.	Dust Cover
22.	Bail Holder s/c	45.	One Way Pin Roller		
23.	Bail Assy	46.	One Way Pin Roller Retainer		