

## DIAGRAM

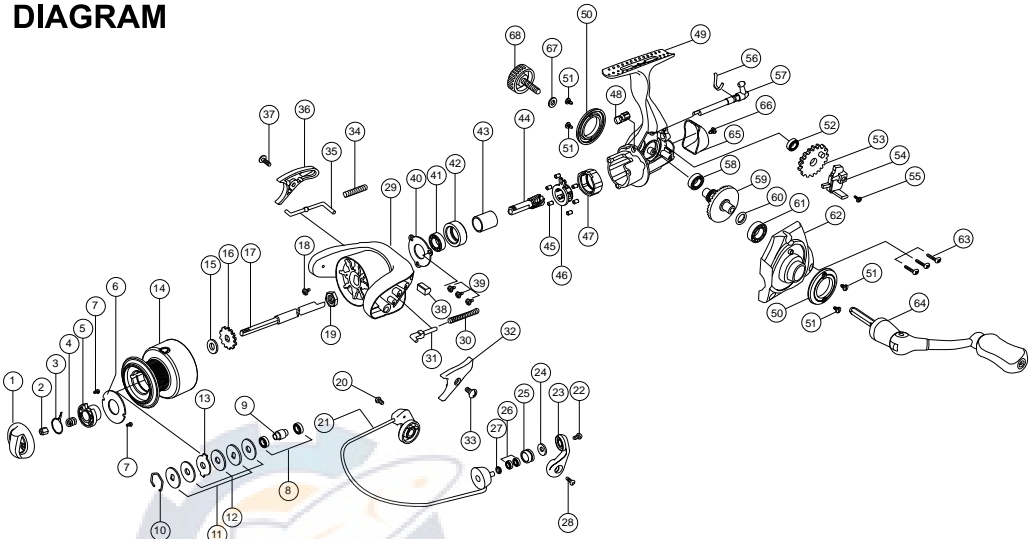

## PART LIST

No.	Part List	No.	Part List	No.	Part List
1.	Drag Knob	24.	Bail w/s	47.	One Way Housing
2.	Drag Nut	25.	Line Roller	48.	One Way Cam
3.	Drag Click Claw	26.	Ball Bearing 5 x 8 x 2.5	49.	Body
4.	Drag Coil s/p	27.	Line Roller Bush	50.	Body Side Cap
5.	Front Drag Under Cap	28.	Arm Lever s/c	51.	Body Side Cap s/c
6.	Drag Knob Cover	29.	Rotor	52.	Ball Bearing 5.5 x 10 x 2.5
7.	Drag Knob Cover s/c	30.	Bail s/p	53.	O/S Gear
8.	Ball Bearing 5 x 9 x 3	31.	Bail s/p Holder	54.	O/S Slider
9.	Spool Bush	32.	Bail s/p Cover	55.	Main Shaft s/c
10.	Spool Ring	33.	Bail s/p Cover s/c	56.	Stopper Lever s/p
11.	Spool "D" w/s	34.	Kick Lever s/p	57.	Stopper Lever
12.	Spool "B" w/s	35.	Kick Lever	58.	Ball Bearing 7 x 11 x 2.5
13.	Spool "A" w/s	36.	Kick Lever Cover	59.	Drive Gear
14.	Spool Assy	37.	Kick Lever Cover s/c	60.	Drive Gear Adj. w/s
15.	Spool Adj. w/s	38.	Side Balance	61.	Ball Bearing 7 x 13 x 4
16.	Click Gear	39.	Ball Bearing Cover s/c	62.	Body Cover
17.	Main Shaft	40.	One Way B/B Cover	63.	Body Cover s/c
18.	Rotor Nut Lock s/c	41.	Ball Bearing 7 x 13 x 4	64.	Handle Assy
19.	Rotor Nut	42.	Ball Bearing Holder	65.	Body Rear Cap
20.	Bail Holder s/c	43.	One Way Sleeve	66.	Body Rear Cap s/c
21.	Bail Assy	44.	Pinion Gear	67.	Dust Cover w/s
22.	Bail s/c	45.	One Way Pin Roller	68.	Dust Cover
23.	Arm Lever	46.	One Way Pin Roller Retainer		