

8100G

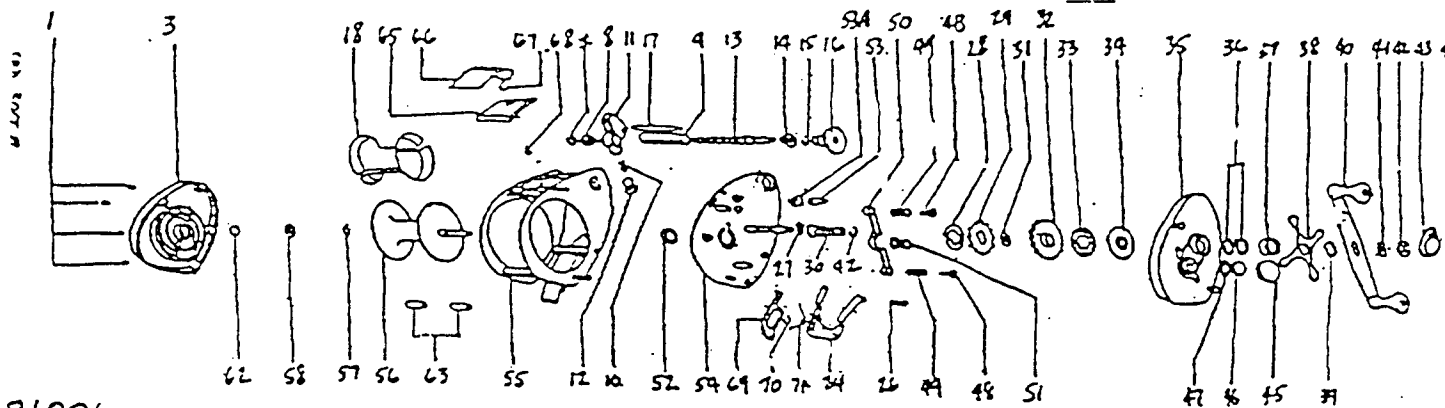

8100G

REF#	PART #	DESCRIPTION	REF#	PART#	DESCRIPTION
1	91-1	LEFT SIDEPLATE SCREW	43	91-43	HANDLE LOCK PLATE
3	81G-3	LEFT SIDEPLATE	44	91-44	HANDLE LOCK PALTE SCREW
7	91-7	LEFT SIDELEADSCREW RET.	45	91-45	END PLAY NUT
8	91-8	LEFT SIDE LEAD BUSHING	46	91-46	END PLAY SPOOL SHIM
9	81-9	LEADSCREW COVER	47	91-47	END PLAY NUT"O" RING
10	91-10	LEVELWIND PAWL	48	91-48	YOKE POST SCREW
11	91-11	LEVELWIND PAWL	49	91-49	PINION YOKE SPRING
12	91-12	LEVELWIND GUIDE	50	91-50	PINION YOKE
13	81-13	LEADSCREW	51	91-51	PINION GEAR
14	91-14	RT. SIDE LEADSCREW BUSH	52	91-52	RIGHT BEARING
15	91-15	RT. SIDE LEADSCREW RET.	53	81-53	A/R PAWL
16	91-16	LEADSCREW GEAR	53	81-53A	A/R PAWL SPRING
17	91G-17	LEVELWIND CROSSBAR	54	91G-54	GEAR PLATE
18	81-18	SPOOL ARBOR	55	81G-55	MAIN FRAME
20	91-20	FREE SPOOL BUTTON"C"CLIP	56	81-56G	SPOOL
24	91-24	FREE SPOOL LEVER	57	91-57	BEARING RETAINER
26	95-26	FREE SPOOL LEVER	58	81-52	LEFT BEARONG
27	91-27	HANDLE POST SHIM	62	91-62	LEFT SIDE SPOOL END SHIM
28	91-28	FREE SPOOL SLIDE SHIM	63	81-63	BRAKE SHOES
29	91-29	A/R RATCHET	65	81G-65	FREE SPOOL SIDE SWITCH
30	91-30	HANDLE SHAFT	66	81G-66	SLIDE SWITCH COVER
31	91-31	RATCHET DISC	67	95-67	SLIDE SWITCH CLIP
32	91-32	MAIN DRIVE GEAR	68	95-68	SLIDE SWITCH PIN
33	91-33	FRICTION WASHER	69	95-64	FREE SPOOL SLIDE
34	91-34	DRAG WASHER	70	95-70	SLIDE SPRING RETAINER CLIP
35	81G35	RIGHT SIDE PALTE	71	95-71	SLIDE RETURN SPRING
36	91-36	DRAG SPRING WASHER			
37	91-37	HANDLE SHAFT WASHER			
38	95-38	DRAG WASHER			
39	91-39	HANDLE SPRING WASHER			
40	91-40	HANDLE ARM			
41	91-41	HANDLE NUT			
42	91-42	HANDLE PIN CLIP			