

sears
897

22006X-035

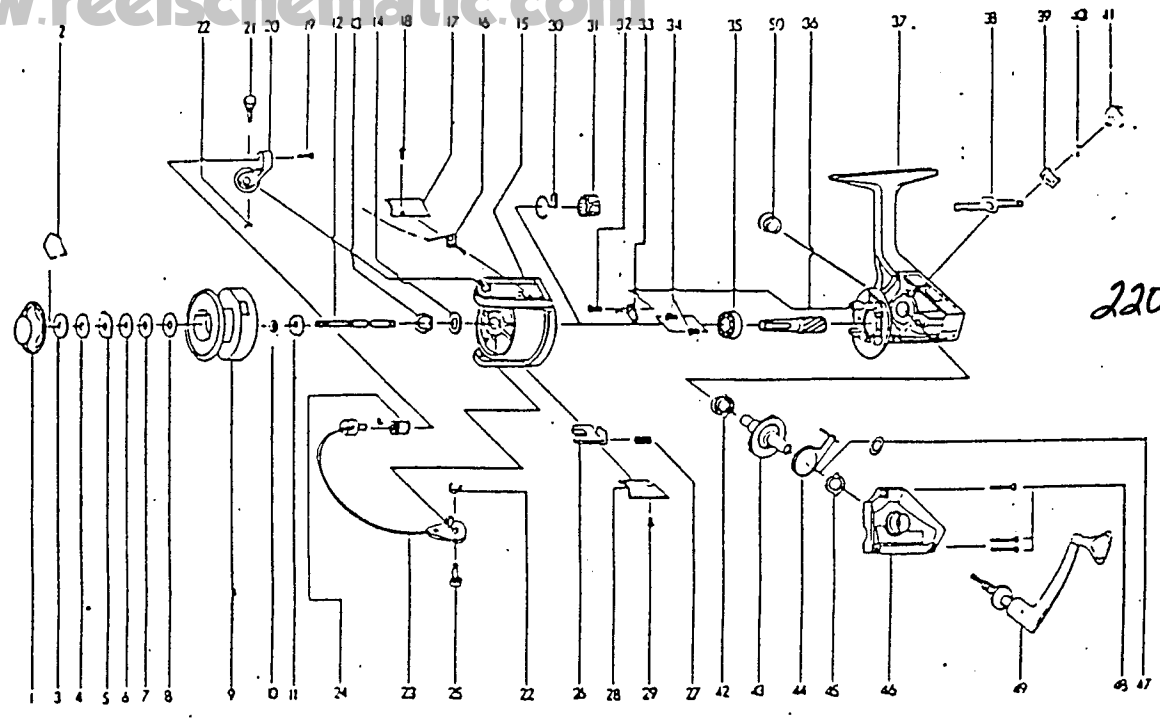

22006X-035

REF #	PART NUMBER	DESCRIPTION	REF #	PART NUMBER	DESCRIPTION
1	79-40-0171-01	DRAG KNOB ASS'Y	32	79-58-0576-01	A.R. STOPPER S/C
2	79-54-0121-01	SPOOL RETAINER	33	79-37-0177-01	A.R. STOPPER
3	79-72-0581-01	SPOOL "D" W/S	34	79-58-0571-01	BEARING S/C
4	79-72-0585-01	SPOOL "B" W/S	35	79-04-0062-01	BALL BEARING
5	79-72-0606-01	SPOOL "A" W/S	36	79-46-0093-01	PINION GEAR
6	79-72-0585-01	SPOOL "B" W/S	37	79-27-0162-01	BODY
7	79-72-0581-01	SPOOL "D" W/S	38	79-11-0052-01	A.R. CAM
8	79-72-0585-01	SPOOL "B" W/S	39	79-67-0614-01	A.R. PLATE S/P
9	79-66-0249-01	SPOLL ASS'Y	40	79-45-0043-01	A.R. LEVER PIN
10	79-72-0594-01	SPOOL ADJ W/S	41	79-37-0173 01	A.R. LEVER
11	79-43-0120-01	CLICK CLAW	42	79-07-0018-01	BODY BUSHING
12	79-60-0131-01	MAIN SHAFT	43	79-28-0164-01	DRIVE GEAR
13	79-40-0174-01	ROTOR NUT	44	79-64-0058-01	O/S SLIDER ASS'Y
14	79-72-0598-01	ROTOR RETAINER W/S	45	79-09-0018-01	BODY C/V BUSHING
15	79-37-0134-01	ROTOR	46	79-19-0088-01	BODY COVER
16	79-67-0619-01	BAIL SPRING	47	79-72-0599-01	DRIVE GEAR ADJ W/S
17	79-19-0100-01	BAIL S/P COVER	48	79-58-0573-01	BODY COVER S/C
18	79-58-0577-01	BAIL S/P C/V S/C	49	79-20-0139-01	HANDLE ASS'Y
19	79-58-0562-01	BAIL S/C	50	79-12-0050-01	HANDLE S/C CAP
20	79-07-0074-01	ARM LEVER			
21	79-58-0564-01	ARM LEVER PIN			
22	79-15-0050-01	E-CLIP			
23	79-03-0103-01	BAIL ASS'Y			
24	79-57-0038-01	LINE ROLLER			
25	79-45-0034-01	BAIL HOLDER PIN			
26	79-37-0161-01	KICK LEVER			
27	79-67-0603-01	KICK LEVER S/P			
28	79-19-0081-01	KICK LEVER COVER			
29	79-58-0577-01	KICK LEVER C/V S/C			
30	79-67-0609-01	SLIDING S/P-"A"			
31	79-28-0158-01	RATCHET GEAR			