

EXPLODED PARTS VIEW

GRAPHITE CONSTRUCTION
BAITRUNNER

250

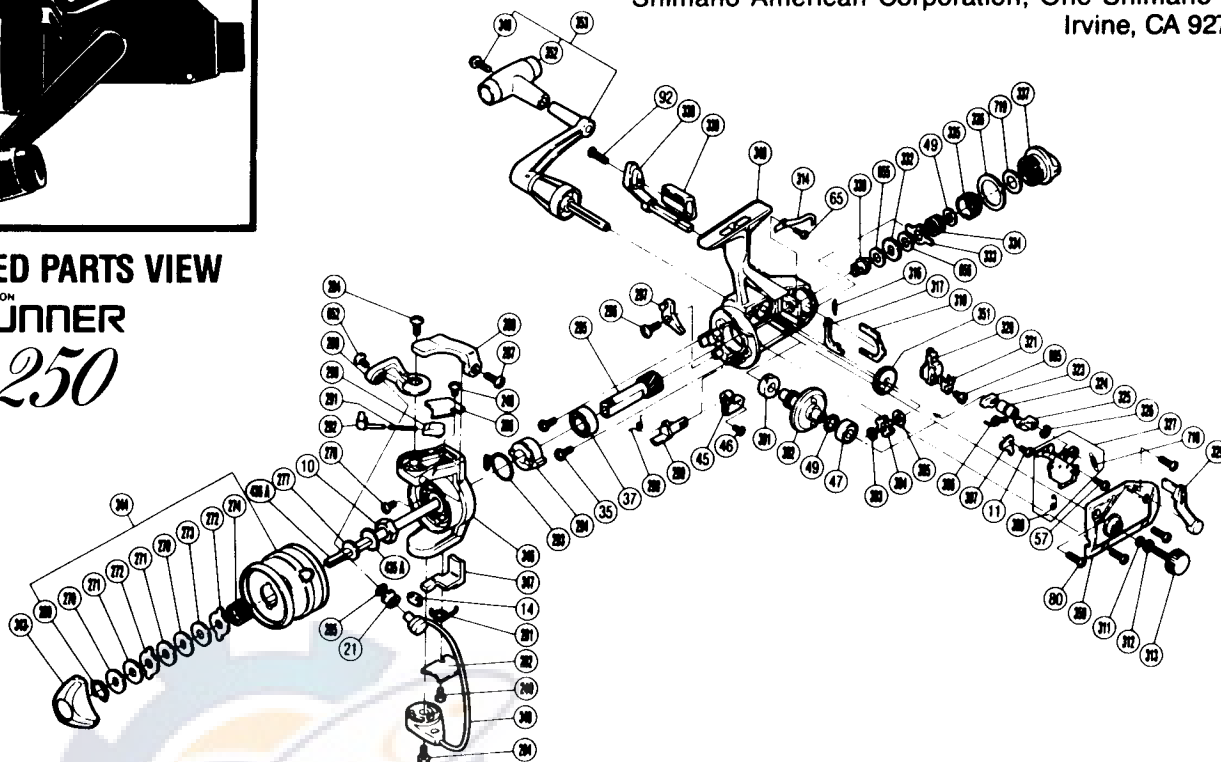

SHIMANO[®]

1989 REPAIR MANUAL

Shimano American Corporation, One Shimano Dr.
Irvine, CA 92718

PARTS LIST

PART # DESCRIPTION

BR 0010	Rotor Nut
BR 0011	Nut Lock Screw
BR 0014	Bail Trip Slide Cam
BR 0021	Line Roller
BR 0035	Bearing Retainer Screw
BR 0037	Ball Bearing
BR 0045	Anti-Reverse Lever
BR 0046	Anti-Reverse Lever Screw
BR 0047	Ball Bearing
BR 0049	Drive Gear Washer
BR 0057	Clutch Plate Screw
BR 0065	Dial Click Screw
BR 0080	Side Cover Screw B
BR 0092	Baitrunner Lever Screw
BR 0240	Bail Trip Cover Screw
BR 0269	Drag Washers Retainer
BR 0270	Key Washer
BR 0271	Drag Washer 1
BR 0272	Eared Washer
BR 0273	Drag Washer 2
BR 0274	Drag Spring
BR 0277	Spool Washer
BR 0278	Nut Lock Screw
BR 0281	Lever Spring
BR 0282	Bail Trip Cover
BR 0284	Bail Trip Cam Screw
BR 0285	Line Roller Washer
BR 0286	Bail Spring Cover
BR 0287	Trigger Screw
BR 0288	Quick-Fire II Trigger
BR 0289	Bail Arm

PART # DESCRIPTION

BR 0290	Bail Spring Guide B
BR 0291	Bail Spring
BR 0292	Bail Spring Guide A
BR 0293	Anti-Reverse Pawl Spring
BR 0294	Anti-Reverse Ratchet
BR 0295	Pinion Gear
BR 0296	Anti-Reverse Pawl Screw
BR 0297	Anti-Reverse Pawl
BR 0298	Anti-Reverse Cam Spring
BR 0299	Anti-Reverse Cam
BR 0301	Bushing
BR 0302	Drive Gear
BR 0303	"C" Lock
BR 0304	Baitrunner Ratchet
BR 0305	Ratchet Spacer
BR 0306	Clutch Spring
BR 0307	Baitrunner Pawl Guide
BR 0309	Clutch Pawl Spring
BR 0311	Lock Washer Retainer
BR 0312	Handle Lock Washer
BR 0313	Handle Screw Cap
BR 0314	Dial Click
BR 0316	Baitrunner Pawl Spring
BR 0317	Baitrunner Pawl
BR 0318	Dial Retainer
BR 0320	Oscillating Slider
BR 0321	Oscillating Slider Retainer
BR 0323	Clutch Cam
BR 0324	Clutch Cam Spacer
BR 0325	Clutch Arm
BR 0326	Lever Shaft Retainer

PART # DESCRIPTION

BR 0327	Clutch Plate Assembly
BR 0329	Baitrunner Lever Arm (L)
BR 0330	Free Spool Tension Shaft
BR 0332	Click Gear
BR 0333	Eared Washer "BFS"
BR 0334	Free Spool Tension Spring
BR 0335	Free Spool Tension Screw
BR 0336	Dial Spacer
BR 0337	Baitrunner Tension Dial
BR 0338	Baitrunner Lever Arm (R)
BR 0339	Baitrunner Lever Bridge
BR 0340	Handle Knob Screw
BR 0343	Drag Knob
BR 0344	Spool Assembly
BR 0346	Rotor
BR 0347	Bail Trip Lever
BR 0348	Bail Assembly
BR 0349	Body
BR 0350	Side Cover
BR 0351	Oscillating Gear
BR 0352	Handle Knob
BR 0353	Handle Assembly
BR 0435A	Spool Support
BR 0436A	Main Shaft
BR 0652	Line Roller Screw
BR 0655	Free Spool Tension Washer (A)
BR 0656	Free Spool Tension Washer (B)
BR 0685	Slider Retainer Screw
BR 0718	Baitrunner Click Spring
BR 0719	Adjusting Spacer