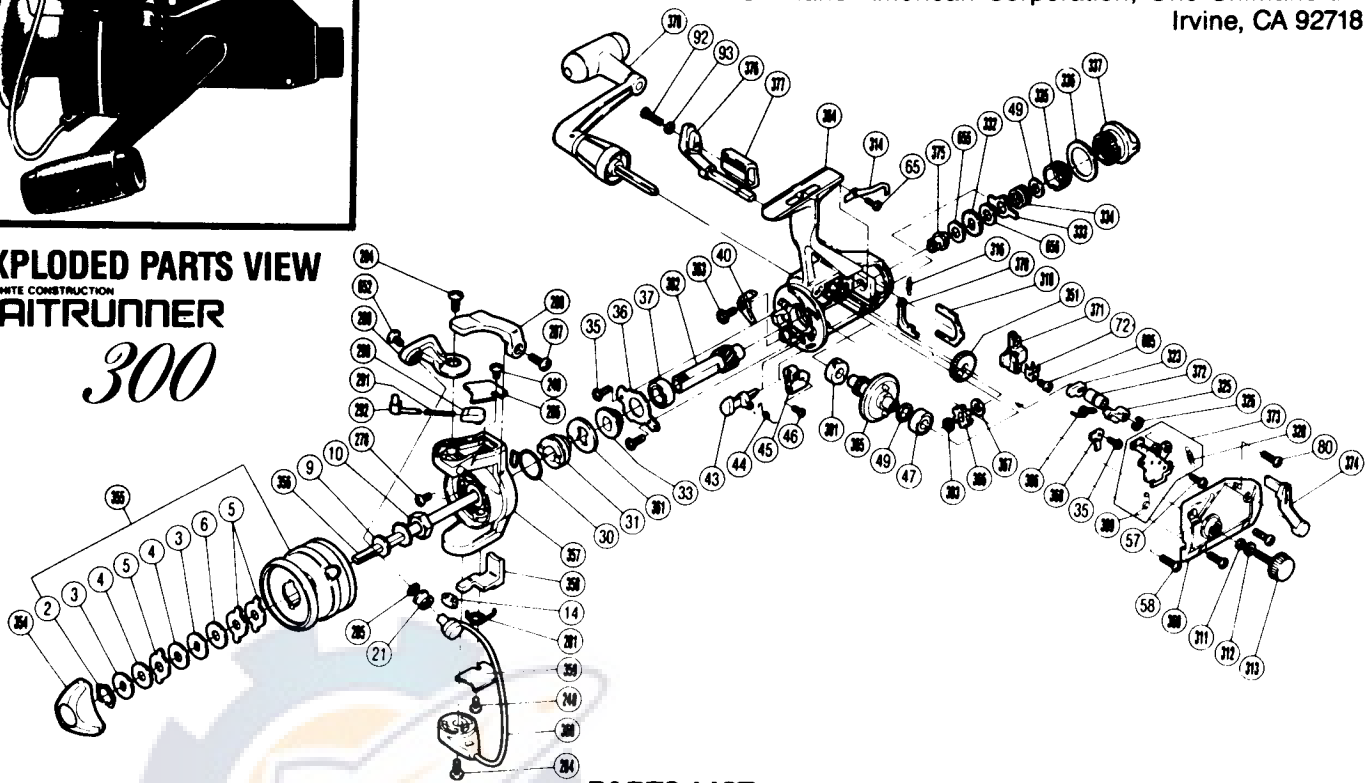

EXPLODED PARTS VIEW
GRAPHITE CONSTRUCTION
BAITRUNNER
300

PARTS LIST

| PART # | DESCRIPTION | PART # | DESCRIPTION | PART # | DESCRIPTION |
|---------|-----------------------------|---------|---------------------------|---------|-------------------------------|
| BR 0002 | Drag Washers Retainer | BR 0281 | Lever Spring | BR 0351 | Oscillating Gear |
| BR 0003 | Key Washer | BR 0284 | Bail Trip Cam Screw | BR 0354 | Drag Knob |
| BR 0004 | Drag Washer 1 | BR 0285 | Line Roller Washer | BR 0355 | Spool Assembly |
| BR 0005 | Eared Washer | BR 0286 | Bail Spring Cover | BR 0356 | Main Shaft |
| BR 0006 | Drag Washer 2 | BR 0287 | Trigger Screw | BR 0357 | Rotor |
| BR 0009 | Spool Washer | BR 0288 | Quick-Fire II Trigger | BR 0358 | Bail Trip Lever |
| BR 0010 | Rotor Nut | BR 0289 | Bail Arm | BR 0359 | Bail Trip Cover |
| BR 0014 | Bail Trip Slide Cam | BR 0290 | Bail Spring Guide B | BR 0360 | Bail Assembly |
| BR 0021 | Line Roller | BR 0291 | Bail Spring | BR 0361 | Anti-Reverse Ratchet |
| BR 0030 | Anti-Reverse Pawl Spring | BR 0292 | Bail Spring Guide A | BR 0362 | Pinion Gear |
| BR 0031 | Anti-Reverse Spring Holder | BR 0301 | Bushing | BR 0363 | Anti-Reverse Pawl Screw |
| BR 0033 | Pinion Spacer | BR 0303 | "C" Lock | BR 0364 | Body |
| BR 0035 | Bearing Retainer Screw | BR 0306 | Clutch Spring | BR 0365 | Drive Gear |
| BR 0036 | Bearing Retainer | BR 0309 | Clutch Pawl Spring | BR 0366 | Baitrunner Ratchet |
| BR 0037 | Ball Bearing | BR 0311 | Lock Washer Retainer | BR 0367 | Ratchet Spacer |
| BR 0040 | Anti-Reverse Pawl | BR 0312 | Handle Lock Washer | BR 0368 | Baitrunner Pawl Guide |
| BR 0043 | Anti-Reverse Cam | BR 0313 | Handle Screw Cap | BR 0369 | Side Cover |
| BR 0044 | Anti-Reverse Cam Spring | BR 0314 | Dial Click | BR 0370 | Baitrunner Pawl |
| BR 0045 | Anti-Reverse Lever | BR 0316 | Baitrunner Pawl Spring | BR 0371 | Oscillating Slider |
| BR 0046 | Anti-Reverse Lever Screw | BR 0318 | Dial Retainer | BR 0372 | Clutch Cam Spacer |
| BR 0047 | Ball Bearing | BR 0323 | Clutch Cam | BR 0373 | Clutch Plate Assembly |
| BR 0049 | Drive Gear Washer | BR 0325 | Clutch Arm | BR 0374 | Baitrunner Lever Arm (L) |
| BR 0057 | Clutch Plate Screw | BR 0326 | Lever Shaft Retainer | BR 0375 | Free Spool Tension Shaft |
| BR 0058 | Side Cover Screw A | BR 0328 | Baitrunner Click Spring | BR 0376 | Baitrunner Lever Arm (R) |
| BR 0065 | Dial Click Screw | BR 0332 | Click Gear | BR 0377 | Baitrunner Lever Bridge |
| BR 0072 | Oscillating Slider Retainer | BR 0333 | Eared Washer "BFS" | BR 0378 | Handle Assembly |
| BR 0080 | Side Cover Screw B | BR 0334 | Free Spool Tension Spring | BR 0652 | Line Roller Screw |
| BR 0092 | Baitrunner Lever Screw | BR 0335 | Free Spool Tension Screw | BR 0655 | Free Spool Tension Washer (A) |
| BR 0093 | Lock Washer | BR 0336 | Dial Spacer | BR 0656 | Free Spool Tension Washer (B) |
| BR 0240 | Bail Trip Cover Screw | BR 0337 | Baitrunner Tension Dial | BR 0685 | Slider Retainer Screw |
| BR 0278 | Nut Lock Screw | | | | |