

SHIMANO®

1987 REPAIR MANUAL

Shimano American Corporation, One Shimano Dr.
Irvine, CA 92718

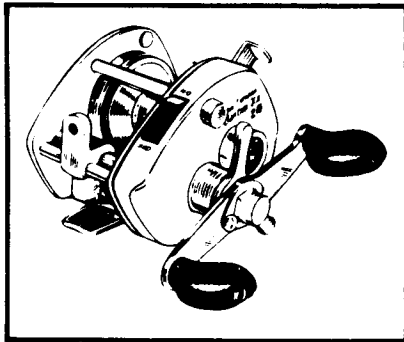

TO ORDER:

This reel belongs to the "Bantam" series.
Please order parts using the abbreviation
"BNT" and the part number.

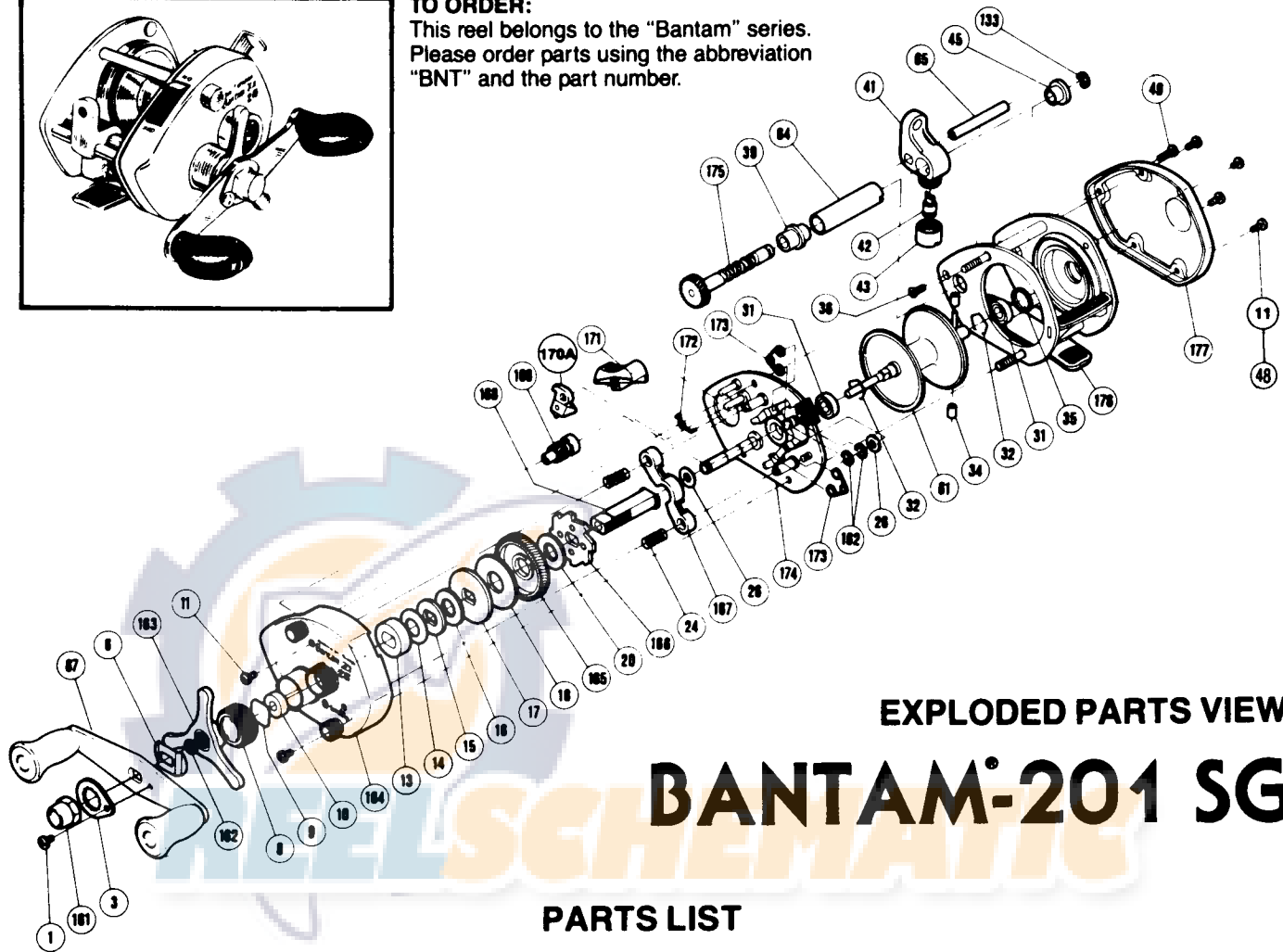

EXPLODED PARTS VIEW

BANTAM-201 SG

PARTS LIST

PART #	DESCRIPTION	PART #	DESCRIPTION	PART #	DESCRIPTION
1.	Handle Nut Lock Screw	34S.	Centrifugal Brake Weights (Small)	67.	Handle
3.	Handle Nut Lock Plate	34L.	Centrifugal Brake Weights (Large)	133.	Level Wind Gear Lock
6.	Friction Washer	35.	Bearing Spacer	161.	Handle Nut
8.	Cast Control Cap	36.	Stabilizer Bar Screw	162.	"C" Lock
9.	Cast Control Spacer	39.	Level Wind Bearing	163.	Drag Tri-Star
10.	Cast Control Bushing	41.	Line Guide	164.	Left Side Plate
11.	Side Plate Screw	42.	Level Wind Pawl	165.	Drive Gear
13.	Drive Shaft Bearing	43.	Pawl Cap	166.	Anti-Reverse Ratchet
14.	Drag Spring Washer	45.	Level Wind Bearing	167.	Pinion Yoke
15.	"D" Washer	48.	Side Plate Screw	168.	Drive Shaft
16.	Drag Spacer	49.	Stabilizer Bar Screw	169.	Pinion Gear
17.	Pressure Plate	60.	Line Guide Pawl Shim (optional) *	170A.	Anti-Reverse Dog
18.	Drag Washer	61.	Spool	171.	Anti-Reverse Switch
20.	Base Drag Washer	64.	Level Wind Guard	172.	Switch Spring
24.	Pinion Yoke Spring	65.	Stabilizer Bar	173.	Retractor Spring
26.	Drive Shaft Shim			174.	Set Plate
31.	Spool Shaft Bearing			175.	Level Wind Gear
32.	Bearing Lock			176.	Frame
				177.	Right Side Plate

*Optional—not shown in exploded view.

Prices and specifications subject to change without notice.