

## REPAIR MANUAL

Shimano American Corporation, 205 Jefferson Road  
Parisippany, N.J. 07054

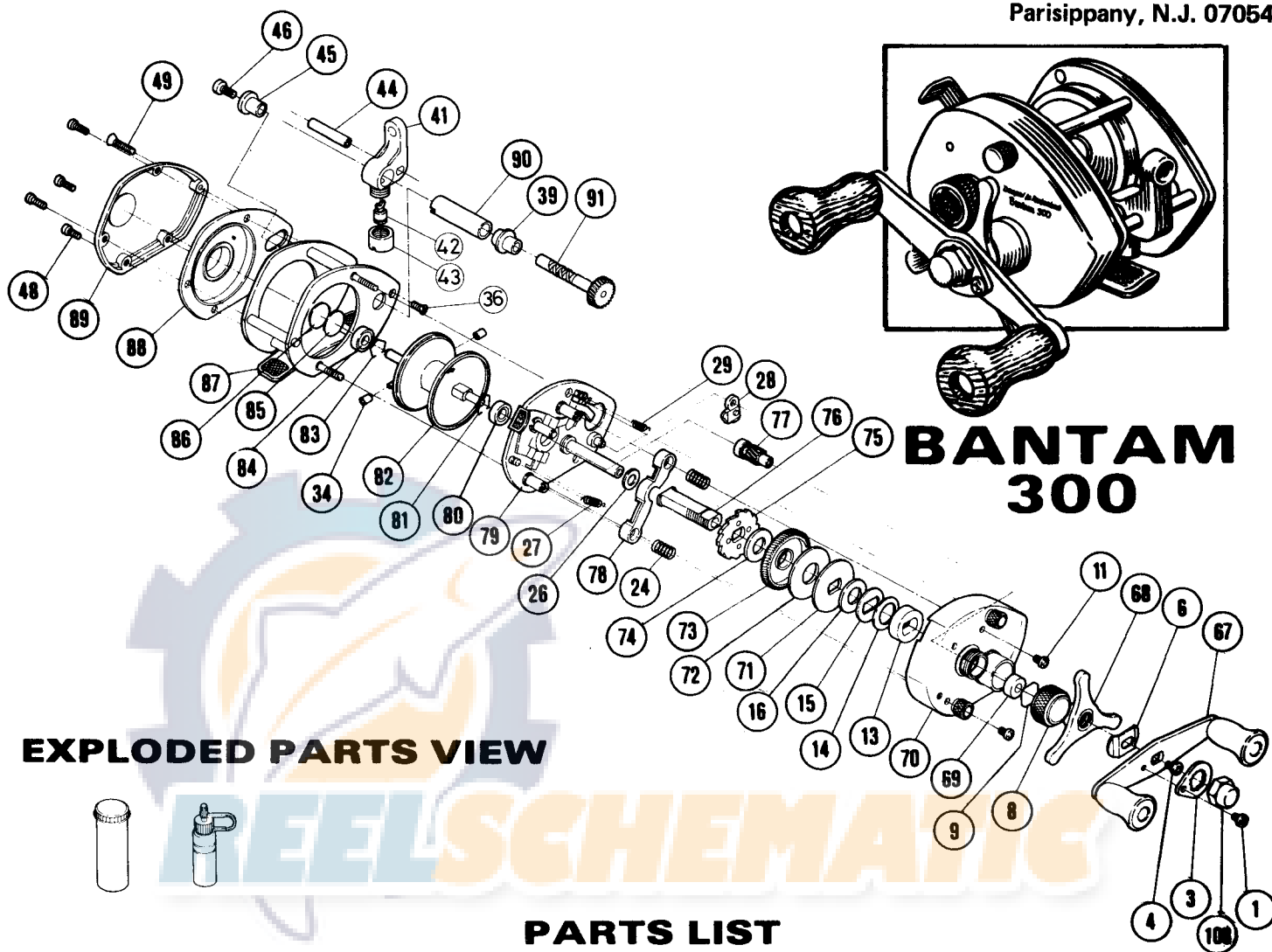

### PARTS LIST

PART #	DESCRIPTION	PRICE	PART #	DESCRIPTION	PRICE	PART #	DESCRIPTION	PRICE
1	Handle Nut Lock Screw	.15	41	Line Guide	2.50	74	Base Drag Washer	.25
3	Handle Nut Lock Plate	.30	42	Level Wind Pawl	1.00	75	Anti Reverse Ratchet	1.90
4	Drive Shaft Retainer Screw	.15	43	Pawl Cap	.50	76	Drive Shaft	5.65
6	Friction Washer	.20	44	Line Guide Stabilizer Bar	1.20	77	Pinion Gear	6.85
8	Cast Control Cap	.95	45	Level Wind Bearing (Left)	.20	78	Pinion Yoke	.25
9	Cast Control Spacer	.15	46	Level Wind Retainer Screw	.15	79	Set Plate	14.75
11	Right Sideplate Screw	.15	48	Left Side Plate Screw	.20	80	Right Spool Bearing	6.50
13	Drive Shaft Bearing	.15	49	Left Stabilizer Bar Screw	.15	81	Right Bearing Lock	.15
14	Drag Spring Washer	.15	60	Line Guide Pawl Spacer*	.15	82	Spool	18.00
15	"D" Washer	.20	67	Handle	6.00	83	Left Bearing Lock	.15
16	Drag Spacer	.40	68	Drag Tri-Star	2.35	84	Left Spool Bearing	6.50
24	Pinion Yoke Spring	.15	69	Spool Shaft Bushing	.25	85	Left Bearing Spacer	.15
26	Drive Shaft Shim	.15	70	Right Side Plate	13.00	86	Left Bearing Shim	.15
27	Retractor Spring #1	.60	71	Pressure Plate	.35	87	Frame	17.90
28	Anti Reverse Dog	1.00	72	Drag Washer	.15	88	Left Bearing Plate	6.40
29	Retractor Spring #2	.35	73	Drive Gear	3.50	89	Left Side Plate	2.00
34	Centrifugal Brake Weights	.15				90	Level Wind Guard	2.15
36	Right Stabilizer Bar Screw	.15				91	Level Wind Gear	3.50
39	Level Wind Bearing (Right)	.20				108	Handle Nut	.75

Prices and specifications subject to change without notice.

\*Optional - not shown in exploded view.