

EXPLODED PARTS VIEW

Beast Master[®] GT-X
AERO
ULS-A

SHIMANO[®]

1990 REPAIR MANUAL

Shimano American Corporation, One Shimano Dr.
Irvine, CA 92718

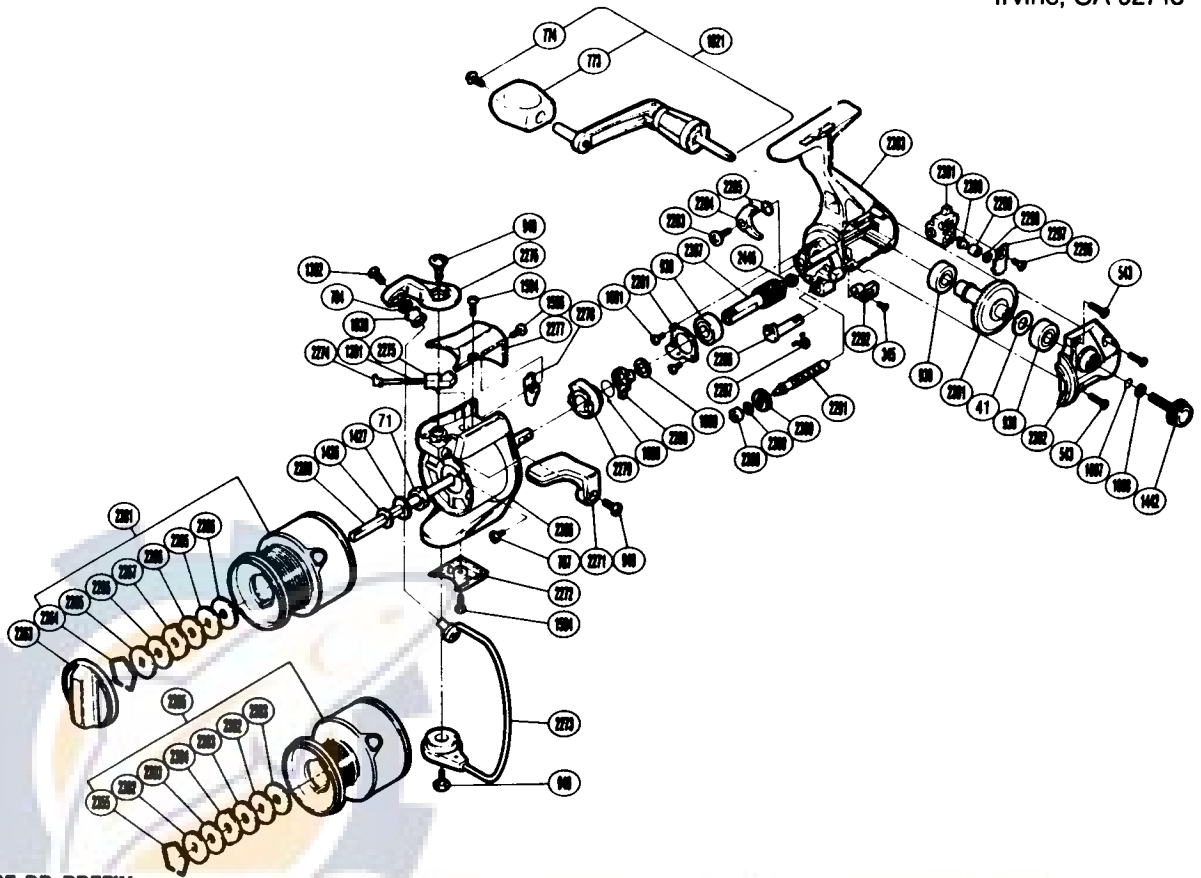

TO ORDER: USE RD PREFIX
WITH PART NUMBER

PARTS LIST

RD #	DESCRIPTION	RD #	DESCRIPTION	RD #	DESCRIPTION
0041	Drive Gear Washer	1891	Multi Purpose Screw	2291	Worm Shaft
0071	Rotor Nut	2263	Drag Knob	2292	Anti-Reverse Lever
0345	Anti-Reverse Lever Screw	2264	Drag Washers Retainer	2296	Slider Retainer Screw
0543	Side Cover Screw (B)	2265	Key Washer	2297	Oscillating Pawl Cover
0773	Handle Knob	2266	Drag Washer	2298	Spacer
0774	Handle Knob Screw	2267	Eared Washer	2299	Oscillating Slider Bushing
0784	Line Roller Washer	2269	Main Shaft	2300	Oscillating Pawl
0787	Nut Lock Screw	2271	Quick-Fire II Trigger	2301	Oscillating Slider
0930	Ball Bearing	2272	Rotor Side Cover	2355	Drag Washers Retainer
0940	Bail Trip Cam Screw	2273	Bail Assembly	2381	Spool Assembly (Shallow)
0949	Trigger Screw	2274	Bail Spring Guide (A)	2382	Key Washer
1007	Lock Washer Retainer	2275	Bail Spring Guide (B)	2383	Drag Washer
1008	Handle Lock Washer	2276	Bail Arm	2384	Eared Washer
1021	Handle Assembly	2277	Bail Spring Cover	2385	Spool Assembly (Deep)
1038	Sic Ceramic Roller	2278	Bail Trip Lever	2386	Rotor
1201	Bail Spring	2279	Anti-Reverse Ratchet	2387	Pinion Gear
1302	Line Roller Screw	2280	Anti-Reverse Lock Out	2388	Ball Bearing
1426	Spool Washer	2281	Bearing Retainer	2389	Worm Shaft Spacer
1427	Spool Support	2283	Anti-Reverse Pawl Screw	2390	Idle Gear
1442	Handle Screw Cap	2284	Anti-Reverse Pawl	2391	Drive Gear
1504	Bail Hold Cover Screw	2285	Anti-Reverse Pawl Spring	2392	Side Cover
1506	Bail Spring Cover Screw	2286	Anti-Reverse Cam	2393	Body
1888	Anti-Reverse Lock Out Spring	2287	Anti-Reverse Cam Spring	2446	Bushing
1890	Bushing Washer				

Prices and specifications subject to change without notice.