

EXPLODED PARTS VIEW

Bantam *Black Magnum 2000 II*

SHIMANO®

1990 REPAIR MANUAL

Shimano American Corporation, One Shimano Dr.
Irvine, CA 92718

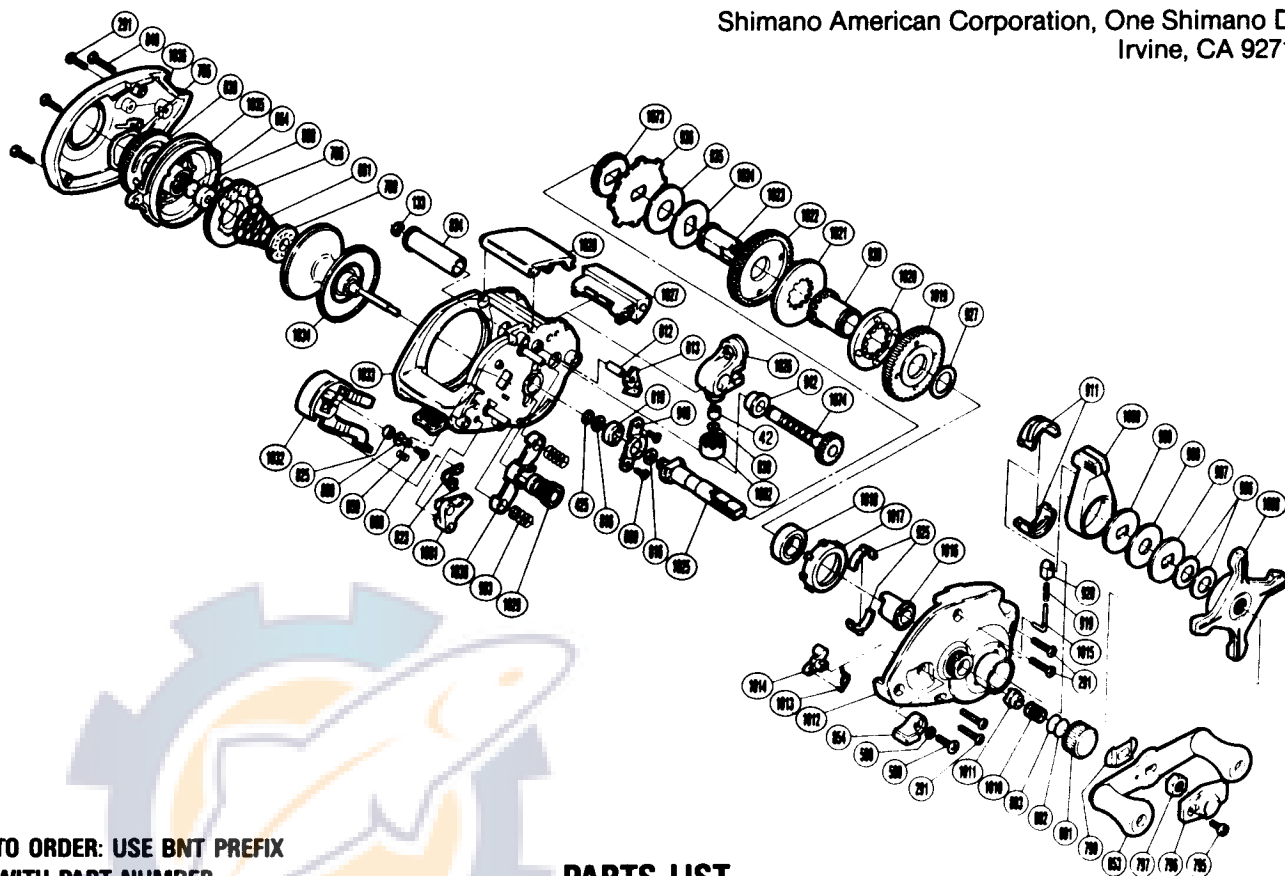

**TO ORDER: USE BNT PREFIX
WITH PART NUMBER**

PARTS LIST

| BNT # | DESCRIPTION | BNT # | DESCRIPTION | BNT # | DESCRIPTION |
|-------|----------------------------|-------|---------------------------|-------|-------------------------|
| 0042 | Line Guide Pawl | 0838 | Magnetic Control Dial | 1013 | Cam Spring |
| 0133 | Worm Shaft Retainer | 0840 | Left Side Plate Screw | 1014 | Flipping Cam |
| 0291 | Side Plate Screw | 0853 | Handle Assembly | 1015 | Shift Spring Guide (A) |
| 0425 | Clutchbutton Lock | 0854 | Flipping Lever | 1016 | Drag Shaft (B) |
| 0589 | Flipping Lever Screw | 0859 | Flipping Retractor Spring | 1017 | Bearing Holder |
| 0590 | Lock Washer | 0860 | Yoke Plate Washer (B) | 1018 | Drive Shaft Bearing (B) |
| 0609 | Drive Shaft Retainer Screw | 0880 | Spool Shaft Bushing (C) | 1019 | Drive Gear (L) |
| 0612 | Anti-Reverse Pawl Pin | 0906 | Coned Disc Spring | 1020 | Shift Clutch (L) |
| 0613 | Anti-Reverse Pawl | 0907 | Key Washer (A) | 1021 | Shift Clutch (H) |
| 0661 | Magnet Retainer Spring | 0908 | Drag Washer (D) | 1022 | Drive Gear (H) |
| 0664 | Spacer (B) | 0909 | Key Washer (C) | 1023 | Drag Shaft (A) |
| 0706 | Magnet Retainer | 0911 | Shift Cam | 1024 | Drive Shaft Washer |
| 0766 | Dial Friction Washer | 0919 | Shift Spring | 1025 | Drive Shaft |
| 0780 | Magnet Retainer Lock | 0920 | Shift Spring Guide (B) | 1026 | Line Guide |
| 0795 | Handle Nut Plate Screw | 0925 | Shift Arm | 1027 | Level Wind Protector |
| 0796 | Handle Nut Plate | 0927 | Drive Gear Washer | 1028 | Thumb Rest |
| 0797 | Handle Nut | 0930 | Shift Sleeve | 1029 | Pinion Gear |
| 0799 | Friction Washer | 0935 | Drag Washer (A) | 1030 | Yoke |
| 0801 | Cast Control Cap | 0936 | Anti-Reverse Ratchet | 1031 | Joint Plate |
| 0802 | Spool Tension Spacer (B) | 0940 | Drive Shaft Retainer | 1032 | Clutch Button |
| 0803 | Spool Tension Spacer (A) | 0942 | Worm Bearing | 1033 | One-Piece Frame |
| 0816 | Drive Shaft Washer | 0993 | Yoke Spring | 1034 | Spool Assembly |
| 0819 | Drive Shaft Bushing | 1008 | Star Drag | 1035 | Dial Case |
| 0823 | Retractor Spring | 1009 | Shift Lever | 1036 | Left Side Plate |
| 0825 | Yoke Plate Washer (A) | 1010 | Spool Tension Spring | 1073 | Idle Gear |
| 0830 | Spacer (Optional) | 1011 | Spool Shaft Bushing (A) | 1074 | Worm Shaft |
| 0834 | Level Wind Guard | 1012 | Right Side Plate | | |

Prices and specifications subject to change without notice.