

CURADO

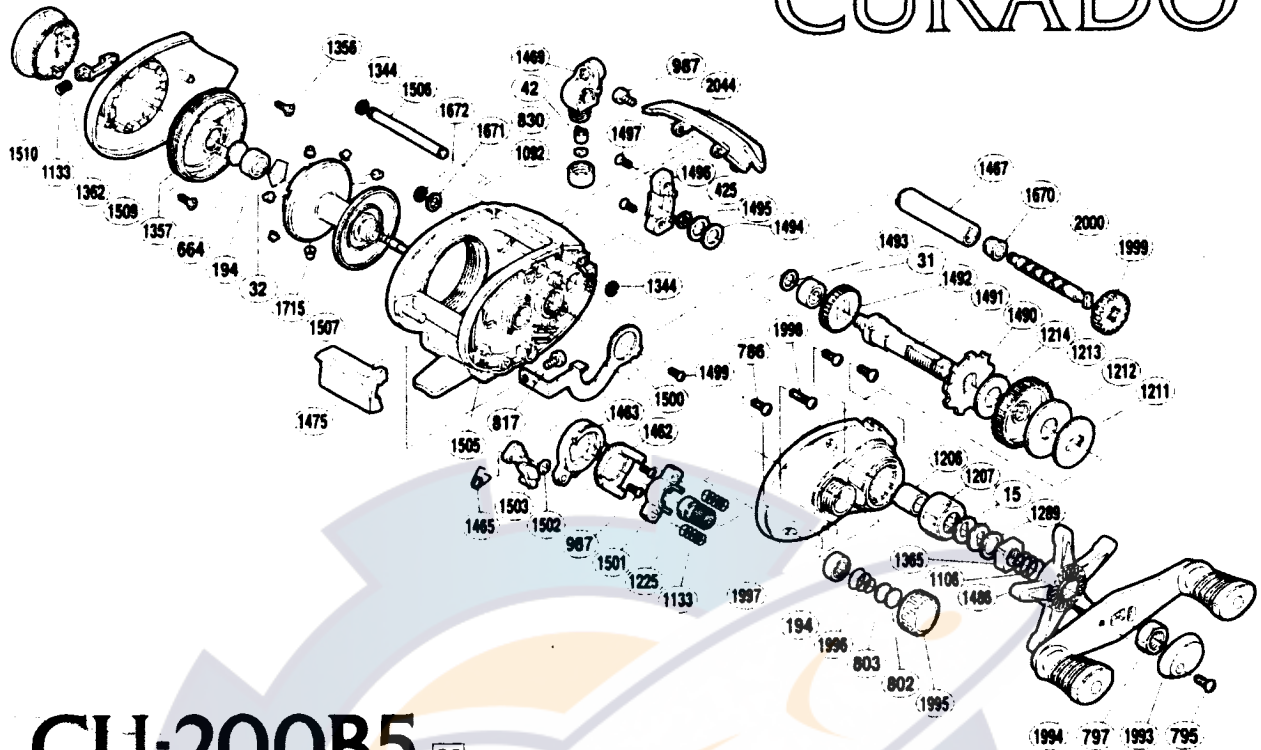

CU-200B5 98

| BNT No. | PARTS NAMES | BNT No. | PARTS NAMES | BNT No. | PARTS NAMES |
|---------|----------------------------|---------|---------------------------|---------|---------------------------|
| 0015 | Drag Spring Washer | 1214 | Drag Washer (A) | 1499 | Clutch Plate Screw |
| 0031 | Ball Bearing | 1225 | Pinion Gear | 1500 | Clutch Plate |
| 0032 | Bearing Retainer | 1289 | Star Drag Spacer | 1501 | Yoke |
| 0042 | Line Guide Pawl | 1344 | "C" Lock | 1502 | Spacer (optional) |
| 0194 | Ball Bearing | 1356 | Brake Case Retainer Screw | 1503 | Clutch Pawl |
| 0425 | "E" Lock | 1357 | Brake Case | 1505 | One-Piece Frame |
| 0664 | Spacer (B) | 1362 | Turnkey Pawl | 1506 | Line Guard |
| 0786 | Side Plate Screw (short) | 1365 | Star Drag Nut | 1507 | Spool Assembly |
| 0795 | Handle Nut Plate Screw | 1462 | Clutch Cam Retainer | 1509 | Left Side Plate |
| 0797 | Handle Nut | 1463 | Clutch Cam | 1510 | Turnkey Dial |
| 0802 | Spool Tension Spacer (B) | 1465 | Clutch Pawl Spring | 1670 | Worm Bushing |
| 0803 | Spool Tension Spacer (A) | 1467 | Level Wind Guard | 1671 | Worm Shaft Washer (B) |
| 0817 | Clutch Bar Screw | 1469 | Line Guide | 1672 | "E" Lock |
| 0830 | Spacer (optional) | 1475 | Quick-Fire II Clutch Bar | 1715 | Brake Collar (red) |
| 0987 | Multi Purpose Screw | 1486 | Star Drag | 1993 | Handle Nut Plate Assembly |
| 1092 | Pawl Cap | 1490 | Anti-Reverse Ratchet | 1994 | Handle Assembly |
| 1106 | Star Drag Spring | 1491 | Drive Shaft | 1995 | Cast Control Cap |
| 1133 | Yoke / Turnkey Pawl Spring | 1492 | Idle Gear (A) | 1996 | Spool Tension Spring |
| 1206 | Roller Clutch Inner Tube | 1493 | Drive Gear Washer | 1997 | Right Side Plate |
| 1207 | Roller Clutch Bearing | 1494 | Drive Shaft Washer (B) | 1998 | Side Plate Screw (long) |
| 1211 | Key Washer | 1495 | Drive Shaft Washer (A) | 1999 | Idle Gear (C) |
| 1212 | Drag Washer (C) | 1496 | Drive Shaft Cover | 2000 | Worm Shaft |
| 1213 | Drive Gear | 1497 | Drive Shaft Cover Screw | 2044 | Thumb Rest |