

SHIMANO®

1987 REPAIR MANUAL

Shimano American Corporation, One Shimano Dr.
Irvine, CA 92718

EXPLODED PARTS VIEW

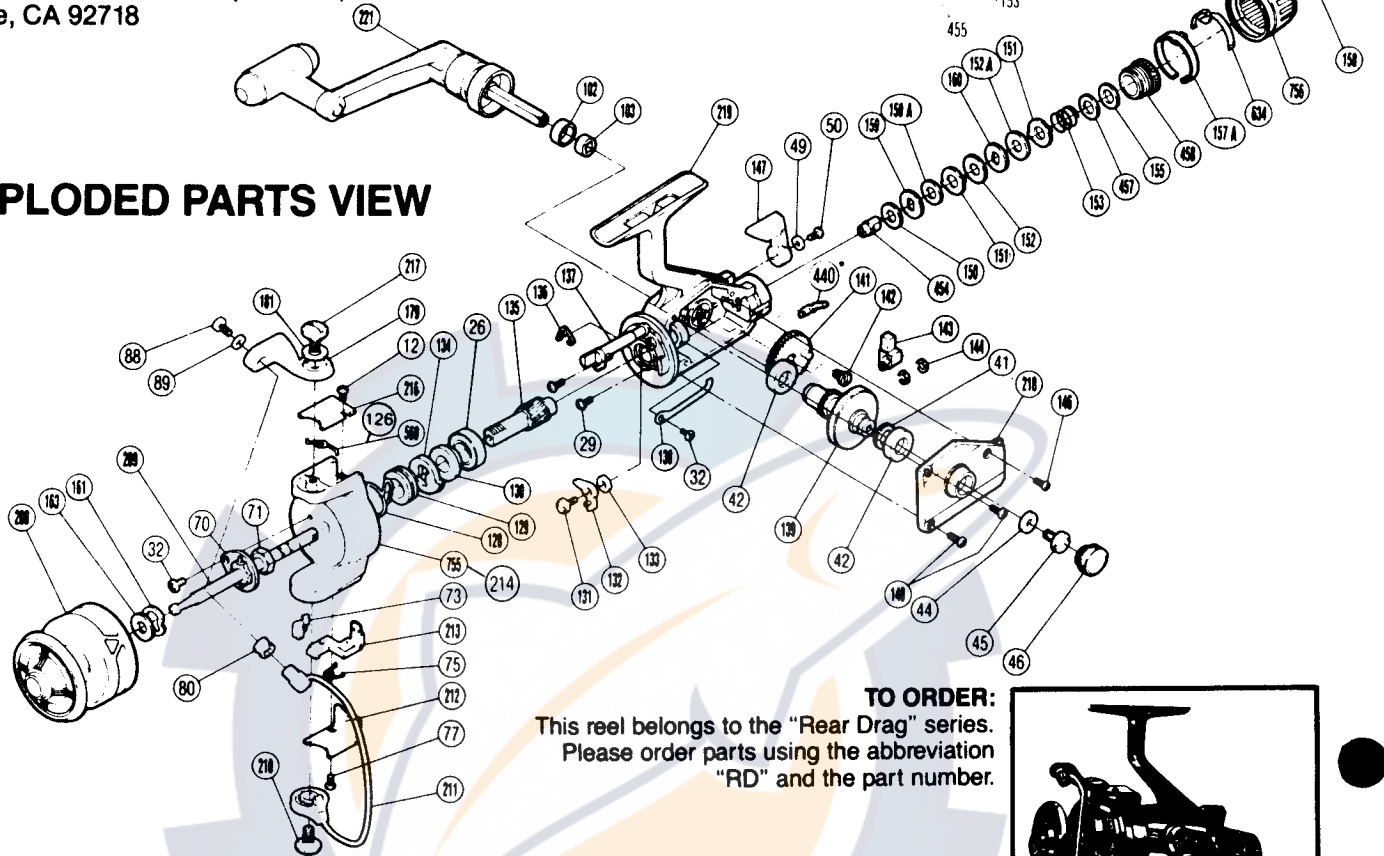

TO ORDER:

This reel belongs to the "Rear Drag" series.
Please order parts using the abbreviation
"RD" and the part number.

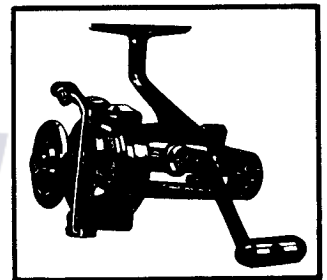

CUSTOM 3000

PARTS LIST

PART# DESCRIPTION

- 12. Cover Screw
- 26. Ball Bearing
- 29. Bearing Retainer Screw
- 32. Multi Purpose Screw
- 41. Thrust Washer
- 42. Drive Gear Bushing
- 44. Handle Screw Lock Washer
- 45. Handle Screw
- 46. Dust Cap
- 49. Lock Washer
- 50. Anti Reverse Lever Screw
- 70. Rotor Nut Lock
- 71. Rotor Nut
- 73. Trip Plate Cam
- 75. Trip Plate Spring
- 77. Cover Screw
- 80. Roller Line Guide
- 88. Bail Wire Screw
- 89. Guide Screw Lock Washer
- 102. Bushing Ring
- 103. Handle Shaft Bushing
- 126. Bail Spring(orig. 2-coil)
- 128. Rotor Stop Spring
- 129. Stop Spring Arbor
- 130. Ratchet Spacer
- 131. Anti Reverse Dog Screw
- 132. Anti Reverse Dog

PART# DESCRIPTION

- 133. Anti Reverse Dog Spacer
- 134. Self Center Ratchet
- 135. Pinion Gear
- 136. Anti Reverse Shaft Spring
- 137. Anti Reverse Shaft
- 138. Drag Click Spring
- 139. Drive Gear
- 140. Side Plate Screw #1
- 141. Oscillation Gear
- 142. Oscillation Gear Screw
- 143. Oscillation Block
- 144. "C" Lock
- 146. Side Plate Screw #2
- 147. Anti Reverse Lever
- 150. Drag Washer (Black)
- 150A. Drag Washer (White)
- 151. Keyed Washer #1
- 152. Drag Washer (Black)
- 152A. Drag Washer (White)
- 153. Drag Spring
- 155. Friction Washer
- 157A. Stop Ring
- 158. Drag Screw
- 159. Ratchet Washer
- 160. D Washer
- 161. Tension Spring

PART# DESCRIPTION

- 163. Spool Spacer
- 179. Bail Mount
- 181. Bail Mount Washer
- 208. Spool
- 209. Spindle
- 210. Bail Screw
- 211. Bail Wire
- 212. Trip Plate Cover
- 213. Trip Plate
- 214. Rotor(orig. 2-coil spring)
- 216. Bail Spring Cover
- 217. Bail Mount Screw
- 218. Side Plate
- 219. Housing
- 220. Drag Adjusting Knob
- 221. Handle (orig. 162)
- 440. Drag Knob Click Spring *
- 454. Drag Shaft
- 455. Lock Washer
- 456. Lock Spring
- 457. Base Spring Washer
- 458. Spring Housing
- 568. Bail Spring('85)4-Coil
- 634. Drag Knob Click Spring ('85)
- 755. Rotor('85)(4-Coil Spring)
- 756. Drag Knob ('85)

* not on reels using 634

Prices and specifications subject to change without notice