

**1987 REPAIR MANUAL**

Shimano American Corporation, One Shimano Dr.  
 Irvine, CA 92718

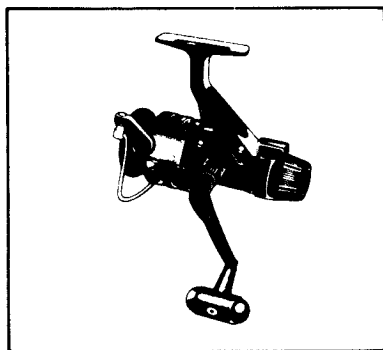

**TO ORDER:**  
 This reel belongs to the "Rear Drag" series.  
 Please order parts using the abbreviation  
 "RD" and the part number.

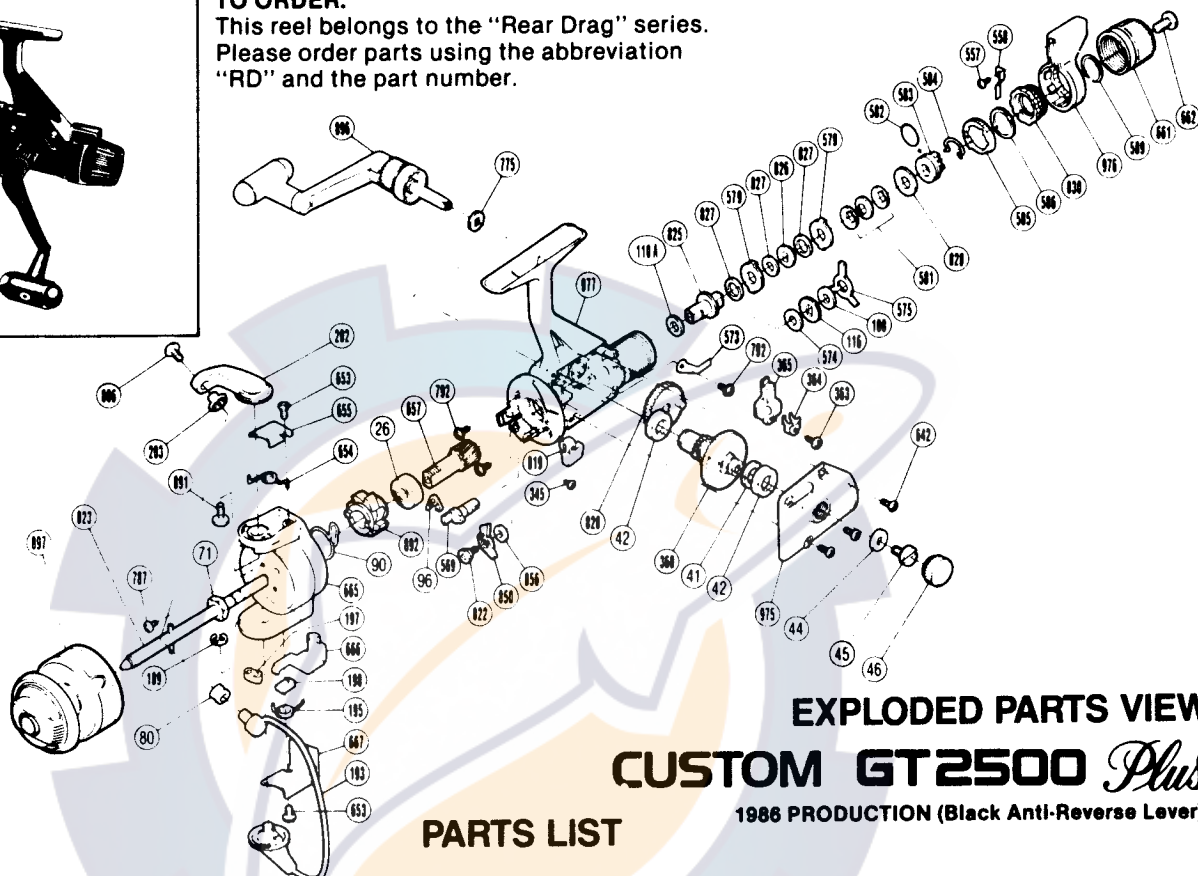

**EXPLODED PARTS VIEW**  
**CUSTOM GT2500 Plus**  
 1986 PRODUCTION (Black Anti-Reverse Lever)

**PARTS LIST**

**PART # DESCRIPTION**

- 26. Ball Bearing
- 41. Drive Gear Washer
- 42. Bushing
- 44. Handle Lock Washer
- 45. Handle Lock Screw
- 46. Handle Screw Cap
- 71. Rotor Nut
- 80. Line Roller
- 90. Anti-Reverse Pawl Spring
- 96. Anti-Reverse Cam Spring
- 108. Drag Washer "C<sub>1</sub>"
- 110A. Drag Washer "D<sub>2</sub>"
- 116. Click Gear
- 189. "E" Lock
- 193. Bail Assembly
- 195. Lever Spring
- 197. Bail Trip Slide Cam
- 198. Trip Lever Guide
- 202. Bail Arm
- 203. Line Roller Washer
- 345. Anti-Reverse Lever Screw
- 360. Drive Gear
- 363. Slider Retainer Screw
- 364. Oscillating Slider Retainer

**PART # DESCRIPTION**

- 365. Oscillating Slider
- 557. Fightin' Drag Click Screw
- 558. Fightin' Drag Click
- 569. Anti-Reverse Cam
- 573. Drag Click
- 574. Drag Washer "C<sub>2</sub>"
- 575. Eared Washer "B<sub>F</sub>"
- 579. Eared Washer "B"
- 581. Coned Disc Springs
- 582. "O" Ring
- 583. Pressure Screw
- 584. Hold Click Spring
- 585. Lever Click Gear
- 586. Fightin' Pressure Screw Washer
- 589. Lever Hold Spring
- 642. Side Cover Screw
- 653. Cover Screw
- 654. Bail Spring
- 655. Bail Spring Cover
- 657. Pinion Gear
- 661. Drag Programmer
- 662. Drag Programmer Screw
- 665. Rotor

**PART # DESCRIPTION**

- 666. Bail Trip Lever
- 667. Bail Trip Cover
- 775. Handle Lock Screw
- 787. Nut Lock Screw
- 792. Multi Purpose Screw
- 806. Line Roller Screw
- 819. Anti-Reverse Lever
- 820. Oscillating Gear
- 822. Anti-Reverse Pawl Screw
- 823. Main Shaft
- 825. Drag Shaft
- 826. Key Washer "A"
- 827. Drag Washer "H<sub>1</sub>"
- 828. Drag Spring Washer "A"
- 830. Fightin' Pressure Screw
- 850. Anti-Reverse Pawl
- 856. Anti-Reverse Pawl Spacer
- 891. Bail Arm Screw
- 892. Anti-Reverse Ratchet
- 896. Handle Assembly
- 897. Spool Assembly (Universal)
- 975. Side Cover
- 976. Fightin' Drag Lever
- 977. Body