

**CUSTOM  
 GT4000 PLUS**

1985 PRODUCTION (Red Anti-Reverse Lever)

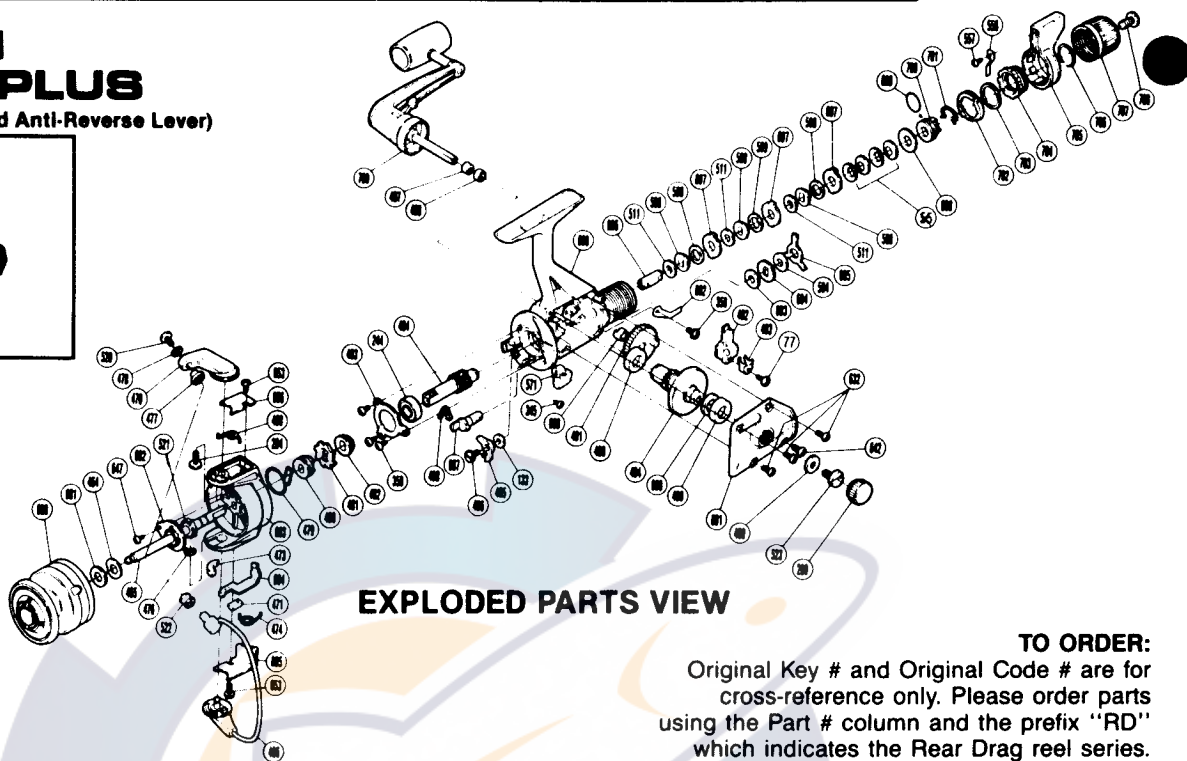
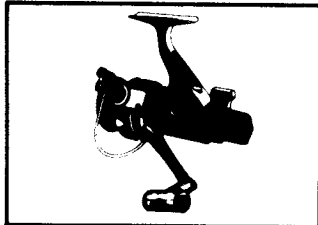

**EXPLODED PARTS VIEW**

**TO ORDER:**  
 Original Key # and Original Code # are for  
 cross-reference only. Please order parts  
 using the Part # column and the prefix "RD"  
 which indicates the Rear Drag reel series.

**PARTS LIST**

ORIGINAL PART #	ORIGINAL KEY #	ORIGINAL CODE #	DESCRIPTION	ORIGINAL PART #	ORIGINAL KEY #	ORIGINAL CODE #	DESCRIPTION
680.	1.	6-0209 31140S	Spool Assembly	491.	42.	6-0449 27430S	Oscillating Gear Assembly
681.	2.	7-0217 29400S	Spool Washer	490.	43.	7-0608 29410S	Drive Gear Bushing
464.	3.	7-0218 29400S	Tension Spring	494.	44.	7-0408 29410S	Drive Gear
647.	4.	7-0014 30220S	Nut Lock Screw	690.	45.		Drive Gear Washer
682.	5.	7-0360 27300S	Rotor Nut Lock Plate	691.	46.	6-0609 33400S	Side Cover
521.	6.	7-0311 14300S	Rotor Nut	499.	47.	7-0725 29400S	Handle Lock Washer
683.	7.	7-0301 29400S	Rotor	523.	48.	7-0710 24500S	Handle Lock Screw
473.	8.	7-0355 29401S	Bail Trip Slide Cam	260.	49.	7-0453 21400S	Handle Screw Cap
684.	9.	7-0336 29400S	Bail Trip Lever	692.	50.	7-0122 33400S	Drag Click
471.	10.	7-0369 29400S	Trip Lever Guide	492.	51.	7-0410 29430S	Oscillating Slider
474.	11.	7-0337 29400S	Lever Spring	493.	52.	7-0538 29400S	Oscillating Slider Retainer
685.	12.	7-0338 33400S	Bail Trip Cover	77.	53.	7-0013 30100S	Slider Retainer Screw
653.	13.	7-0013 40360S	Bail Trip Cover Screw	632.	54.	7-0011 40302S	Side Cover Screw A
466.	14.	6-0309 38420S	Bail	642.	55.	7-0011 30711S	Side Cover Screw B
204.	15.	7-0013 40430S	Bail Arm Screw	693.	56.	7-0139 29410S	Drag Washer "C <sub>2</sub> "
468.	16.	7-0310 28420S	Bail Spring	694.	57.	7-0113 33400S	Click Gear
686.	17.	7-0307 33400S	Bail Spring Cover	504.	58.	7-0139 29400S	Drag Washer "C <sub>1</sub> "
520.	18.	7-0013 40600S	Line Roller Screw	695.	59.	7-0159 33400S	Eared Washer "BF"
478.	19.	7-0316 29400S	Lock Washer	696.	60.	7-0112 33400S	Drag Shaft
470.	20.	7-0303 29430S	Bail Arm	511.	61.	7-0140 29400S	Drag Washer "D"
477.	21.	7-0318 29440S	Line Roller Washer	508.	62.	7-0115 29400S	Key Washer "A"
465.	22.	6-0219 29400S	Main Shaft Assembly	509.	63.	7-0146 29400S	Drag Washer "F"
476.	23.	7-0040 10610S	"E" Lock	697.	64.	7-0116 33400S	Eared Washer "B"
522.	24.	7-0304 01300S	Line Roller	277.	65.	7-0145 25500S	Coned Disc Springs
479.	25.	7-0422 29400S	Anti-Reverse Pawl Spring	698.	66.	7-0135 33400S	Drag Spring Washer "A"
480.	26.	7-0498 29450S	Anti-Reverse Spring Holder	699.	67.	7-0160 33400S	"O" Ring
481.	27.	7-0421 29400S	Anti-Reverse Ratchet	700.	68.	7-0110 33400S	Pressure Screw
482.	28.	7-0428 29430S	Pinion Spacer	701.	69.	7-0149 33400S	Hold Click Spring
358.	29.	7-0011 30470S	Bearing Retainer Screw	702.	70.	7-0155 33600S	Lever Click Gear
483.	30.	7-0403 29400S	Bearing Retainer	703.	71.	7-0157 33400S	Fightin' Pressure Screw Washer
244.	31.	7-0402 01300S	Ball Bearing	704.	72.	7-0156 33400S	Fightin' Pressure Screw
484.	32.	7-0407 29410S	Pinion Gear	557.	73.	7-0010 00110S	Fightin' Drag Click Screw
488.	33.	7-0426 29400S	Anti-Reverse Cam Spring	558.	74.	7-0154 32100S	Fightin' Drag Click
687.	34.	7-0424 33400S	Anti-Reverse Cam	705.	75.	6-0441 33400S	Fightin' Drag Lever
486.	35.	7-0425 29400S	Anti-Reverse Pawl Screw	706.	76.	7-0158 33400S	Lever Hold Spring
485.	36.	6-0419 29400S	Anti-Reverse Pawl Assembly	707.	77.	6-0439 30400S	Drag Programmer
133.	37.	7-0457 05800S	Anti-Reverse Pawl Spacer	708.	78.	7-0013 60400S	Drag Programmer Screw
688.	38.	6-0409 33400S	Body	709.	79.	6-0709 31140S	Handle Assembly
571.	39.	7-0404 32200S	Anti-Reverse Lever	497.	80.	7-0743 29400S	Handle Lock Spacer
345.	40.	7-0013 00110S	Anti-Reverse Lever Screw	498.	81.	7-0731 29400S	Handle Lock Ring
689.	41.	7-0537 29400S	Oscillating Gear Bushing				