

# CUSTOM X-2000 GT

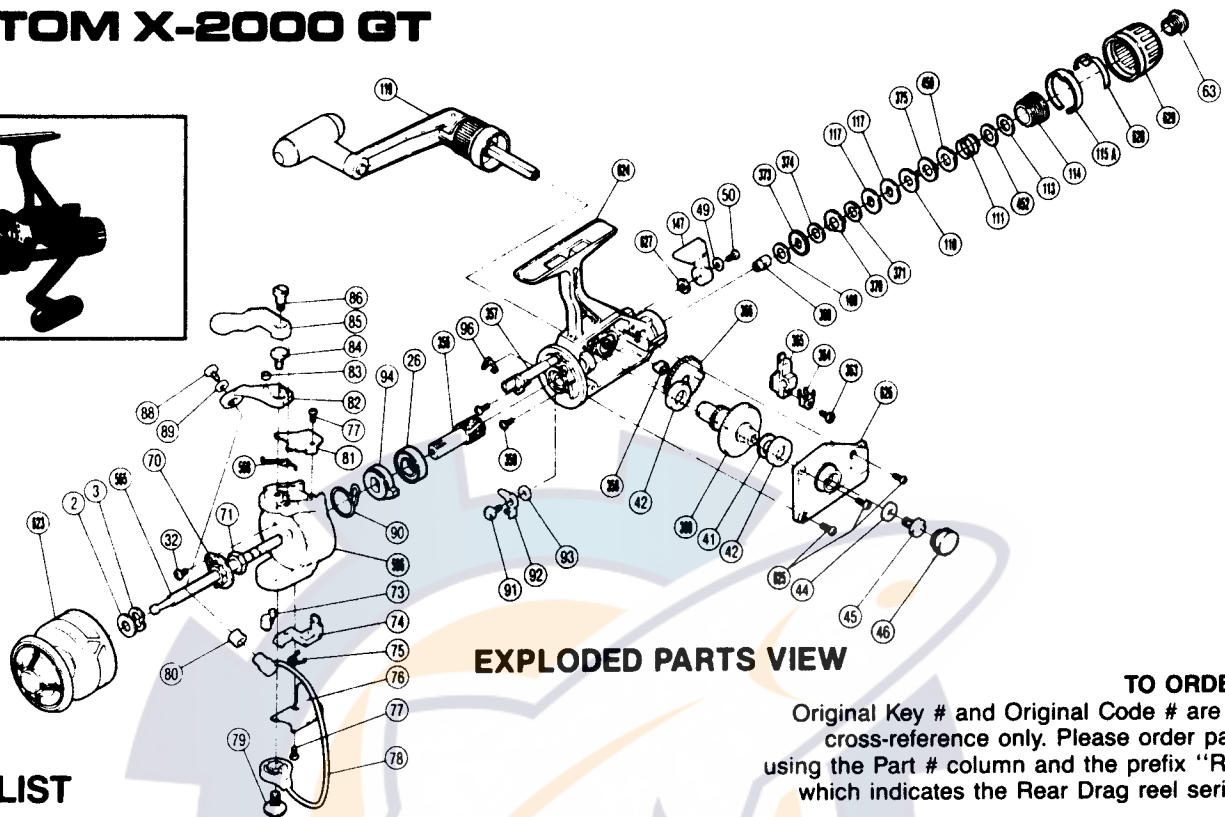
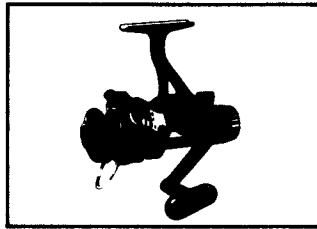

**EXPLODED PARTS VIEW**

## PARTS LIST

**TO ORDER:**  
 Original Key # and Original Code # are for cross-reference only. Please order parts using the Part # column and the prefix "RD" which indicates the Rear Drag reel series.

PART #	ORIGINAL KEY #	ORIGINAL CODE #	DESCRIPTION	PART #	ORIGINAL KEY #	ORIGINAL CODE #	DESCRIPTION
623.	1.	6-0209 31202S	Spool Assembly	42.	38.	7-0617 26100S	Drive Gear Bushing
2.	2.	7-0217 26100S	Spool Washer	360.	39.	7-0408 29220S	Drive Gear
3.	3.	7-2101 06100S	Tension Spring	41.	40.	7-0446 01100S	Drive Gear Washer
565.	4.	6-0219 31212S	Main Shaft Assembly	625.	41.	7-0011 30330S	Side Cover Screw
32.	5.	7-0014 30100S	Nut Lock Screw	44.	42.	7-0725 05500S	Handle Lock Washer
70.	6.	7-0360 26200S	Rotor Nut Lock Plate	45.	43.	7-0710 05100S	Handle Lock Screw
71.	7.	7-0311 01100S	Rotor Nut	46.	44.	7-0453 26100S	Handle Screw Cap
566.	8.	7-0301 29221S	Rotor	366.	45.	6-0449 27220S	Oscillating Gear Assembly
73.	9.	7-0355 21200S	Bail Trip Slide Cam	365.	46.	7-0410 29200S	Oscillating Slider
74.	10.	7-0336 21700S	Bail Trip Lever	364.	47.	7-0538 29200S	Oscillating Slider Retainer
75.	11.	7-0337 21200S	Lever Spring	363.	48.	7-0014 30120S	Slider Retainer Screw
76.	12.	7-0338 21700S	Bail Trip Cover	626.	49.	6-0609 31200S	Side Cover Assembly
77.	13.	7-0013 30100S	Cover Screw	627.	50.		Anti-Reverse Lever Washer
78.	14.	6-0309 26200S	Bail	147.	51.	7-0404 26300S	Anti-Reverse Lever
79.	15.	7-0335 14000S	Bail Trip Cam Screw	49.	52.	7-0023 15300S	Lock Washer
80.	16.	7-0304 01100S	Line Roller	50.	53.	7-0013 00100S	Anti-Reverse Lever Screw
81.	17.	7-0307 21700S	Bail Spring Cover	369.	54.	7-0112 26100S	Drag Shaft
82.	18.	7-0303 21700S	Bail Arm	108.	55.	7-0139 26200S	Drag Washer "C,"
83.	19.	7-0356 21700S	Trigger Pin Roller	373.	56.	7-0113 29200S	Click Gear
84.	20.	7-0306 21700S	Bail Arm Screw	374.	57.	7-0144 29200S	Drag Washer "E"
85.	21.	7-0357 21700S	Quick-Fire Trigger	370.	58.	7-0147 29200S	Eared Washer "G"
86.	22.	7-0358 21700S	Trigger Screw	371.	59.	7-0139 29200S	Drag Washer "C <sub>2</sub> "
88.	23.	7-0013 40410S	Line Roller Screw	117.	60.	7-0115 26200S	Key Washer "A"
89.	24.	7-0316 01100S	Lock Washer	110.	61.	7-0140 26210S	Drag Washer "D" (Black)
568.	25.	7-0310 21710S	Bail Spring	375.	62.	7-0116 29200S	Eared Washer "B"
90.	26.	7-0422 21700S	Anti-Reverse Pawl Spring	111.	63.	7-0119 26200S	Drag Coil Spring
94.	27.	7-0421 21700S	Anti-Reverse Ratchet	452.	64.	7-0135 26200S	Drag Spring Washer "A"
26.	28.	7-0402 19300S	Ball Bearing	113.	65.	7-0136 26200S	Drag Spring Washer "B"
356.	29.	7-0407 29220S	Pinion Gear	114.	66.	7-0110 26200S	Pressure Screw
358.	30.	7-0011 30470S	Bearing Retainer Screw	115A.	67.	7-0143 26200S	Stop Ring
96.	31.	7-0426 21200S	Anti-Reverse Cam Spring	628.	68.	7-0138 26201S	Drag Knob Click Spring
357.	32.	7-0424 29220S	Anti-Reverse Cam	629.	69.	6-0109 26201S	Drag Knob
91.	33.	7-0425 21700S	Anti-Reverse Pawl Screw	63.	70.	7-0134 26100S	Drag Knob Screw
92.	34.	6-0419 21700S	Anti-Reverse Pawl Assembly	119.	71.	6-0709 27215S	Handle Assembly
93.	35.	7-0457 19100S	Anti-Reverse Pawl Spacer	450.	72.	7-0152 26200S	Drag Spring Washer "C"
624.	36.	6-0409 31200S	Body				
359.	37.	7-0537 29200S	Oscillating Gear Bushing				