

SHIMANO

1987 REPAIR MANUAL

Shimano American Corporation, One Shimano Dr.
Irvine, CA 92718

NEW DRAG SYSTEM

NEW DRAG PARTS

- 440. Drag Knob Click Spring* .20
- 454. Drag Shaft 1.25
- 455. Lock Washer .20
- 456. Lock Spring .15
- 457. Base Spring Washer .15
- 458. Spring Housing .75

*New Longer Spring

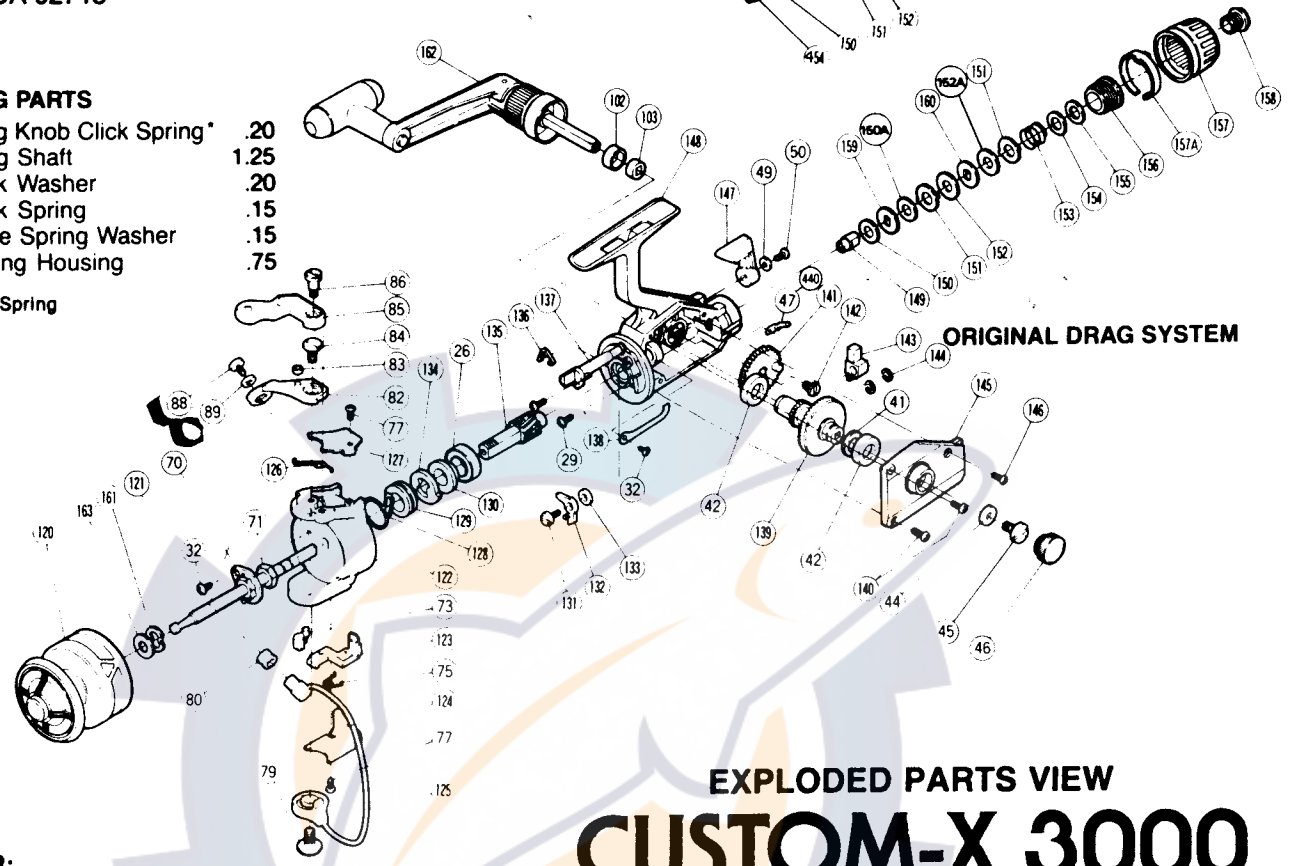

ORIGINAL DRAG SYSTEM

EXPLODED PARTS VIEW

CUSTOM-X 3000

TO ORDER:
This reel belongs to the "Rear Drag" series.
Please order parts using the abbreviation
"RD" and the part number.

PARTS LIST

PART# DESCRIPTION

- 26. Ball Bearing
- 29. Bearing Retainer Screw
- 32. Multi Purpose Screw
- 41. Thrust Washer
- 42. Drive Gear Bushing
- 44. Handle Screw Lock Washer
- 45. Handle Screw
- 46. Dust Cap
- 47. Drag Knob Click Spring
- 49. Lock Washer
- 50. Anti Reverse Lever Screw
- 70. Rotor Nut Lock
- 71. Rotor Nut
- 73. Trip Plate Cam
- 75. Trip Plate Spring
- 77. Cover Screw
- 79. Bail Screw
- 80. Roller Line Guide
- 82. Bail Mount
- 83. Trigger Pin Roller
- 84. Bail Mount Screw
- 85. Quickfire Trigger
- 86. Trigger Screw
- 88. Bail Wire Screw

PART# DESCRIPTION

- 89. Guide Screw Lock Washer
- 102. Bushing Ring
- 103. Handle Shaft Bushing
- 120. Spool
- 121. Spindle
- 122. Rotor
- 123. Trip Plate
- 124. Trip Plate Cover
- 125. Bail Wire
- 126. Bail Spring
- 127. Bail Spring Cover
- 128. Rotor Stop Spring
- 129. Stop Spring Arbor
- 130. Ratchet Spacer
- 131. Anti Reverse Dog Screw
- 132. Anti Reverse Dog
- 133. Anti Reverse Dog Spacer
- 134. Self Center Ratchet
- 135. Pinion Gear
- 136. Anti Reverse Shaft Spring
- 137. Anti Reverse Shaft
- 138. Drag Click Spring
- 139. Drive Gear
- 140. Side Plate Screw 1
- 141. Oscillation Gear

PART# DESCRIPTION

- 142. Oscillation Gear Screw
- 143. Oscillation Block
- 144. "C" Lock
- 145. Side Plate
- 146. Side Plate Screw 2
- 147. Anti Reverse Lever
- 148. Housing
- 149. Drag Shaft
- 150. Drag Washer (Black)
- 150A. Drag Washer (White)
- 151. Keyed Washer 1
- 152. Drag Washer (Black)
- 152A. Drag Washer (White)
- 153. Drag Spring
- 154. Base Spring Washer
- 155. Friction Washer
- 156. Spring Housing
- 157. Drag Adjusting Knob
- 157A. Stop Ring
- 158. Drag Screw
- 159. Ratchet Washer
- 160. D Washer
- 161. Tension Spring
- 162. Handle
- 163. Spool Spacer

Prices and specifications subject to change without notice

JUNE 1986