

1987 REPAIR MANUAL

Shimano American Corporation, One Shimano Dr.
Irvine, CA 92718

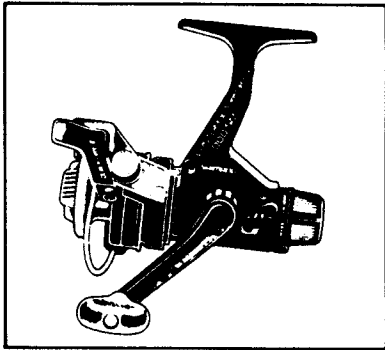

TO ORDER:

This reel belongs to the "Rear Drag" series.
Please order parts using the abbreviation
"RD" and the part number.

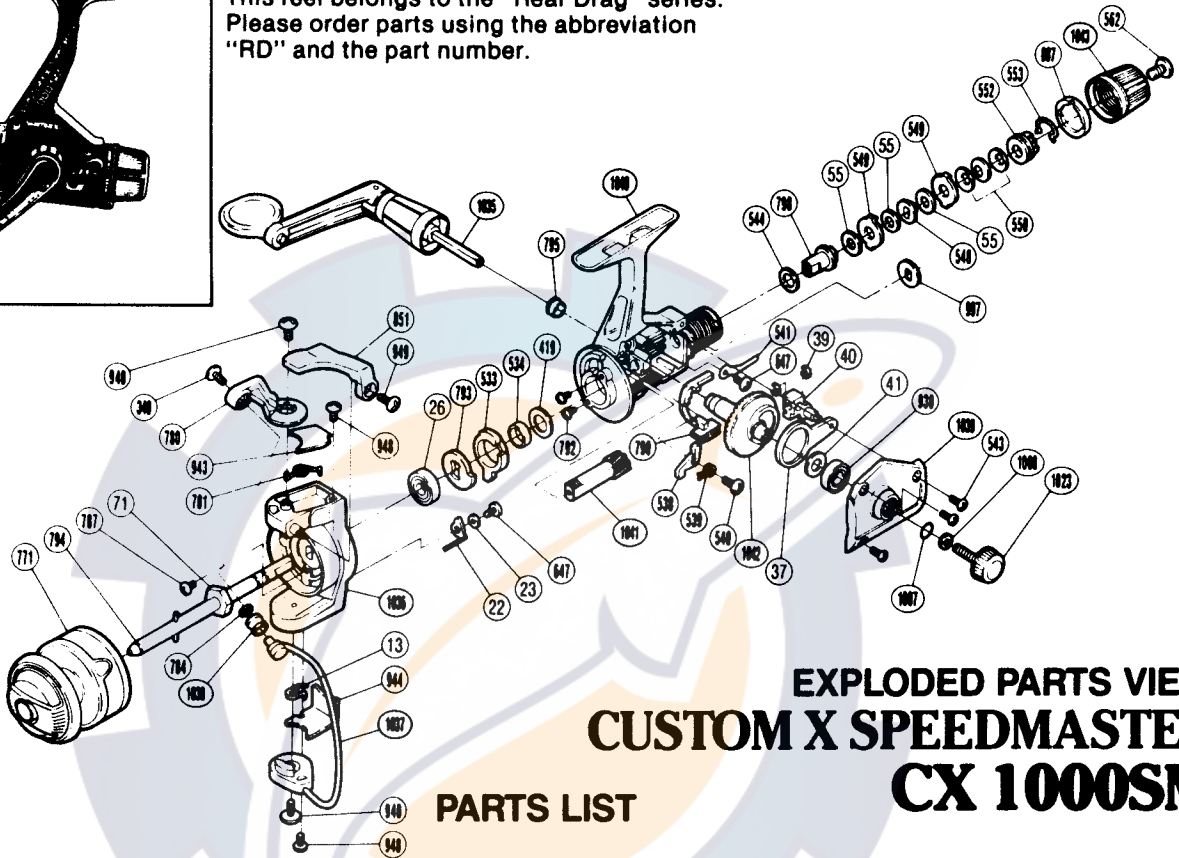

EXPLODED PARTS VIEW CUSTOM X SPEEDMASTER™ CX 1000SM

PARTS LIST

PART # DESCRIPTION

- 13. (Trip) Lever Spring
- 22. (Bail) Trip Lever
- 23. Trip Lever Spacer
- 26. Ball Bearing
- 37. Oscillating Arm
- 39. "C" Lock
- 40. Oscillating Block
- 41. Drive Gear Washer
- 55. Drag Washer "C(1)" (Black)
- 71. Rotor Nut
- 340. Line Roller Screw
- 419. Bushing Washer (B)
- 533. Anti-Reverse Lock Out
- 534. Pinion Spacer
- 538. Anti-Reverse Pawl
- 539. Anti-Reverse Pawl Spring
- 540. Anti-Reverse Pawl Screw
- 541. Drag Click
- 543. Side Cover Screw (B)
- 544. Drag Washer "C2" (White)

PART # DESCRIPTION

- 548. Key Washer "A"
- 549. Eared Washer "B"
- 550. Coned Disc Spring
- 552. Pressure Screw
- 553. Hold Click Spring
- 562. Drag Programmer Screw
- 647. Nut Lock Screw
- 771. Spool Assembly (Universal)
- 780. Bail Arm
- 781. Bail Spring
- 784. Line Roller Washer
- 787. Nut Lock Screw
- 790. Anti-Reverse Switch
- 792. Bearing Retainer Screw
- 793. Anti-Reverse Ratchet
- 794. Main Shaft
- 795. Bushing B
- 798. Drag Shaft
- 851. Quick-Fire II Trigger

PART # DESCRIPTION

- 887. Knob Spacer
- 930. Ball Bearing
- 940. Bail Trip Cam Screw
- 943. Bail Spring Cover
- 944. Bail Trip Cover
- 948. Bail Trip Cover Screw
- 949. Trigger Screw
- 997. Click Gear
- 1007. Lock Washer Retainer
- 1008. Handle Lock Washer
- 1023. Handle Screw Cap
- 1035. Handle Assembly
- 1036. Rotor
- 1037. Bail Assembly
- 1038. Sic Ceramic Roller
- 1039. Side Cover
- 1040. Body
- 1041. Pinion Gear
- 1042. Drive Gear
- 1043. Drag Knob