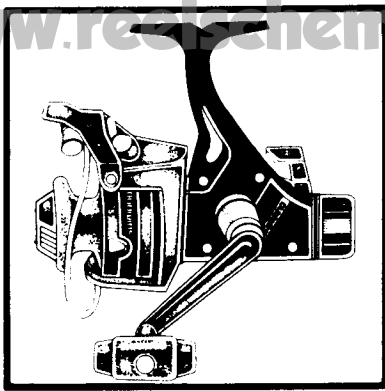
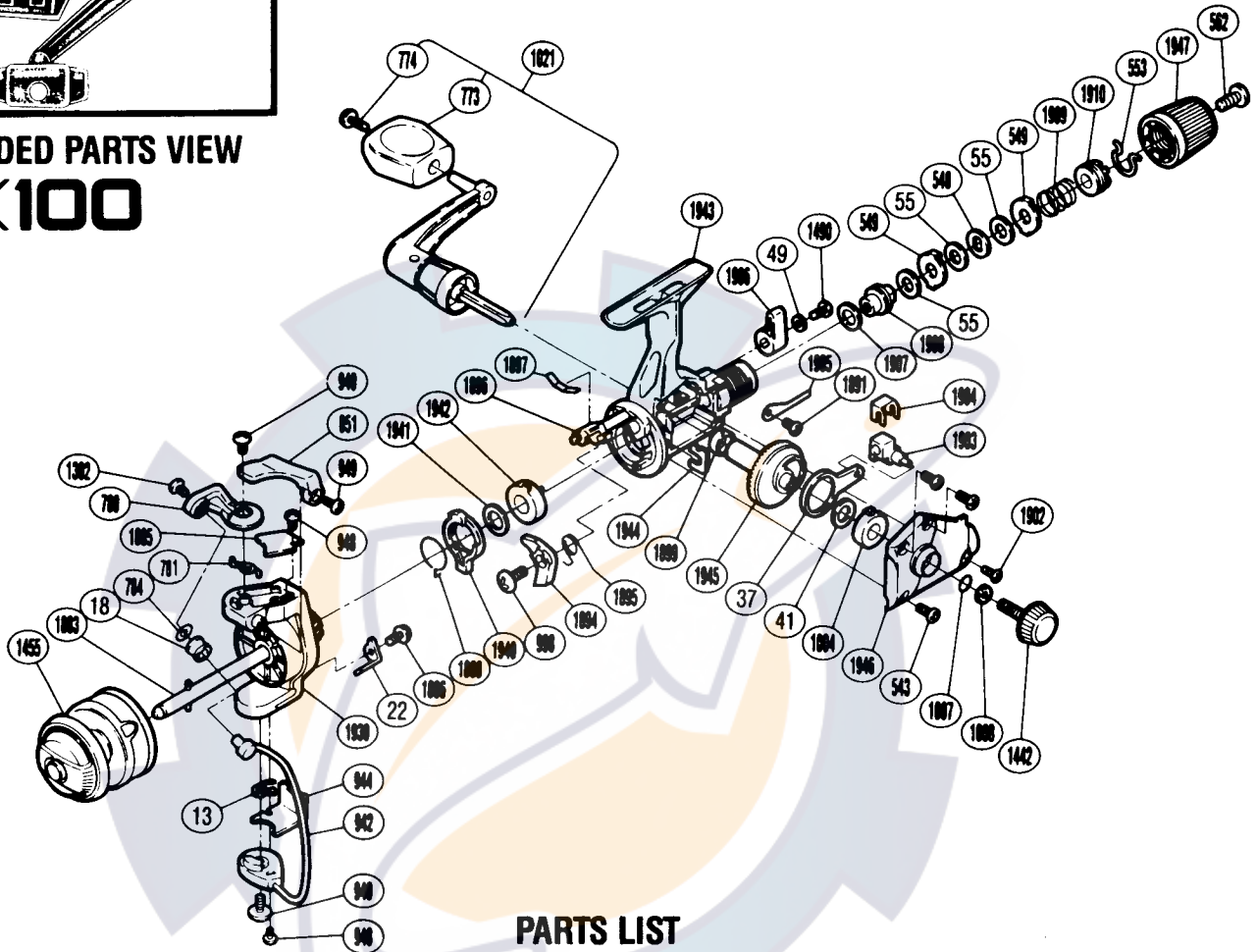

1989 REPAIR MANUALShimano American Corporation, One Shimano Dr.
Irvine, CA 92718**EXPLODED PARTS VIEW
FX100****PARTS LIST****PART # DESCRIPTION**

RD 0013	(Trip) Lever Spring
RD 0018	Line Roller
RD 0022	(Bail) Trip Lever
RD 0037	Oscillating Arm
RD 0041	Drive Gear Washer
RD 0049	Lock Washer
RD 0055	Drag Washer "C(1)" (Black)
RD 0543	Side Cover Screw (B)
RD 0548	Key Washer "A"
RD 0549	Eared Washer "B"
RD 0553	Hold Click Spring
RD 0562	Drag Programmer Screw
RD 0773	Handle Knob
RD 0774	Handle Knob Screw
RD 0780	Bail Arm
RD 0781	Bail Spring
RD 0784	Line Roller Washer
RD 0851	Quick-Fire II Trigger
RD 0940	Bail Trip Cam Screw
RD 0942	Bail Assembly

PART # DESCRIPTION

RD 0944	Bail Trip Cover
RD 0948	Bail Trip Cover Screw
RD 0949	Trigger Screw
RD 0998	Anti-Reverse Pawl Screw
RD 1004	Bushing A
RD 1007	Lock Washer Retainer
RD 1008	Handle Lock Washer
RD 1021	Handle Assembly
RD 1302	Line Roller Screw
RD 1442	Handle Screw Cap
RD 1455	Spool Assembly
RD 1490	Anti-Reverse Lever Screw
RD 1883	Main Shaft
RD 1885	Bail Spring Cover
RD 1886	Trip Lever Screw
RD 1888	Anti-Reverse Lock Out Spring
RD 1891	Multi Purpose Screw
RD 1894	Anti-Reverse Pawl
RD 1895	Anti-Reverse Pawl Spring
RD 1896	Anti-Reverse Cam

PART # DESCRIPTION

RD 1897	Anti-Reverse Cam Spring
RD 1899	Bushing B
RD 1902	Side Cover Screw (B)
RD 1903	Oscillating Block
RD 1904	Oscillating Block Retainer
RD 1905	Drag Click
RD 1906	Anti-Reverse Lever
RD 1907	Drag Washer "E"
RD 1908	Drag Shaft
RD 1909	Drag Coil Spring
RD 1910	Pressure Screw
RD 1939	Rotor
RD 1940	Anti-Reverse Lock Out
RD 1941	Bushing Washer
RD 1942	Bushing
RD 1943	Body
RD 1944	Rotor Lock
RD 1945	Drive Gear
RD 1946	Side Cover
RD 1947	Drag Knob