

1988 REPAIR MANUAL

Shimano American Corporation, One Shimano Dr.
Irvine, CA 92718

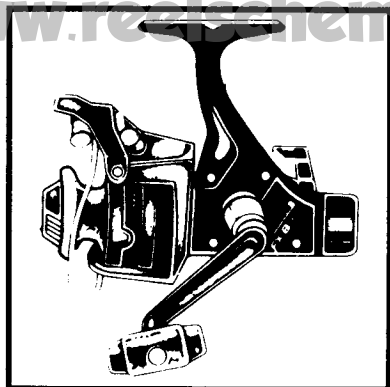

EXPLODED PARTS VIEW

MEDIUM SPECIAL GRAPHITE CONSTRUCTION

FX300

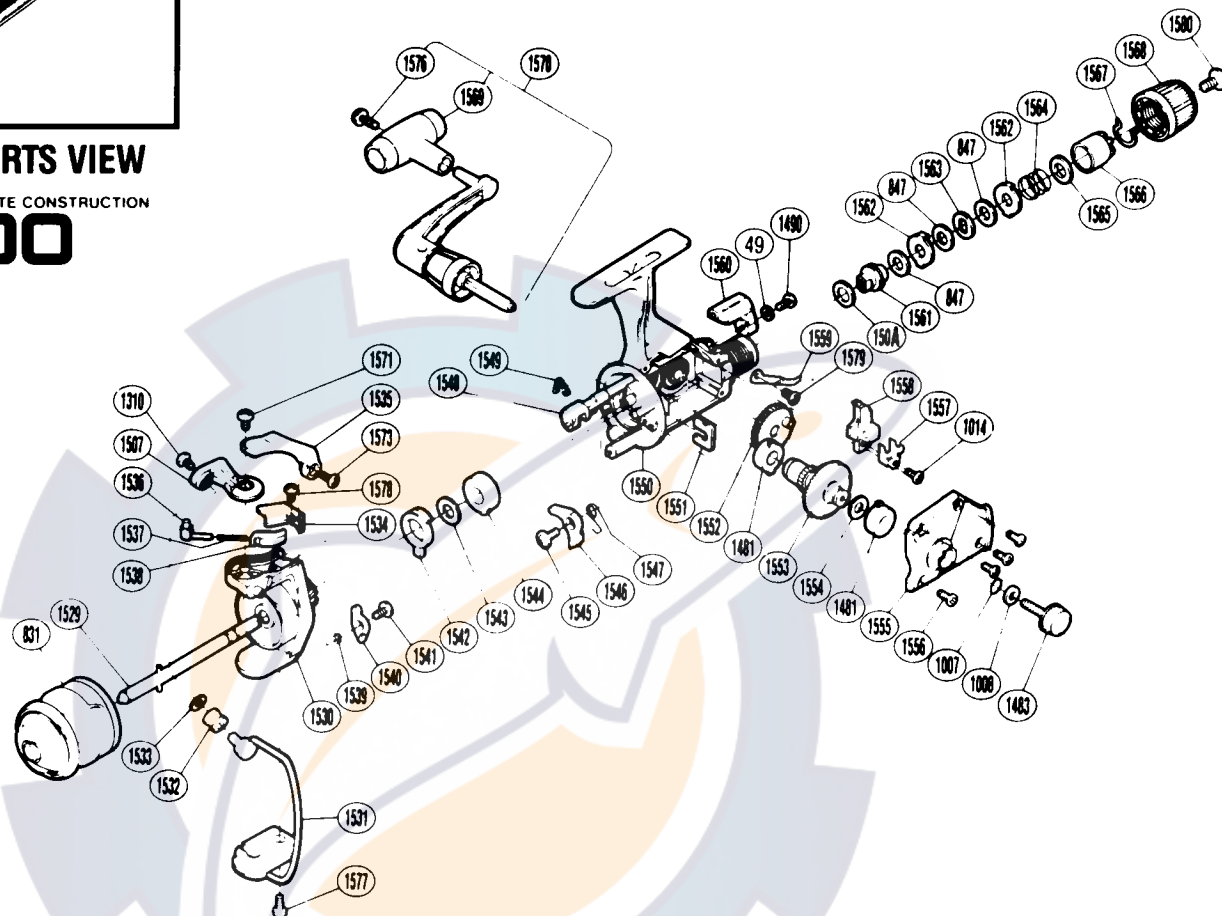

PARTS LIST

PART # DESCRIPTION

- RD 0049 Lock Washer
- RD 0150A Drag Washer "C2" (White)
- RD 0831 Spool Assembly (Universal)
- RD 0847 Drag Washer "H1"
- RD 1007 Lock Washer Retainer
- RD 1008 Handle Lock Washer
- RD 1014 Slider Retainer Screw
- RD 1310 Line Roller Screw
- RD 1481 Bushing A
- RD 1483 Handle Screw Cap
- RD 1490 Anti-Reverse Lever Screw
- RD 1507 Bail Arm
- RD 1529 Main Shaft
- RD 1530 Rotor
- RD 1531 Bail Assembly
- RD 1532 Line Roller
- RD 1533 Line Roller Washer
- RD 1534 Bail Spring Cover
- RD 1535 Quick-Fire II Trigger
- RD 1536 Bail Spring Guide A
- RD 1537 Bail Spring

PART # DESCRIPTION

- RD 1538 Bail Spring Guide B
- RD 1539 Lever Spring
- RD 1540 Bail Trip Lever
- RD 1541 Lever Screw
- RD 1542 Anti-Reverse Lock Out
- RD 1543 Bushing Washer
- RD 1544 Bushing
- RD 1545 Anti-Reverse Pawl Screw
- RD 1546 Anti-Reverse Pawl
- RD 1547 Anti-Reverse Pawl Spring
- RD 1548 Anti-Reverse Cam
- RD 1549 Anti-Reverse Cam Spring
- RD 1550 Body
- RD 1551 Rotor Lock
- RD 1552 Oscillating Gear
- RD 1553 Drive Gear
- RD 1554 Drive Gear Washer
- RD 1555 Side Cover
- RD 1556 Side Cover Screw
- RD 1557 Oscillating Slider Retainer
- RD 1558 Oscillating Slider

PART # DESCRIPTION

- RD 1559 Drag Click
- RD 1560 Anti-Reverse Lever
- RD 1561 Drag Shaft
- RD 1562 Eared Washer "B"
- RD 1563 Key Washer "A"
- RD 1564 Drag Coil Spring
- RD 1565 Drag Spring Washer "A"
- RD 1566 Pressure Screw
- RD 1567 Hold Click Spring
- RD 1568 Drag Knob
- RD 1569 Handle Knob
- RD 1570 Handle Assembly
- RD 1571 Bail Trip Cam Screw
- RD 1573 Trigger Screw
- RD 1576 Handle Knob Screw
- RD 1577 Bail Hold Cover Screw
- RD 1578 Bail Spring Cover Screw
- RD 1579 Drag Click Screw
- RD 1580 Drag Knob Screw

Prices and specifications subject to change without notice.

OCTOBER, 1987