

## 1989 REPAIR MANUAL

Shimano American Corporation, One Shimano Dr.  
Irvine, CA 92718

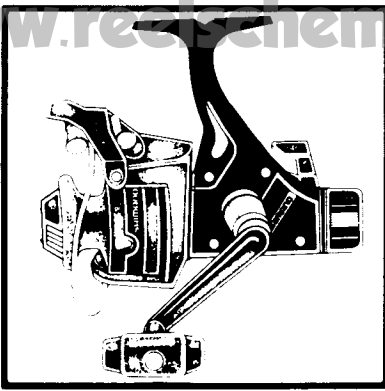

### EXPLODED PARTS VIEW FX300

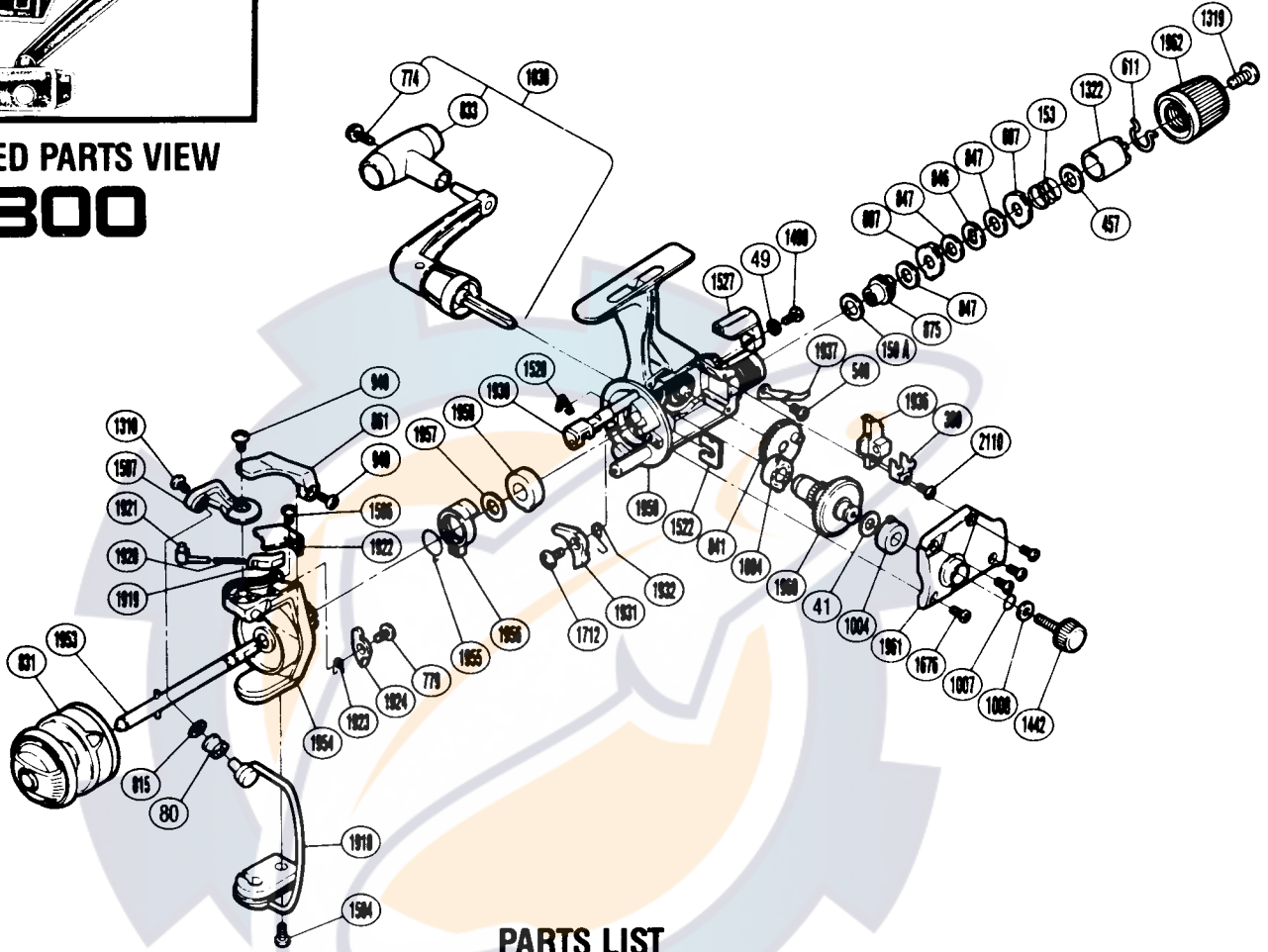

### PARTS LIST

**PART # DESCRIPTION**

- RD 0041 Drive Gear Washer
- RD 0049 Lock Washer
- RD 0080 Line Roller
- RD 0150A Drag Washer "C2" (White)
- RD 0153 Drag (Coil) Spring
- RD 0389 Oscillating Slider Retainer
- RD 0457 Drag Spring Washer "A"
- RD 0540 Anti-Reverse Pawl Screw
- RD 0607 Eared Washer "B"
- RD 0611 Hold Click Spring
- RD 0774 Handle Knob Screw
- RD 0779 Bail Trip Cam Screw
- RD 0815 Line Roller Washer
- RD 0831 Spool Assembly (Universal)
- RD 0833 Handle Knob
- RD 0841 Oscillating Gear
- RD 0846 Key Washer "A"
- RD 0847 Drag Washer "H1"
- RD 0861 Quick-Fire II Trigger
- RD 0875 Drag Shift
- RD 0940 Bail Trip Cam Screw

**PART # DESCRIPTION**

- RD 0949 Trigger Screw
- RD 1004 Bushing A
- RD 1007 Lock Washer Retainer
- RD 1008 Handle Lock Washer
- RD 1030 Handle Assembly
- RD 1310 Line Roller Screw
- RD 1319 Drag Knob Screw
- RD 1322 Pressure Screw
- RD 1442 Handle Screw Cap
- RD 1490 Anti-Reverse Lever Screw
- RD 1504 Bail Hold Cover Screw
- RD 1506 Bail Spring Cover Screw
- RD 1507 Bail Arm
- RD 1520 Anti-Reverse Cam Spring
- RD 1522 Rotor Lock
- RD 1527 Anti-Reverse Lever
- RD 1676 Side Cover Screw
- RD 1712 Anti-Reverse Pawl Screw
- RD 1918 Bail Assembly
- RD 1919 Bail Spring Guide B
- RD 1920 Bail Spring

**PART # DESCRIPTION**

- RD 1921 Bail Spring Guide A
- RD 1922 Bail Spring Cover
- RD 1923 Lever Spring
- RD 1924 Bail Trip Lever
- RD 1930 Anti-Reverse Cam
- RD 1931 Anti-Reverse Pawl
- RD 1932 Anti-Reverse Pawl Spring
- RD 1936 Oscillating Slider
- RD 1937 Drag Click
- RD 1953 Main Shaft
- RD 1954 Rotor
- RD 1955 Anti-Reverse Lock Out Spring
- RD 1956 Anti-Reverse Lock Out
- RD 1957 Bushing Washer
- RD 1958 Bushing
- RD 1959 Body
- RD 1960 Drive Gear
- RD 1961 Side Cover
- RD 1962 Drag Knob
- RD 2110 Slider Retainer Screw