

⚠ Please check the head of the "Magnetic Control Dial" here to see whether you have an old or new-type reel.

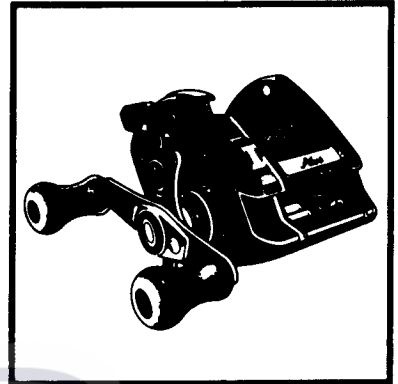
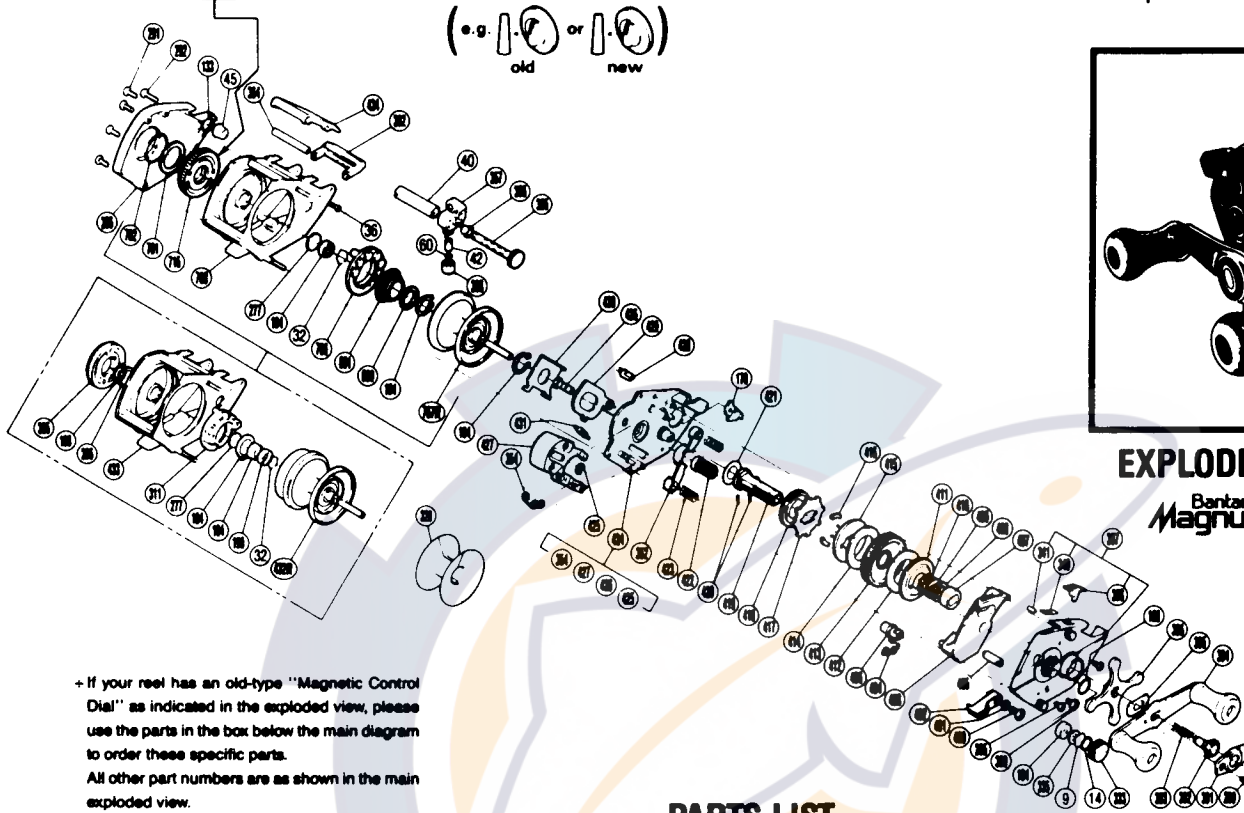
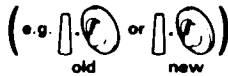

EXPLODED PARTS VIEW

Bantam
Magnumlite 2000GT Plus

+ If your reel has an old-type "Magnetic Control Dial" as indicated in the exploded view, please use the parts in the box below the main diagram to order these specific parts.

All other part numbers are as shown in the main exploded view.

PARTS LIST

PART # DESCRIPTION

- BNT 0009 Spacer (A)
- BNT 0014 Friction Washer (B)
- BNT 0032 Bearing Retainer
- BNT 0036 Stabilizer Bar Screw (A) (S)
- BNT 0040 Level Wind Guard
- BNT 0042 Line Guide Pawl
- BNT 0045 Worm Bearing (B)
- BNT 0060 Spacer (Optional)
- BNT 0133 Worm Shaft Retainer
- BNT 0170 Anti-Reverse Pawl (Assembly)
- BNT 0184 Magnet Retainer Lock
- BNT 0188 O Ring
- BNT 0194 Ball Bearing
- BNT 0198 Bearing Spacer
- BNT 0265 Spacer (Optional)
- BNT 0277 Spacer (B)
- BNT 0280 Handle Screw "B"
- BNT 0285 Set Plate Screw
- BNT 0291 Side Plate Screw
- BNT 0292 Stabilizer Bar Screw (B)
- BNT 0311 Magnet Retainer (Assembly)
- BNT 0328 V Spool Converter
- BNT 0333 Cast Control Cap
- BNT 0335 Bearing Washer (A)
- BNT 0340 Switch Spring
- BNT 0341 Switch Spring Lock
- BNT 0352 (Pinion) Yoke
- BNT 0354 Retractor Spring
- BNT 0355 Worm Shaft Assembly
- BNT 0356 Worm Bearing "A"

PART # DESCRIPTION

- BNT 0357 Line Guide (Assembly)
- BNT 0358 Pawl Cap
- BNT 0362 Level Wind Protector
- BNT 0364 Stabilizer Bar
- BNT 0365 Magnetic Control Dial
- BNT 0366 Left Side Plate
- BNT 0391 Handle Screw Lock Plate
- BNT 0392 Handle Screw "A"
- BNT 0393 Drive Shaft Spring
- BNT 0394 Handle Assembly
- BNT 0395 Friction Washer "A"
- BNT 0396 Star Drag Assembly
- BNT 0397 Right Side Plate Assembly
- BNT 0398 Anti-Reverse Switch
- BNT 0399 Retractor Guide Screw (Large Head)
- BNT 0400 Fightin' Lever Screw
- BNT 0401 Fightin' Lever Screw Washer
- BNT 0402 Fightin' Lever
- BNT 0403 Clutch Button Attachment
- BNT 0404 Joint Cam Yoke Spring
- BNT 0405 Retractor Guide
- BNT 0406 Joint Cam Yoke
- BNT 0407 Bushing "B"
- BNT 0408 Friction Washer "B"
- BNT 0409 Drag Spring Washer
- BNT 0410 Friction Washer "C"
- BNT 0411 Key Washer "A"
- BNT 0412 Drag Washer
- BNT 0413 Drive Gear

PART # DESCRIPTION

- BNT 0414 Drive Shaft Washer "B"
- BNT 0415 Key Washer "B"
- BNT 0416 Gear Protector Rubber
- BNT 0417 Anti-Reverse Ratchet
- BNT 0418 Level Wind Drive Gear
- BNT 0419 Drive Shaft
- BNT 0420 Drive Shaft Lock
- BNT 0421 Drive Shaft Washer "A"
- BNT 0422 Pinion Gear Assembly
- BNT 0423 Yoke Spring
- BNT 0424 Set Plate Assembly
- BNT 0425 Clutchbutton Lock
- BNT 0426 Fightin' Lever Cam
- BNT 0427 Clutch Button
- BNT 0428 Slide Cam
- BNT 0429 Slide Plate
- BNT 0430 Slide Plate Cover
- BNT 0431 Slide Plate Spring
- BNT 0432R Spool Assembly
- BNT 0433 Frame Assembly
- BNT 0434 Thumb Rest
- BNT 0660 Spring Spacer
- BNT 0661 Magnet Retainer Spring
- BNT 0701 Thrust Washer Spacer (Optional)
- BNT 0702 Dial O Ring
- BNT 0706 Magnet Retainer
- BNT 0716 Magnet Control Dial
- BNT 0767R Spool Assembly
- BNT 0768 Frame Assembly