

1987 REPAIR MANUAL

Shimano American Corporation, One Shimano Dr.
 Irvine, CA 92718

EXPLODED PARTS VIEW

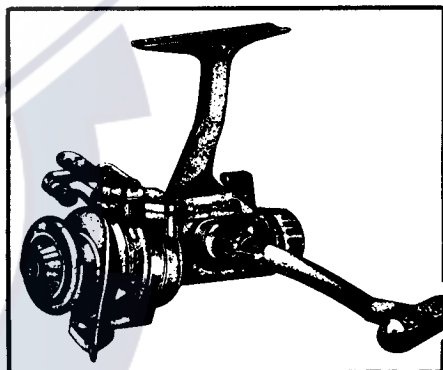
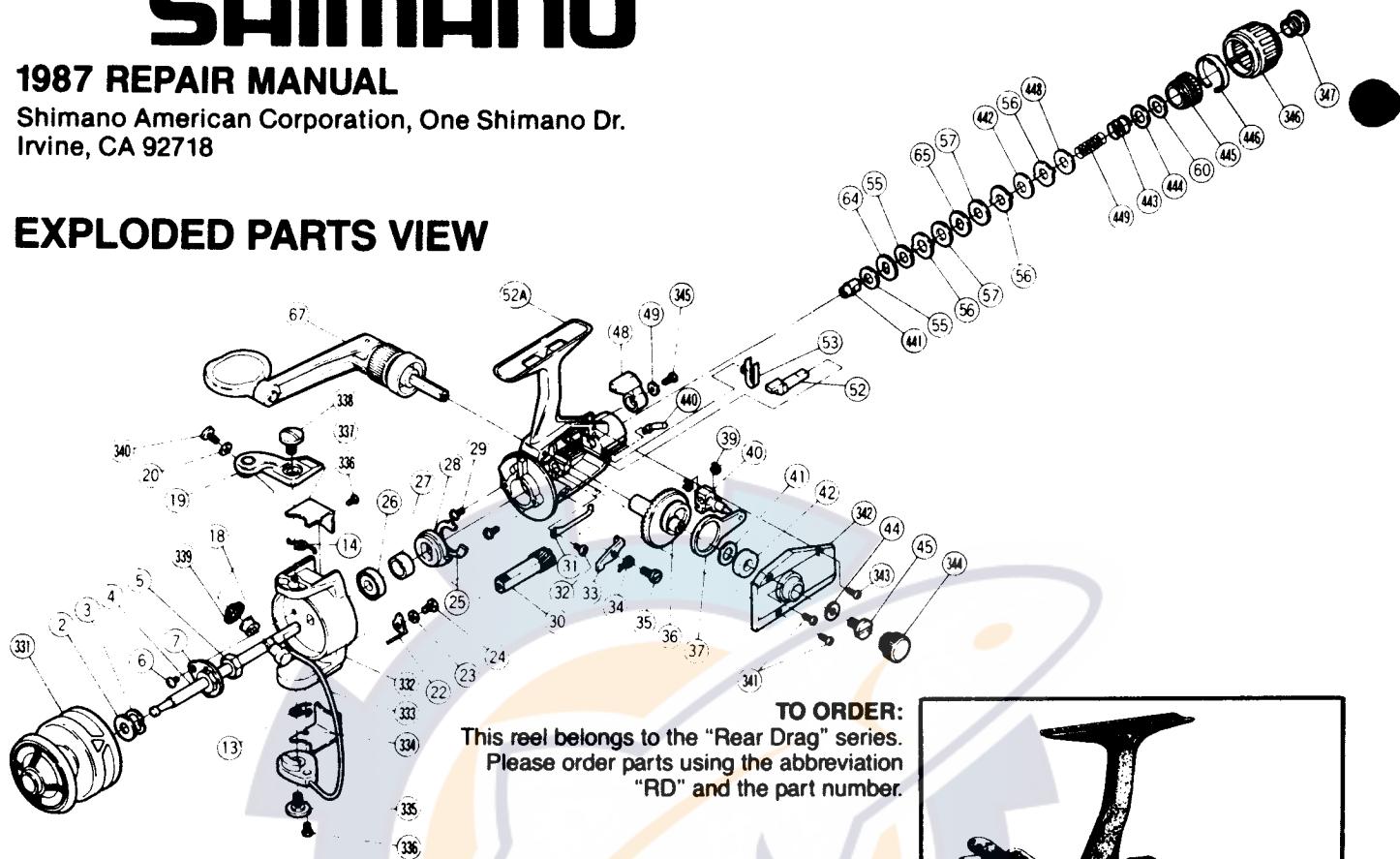

GRX-1100

PARTS LIST

PART# DESCRIPTION

- 2. Spool Spacer
- 3. Tension Spring
- 4. Spindle
- 5. Rotor Nut
- 6. Nut Lock Screw
- 7. Rotor Nut Lock
- 13. Trip Lever Spring
- 14. Bail Spring
- 18. Roller Line Guide
- 19. QuickFire Trigger
- 20. Guide Screw Lock Washer
- 22. Trip Lever
- 23. Trip Lever Spacer
- 24. Trip Lever Screw
- 25. Anti Reverse Lock Out
- 26. Bail Bearing
- 27. Bearing Spacer
- 28. Self Center Ratchet
- 29. Bearing Retainer Screw
- 30. Pinion Gear
- 31. Drag Click
- 32. Multi Purpose Screw
- 33. Anti Reverse Dog
- 34. Anti Reverse Dog Spring

PART# DESCRIPTION

- 35. Anti Reverse Dog Screw
- 36. Drive Gear
- 37. Oscillation Guide
- 39. "C" Lock
- 40. Oscillation Guide Block
- 41. Thrust Washer
- 42. Drive Gear Bushing
- 44. Handle Screw Lock Washer
- 45. Handle Screw
- 48. Anti Reverse Lever
- 49. Lock Washer
- 52. Anti Reverse Shaft
- 52A. Housing
- 53. Anti Reverse Shaft Spring
- 55. Drag Washer A
- 56. Keyed Washer #1
- 57. Drag Washer B
- 60. Friction Washer
- 64. Ratchet Washer
- 65. D Washer
- 67. Handle
- 331. Spool
- 332. Rotor
- 333. Bail Wire

PART# DESCRIPTION

- 334. Trip Lever Cover
- 335. Bail Wire Screw
- 336. Cover Screw
- 337. Bail Spring Cover
- 338. Trigger Screw
- 339. Line Guide Spacer
- 340. Bail Wire Screw
- 341. Side Plate Screw #1
- 342. Side Plate
- 343. Side Plate Screw #2
- 344. Dust Cap
- 345. Anti Reverse Lever Screw
- 346. Drag Adjusting Knob
- 347. Drag Screw
- 440. Drag Knob Click Spring
- 441. Drag Shaft
- 442. Spring Washer
- 443. Drag Spring
- 444. Base Spring Washer
- 445. Spring Housing
- 446. Stop Ring
- 448. Lock Washer
- 449. Lock Spring

Prices and specifications subject to change without notice

JUNE 1986