

1987 REPAIR MANUAL KX I

Shimano American Corporation, One Shimano Dr.
Irvine, CA 92718



TO ORDER:

This reel belongs to the "KX, Bass-1" series.
Please order parts using the abbreviation
"KXB" and the part number.

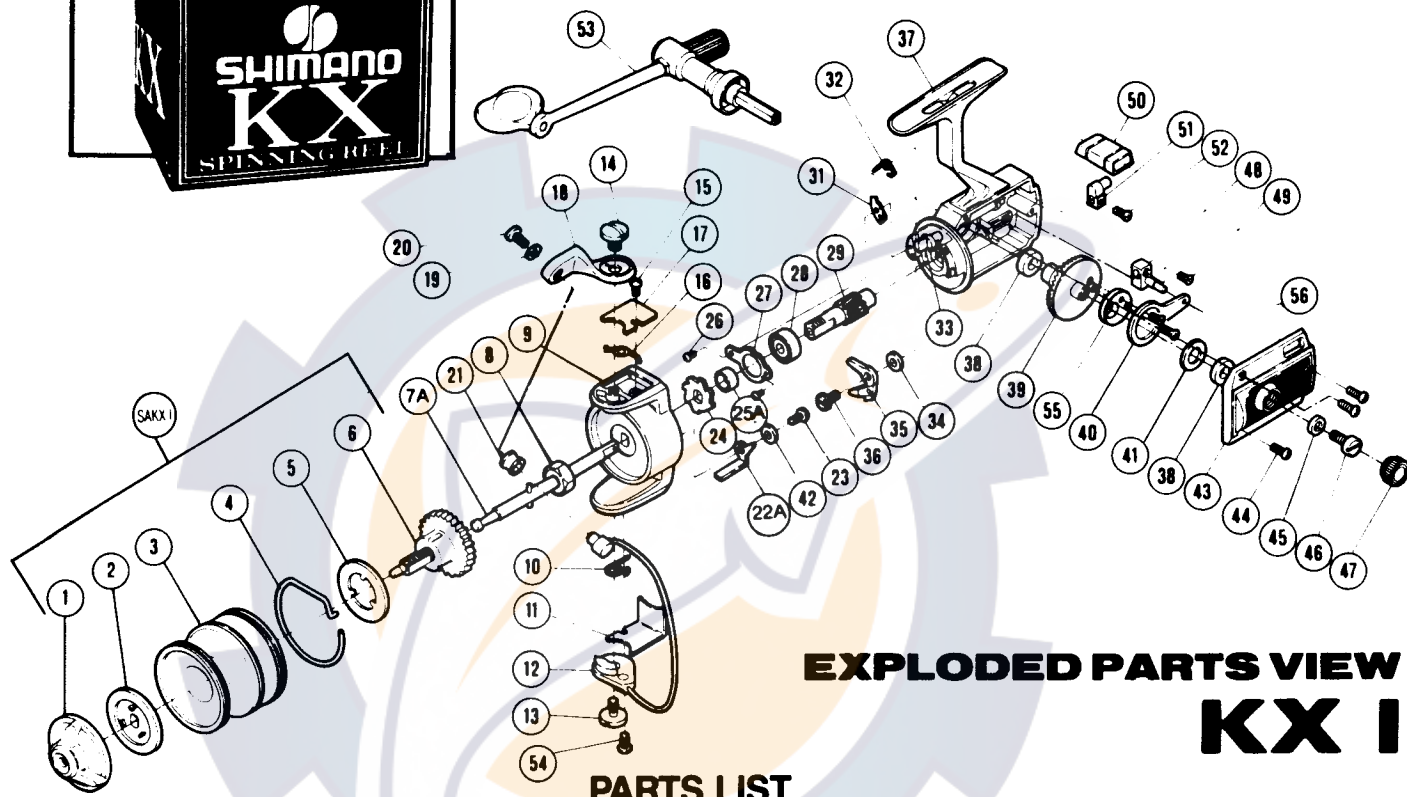

EXPLODED PARTS VIEW KX I

PARTS LIST

PART # DESCRIPTION

- 1. Drag Adjusting Knob
- 2. Drag Disk
- 3. Spool Shell
- 4. Click Spring
- 5. Base Drag Washer
- 6. Spool Spindle
- 7A. Spool Axle
- 8. Rotor Nut
- 9. Rotor
- 10. Trip Lever Spring
- 11. Trip Lever Cover
- 12. Bail Wire
- 13. Bail Wire Screw
- 14. Bail Mount Screw
- 15. Bail Spring Cover Screw
- 16. Bail Spring
- 17. Bail Spring Cover
- 18. Bail Mount
- 19. Line Guide Lock Washer
- 20. Line Guide Screw
- 21. Roller Line Guide

PART # DESCRIPTION

- 22A. Trip Lever
- 23. Trip Lever Screw
- 24. Anti Reverse Ratchet
- 25A. Anti Reverse Spacer
- 26. Bearing Lock Screw
- 27. Bearing Lock
- 28. Ball Bearing
- 29. Pinion Gear
- 31. Trip Cam
- 32. Anti Reverse Shaft Spring
- 33. Anti Reverse Shaft
- 34. Anti Reverse Dog Spacer
- 35. Anti Reverse Dog
- 36. Anti Reverse Dog Screw
- 37. Housing
- 38. Drive Gear Bushing
- 39. Drive Gear
- 40. Oscillation Guide
- 41. Thrust Washer

PART # DESCRIPTION

- 42. Trip Lever Spacer
- 43. Side Plate
- 44. Side Plate Screw
- 45. Handle Screw Lock Washer
- 46. Handle Retainer Screw
- 47. Dust Cap
- 48. Oscillation Block
- 49. Oscillation Block Screw
- 50. Anti Reverse Switch
- 51. Anti Reverse Actuator
- 52. Actuator Screw
- 53. Handle
- 54. Trip Lever Cover Screw
- 55. Oscillation Disk
- 56. Oscillation Disk Screw
- SAKXI Complete Spool Assembly