

REPAIR MANUAL SHEET MLZ-40

Shimano American Corporation, 205 Jefferson Road
Parsippany, N.J. 07054

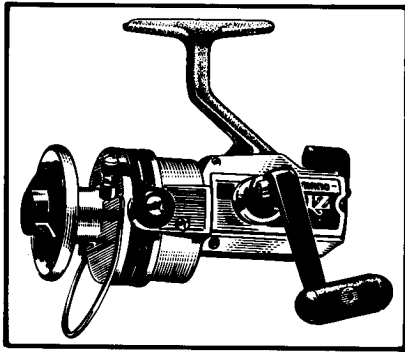

MLZ-40

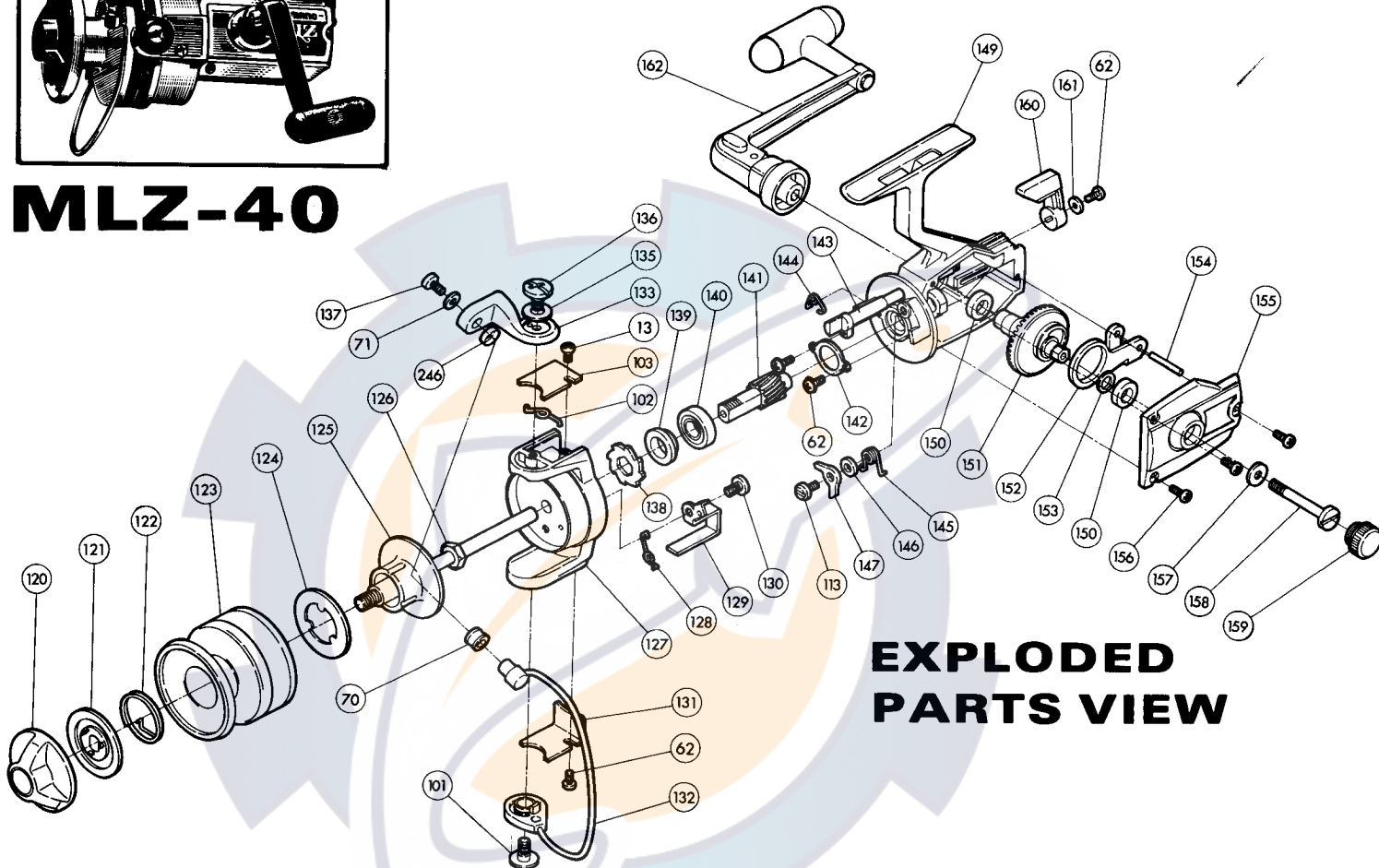

EXPLODED PARTS VIEW

PARTS LIST

| PART# | DESCRIPTION | PRICE | PART# | DESCRIPTION | PRICE | PART# | DESCRIPTION | PRICE |
|-------|------------------------|-------|-------|-----------------------------|-------|-------|-------------------------------|-------|
| 13 | Cover screw | .15 | 129 | Trip lever | .75 | 147 | Anti reverse dog | .50 |
| 62 | Cover screw | .25 | 130 | Trip lever screw | .15 | 149 | Housing | 6.50 |
| 70 | Roller line guide | .50 | 131 | Trip lever cover | .25 | 150 | Drive gear bushing | 1.30 |
| 71 | Lock washer | .15 | 132 | Bail wire | 2.00 | 151 | Drive gear | 1.50 |
| 101 | Bail wire screw | .35 | 133 | Bail mount | 1.00 | 152 | Oscillation guide | .50 |
| 102 | Bail spring | .25 | 135 | Bail mount washer (opt.) | .15 | 153 | Drive gear spacer | .15 |
| 103 | Bail spring cover | .15 | 136 | Bail mount screw | .25 | 154 | Oscillation guide pin | .15 |
| 113 | Anti reverse dog screw | .35 | 137 | Bail wire screw | .25 | 155 | Side plate | 2.50 |
| 120 | Drag adjusting knob | 2.00 | 138 | Anti reverse ratchet | .75 | 156 | Side plate screw | .15 |
| 121 | Drag disk | .60 | 139 | Anti reverse ratchet spacer | .35 | 157 | Handle screw lock washer | .15 |
| 122 | Click spring | .25 | 140 | Ball bearing | 5.25 | 158 | Handle screw | 1.50 |
| 123 | Spool shell | 10.00 | 141 | Pinion gear | 2.00 | 159 | Dust cover | .45 |
| 124 | Base drag disk | .15 | 142 | Bearing retainer | .25 | 160 | Anti reverse lever | .25 |
| 125 | Spindle | 1.80 | 143 | Anti reverse shaft | 1.00 | 161 | Anti reverse lever lock wash. | .15 |
| 126 | Rotor nut | .25 | 144 | Anti reverse shaft spring | .25 | 162 | Handle | 6.25 |
| 127 | Rotor | 5.25 | 145 | Anti reverse dog spring | .25 | 246 | Line guide cover | .25 |
| 128 | Trip lever spring | .15 | 146 | Anti reverse dog spacer | .15 | | | |

Prices and specifications subject to change without notice.

Mar. 6 '81