

1987 REPAIR MANUAL

Shimano American Corporation, One Shimano Dr.
Irvine, CA 92718

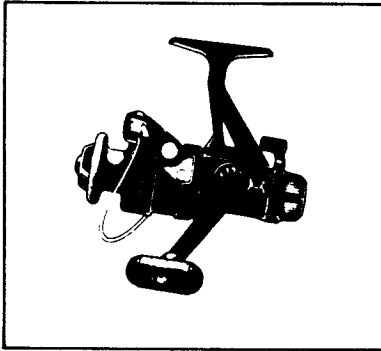

TO ORDER:

This reel belongs to the "Rear Drag" series.
Please order parts using the abbreviation
"RD" and the part number.

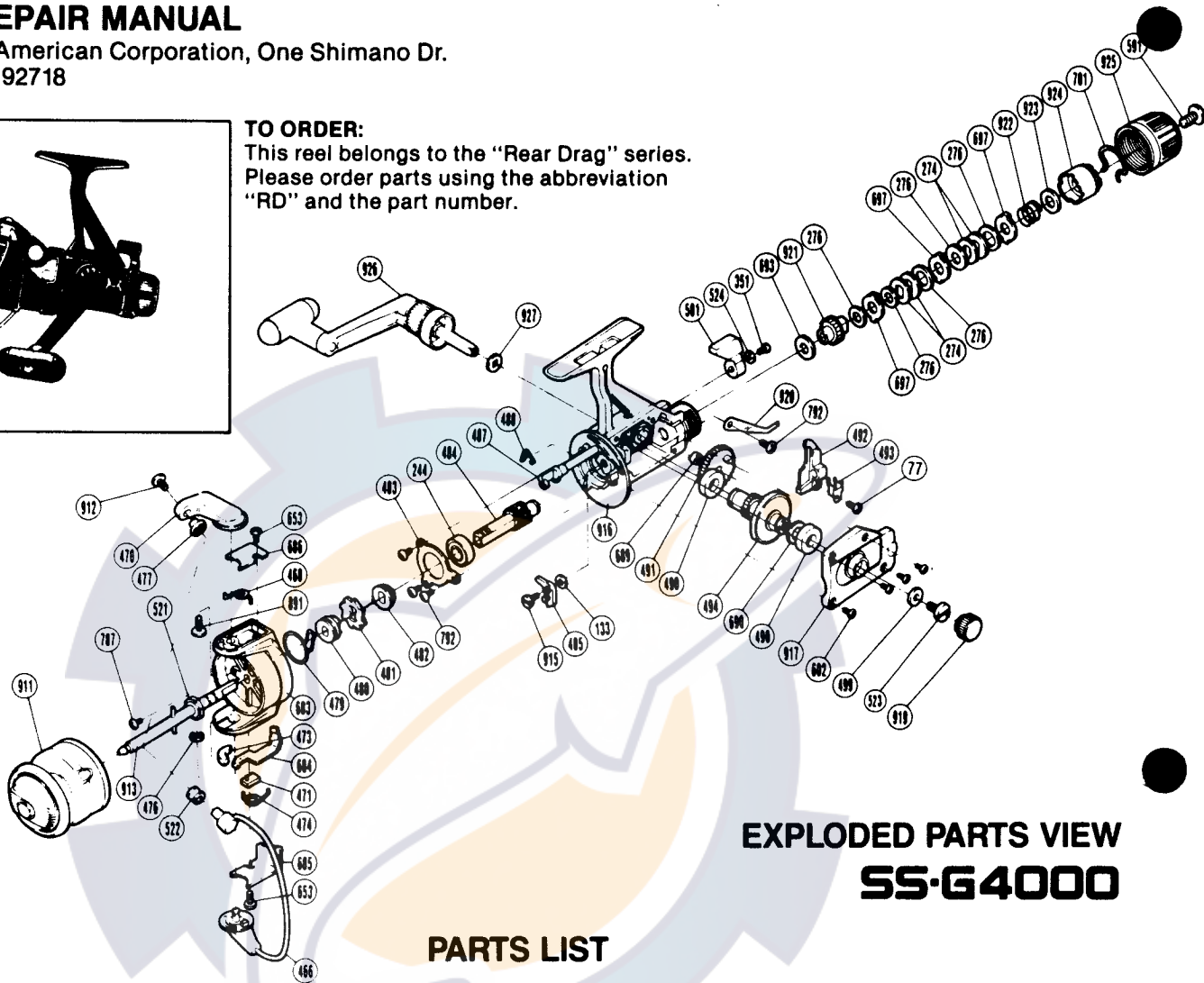

EXPLODED PARTS VIEW SS-G4000

PARTS LIST

PART # DESCRIPTION

- 77. Slider Retainer Screw
- 133. Anti-Reverse Pawl Spacer
- 244. Ball Bearing
- 274. Key Washer "A"
- 276. Drag Washer "C₁"
- 351. Anti-Reverse Lever Screw
- 466. Bail Assembly
- 468. Bail Spring
- 470. Bail Arm
- 471. Trip Lever Guide
- 473. Bail Trip Slide Cam
- 474. Lever Spring
- 476. "E" Lock
- 477. Line Roller Washer
- 479. Anti-Reverse Pawl Spring
- 480. Anti-Reverse Spring Holder
- 481. Anti-Reverse Ratchet
- 482. Pinion Spacer A
- 483. Bearing Retainer
- 484. Pinion Gear
- 485. Anti-Reverse Pawl
- 487. Anti-Reverse Cam

PART # DESCRIPTION

- 488. Anti-Reverse Cam Spring
- 490. Bushing
- 491. Oscillating Gear
- 492. Oscillating Slider
- 493. Oscillating Slider Retainer
- 494. Drive Gear
- 499. Handle Lock Washer
- 501. Anti-Reverse Lever
- 521. Rotor Nut
- 522. Line Roller
- 523. Handle Lock Screw
- 524. Lock Washer
- 591. Drag Knob Screw
- 602. Side Cover Screw
- 653. Bail Trip Cover Screw
- 683. Rotor
- 684. Bail Trip Lever
- 685. Bail Trip Cover
- 686. Bail Spring Cover
- 689. Oscillating Gear Bushing
- 690. Drive Gear Washer

PART # DESCRIPTION

- 693. Drag Washer "C₂"
- 697. Eared Washer "B"
- 701. Hold Click Spring
- 787. Nut Lock Screw
- 792. Multi Purpose Screw
- 891. Bail Arm Screw
- 911. Spool Assembly(Universal)
- 912. Line Roller Screw
- 913. Main Shaft
- 915. Anti-Reverse Pawl Screw
- 916. Body
- 917. Side Cover
- 919. Handle Screw Cap
- 920. Drag Click
- 921. Drag Shaft
- 922. Drag Coil Spring
- 923. Drag Spring Washer "A"
- 924. Pressure Screw
- 925. Drag Knob
- 926. Handle Assembly
- 927. Handle Lock Spacer