

# SHIMANO

## SLX

## SLX150A

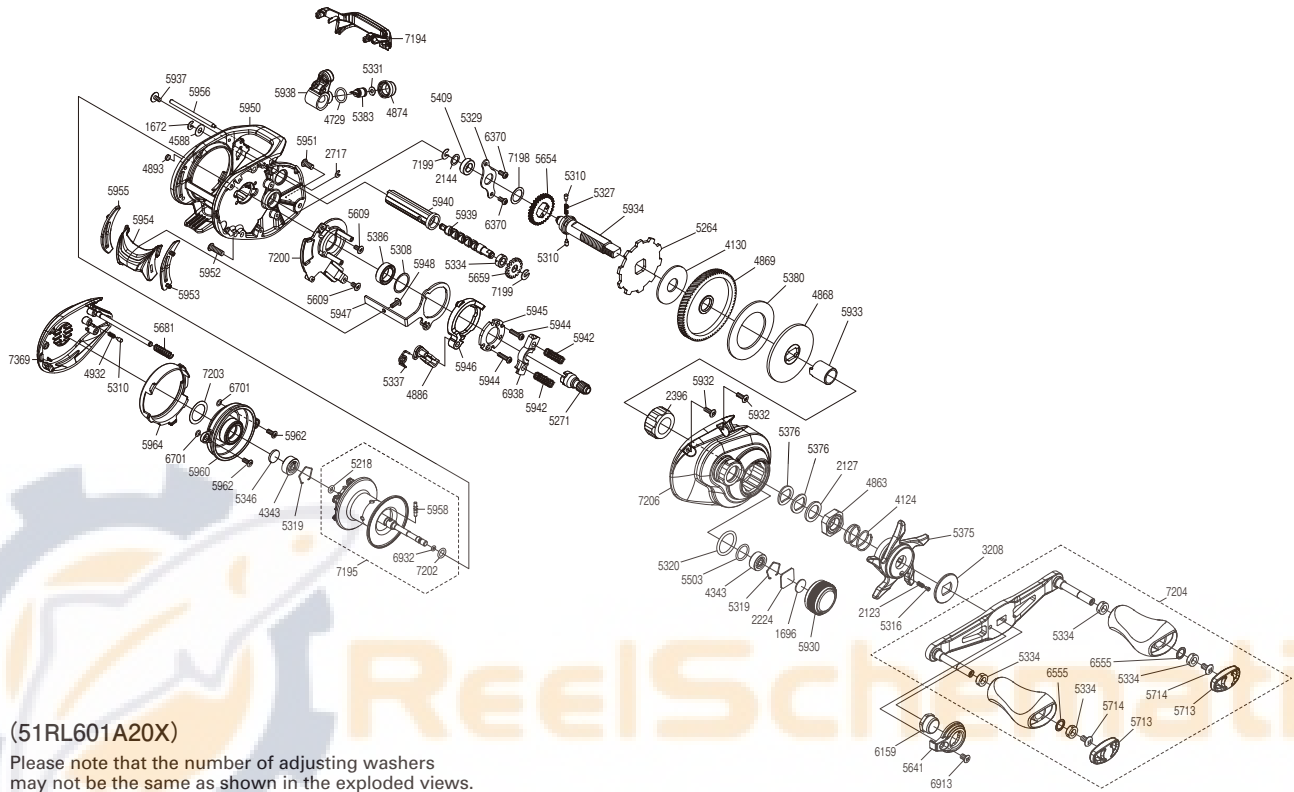

(51RL601A20X)

Please note that the number of adjusting washers may not be the same as shown in the exploded views. (Adjustment will vary with each individual product.)

Part No.	Description	Part No.	Description	Part No.	Description
BNT1672	E Lock	BNT5331	Spacer	BNT5948	Screw
BNT1696	Cast Control Spacer B	BNT5334	Bushing	BNT5950	Frame
BNT2123	Click Spring	BNT5337	Clutch Pawl Spring	BNT5951	Screw
BNT2127	Star Drag Spacer	BNT5346	Spacer	BNT5952	Screw
BNT2144	Drive Shaft Washer	BNT5375	Star Drag	BNT5953	Clutch Bar Guide B
BNT2224	Cast Control Spacer A	BNT5376	Drag Spring Washer	BNT5954	Clutch Button
BNT2396	Roller Clutch Bearing	BNT5380	Drag Washer C	BNT5955	Clutch Bar Guide A
BNT2717	E Lock	BNT5383	Line Guide Pawl	BNT5956	Stabilizer Bar
BNT3208	Star Drag Click Plate	BNT5386	Ball Bearing	BNT5958	Spool Clutch Pin
BNT4124	Star Drag Spring	BNT5409	Drive Shaft Bushing	BNT5960	Dial Case
BNT4130	Drag Washer A	BNT5503	O Ring	BNT5962	Screw
BNT4343	Ball Bearing	BNT5609	Screw	BNT5964	Left Side Plate Cam Lever
BNT4588	Washer	BNT5641	Handle Nut Plate	BNT6159	Handle Nut
BNT4729	O Ring	BNT5654	Idle Gear A	BNT6370	Screw
BNT4863	Star Drag Nut	BNT5659	Idle Gear C	BNT6555	Washer
BNT4868	Key Washer	BNT5681	Spring	BNT6701	Spacer
BNT4869	Drive Gear	BNT5713	Handle Knob Seal	BNT6913	Screw
BNT4874	Pawl Cap	BNT5714	Screw	BNT6932	O Ring
BNT4886	Clutch Pawl Assembly	BNT5930	Cast Control Cap	BNT6938	Yoke
BNT4893	Washer	BNT5932	Screw	BNT7194	Level Wind Protector
BNT4932	Click Spring	BNT5933	Roller Clutch Inner Tube	BNT7195	Spool Assembly
BNT5218	O Ring	BNT5934	Drive Shaft	BNT7198	Washer
BNT5264	Anti-Reverse Ratchet	BNT5937	Screw	BNT7199	E Lock
BNT5271	Pinion Gear	BNT5938	Line Guide Assembly	BNT7200	Clutch Guard
BNT5308	Washer	BNT5939	Worm Shaft	BNT7202	O Ring
BNT5310	Idle Gear Pin	BNT5940	Level Wind Guard	BNT7203	Washer
BNT5316	Click Pin	BNT5942	Yoke Spring	BNT7204	Handle Assembly
BNT5319	Bearing Retainer	BNT5944	Screw	BNT7206	Right Side Plate
BNT5320	O Ring	BNT5945	Clutch Cam Retainer	BNT7369	Left Side Plate
BNT5327	Idle Gear Spring	BNT5946	Clutch Cam		
BNT5329	Drive Shaft Retainer	BNT5947	Clutch Plate		