

1989 REPAIR MANUAL

Shimano American Corporation, One Shimano Dr.
Irvine, CA 92718

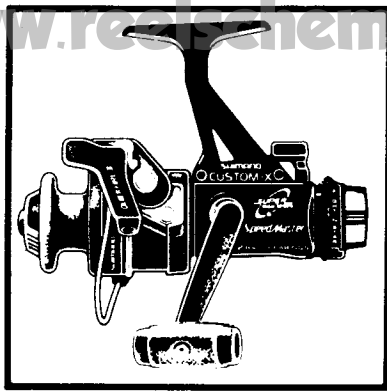

EXPLODED PARTS VIEW
SpeedMaster CX1000SQ

※ Please look here
for (89) mark here

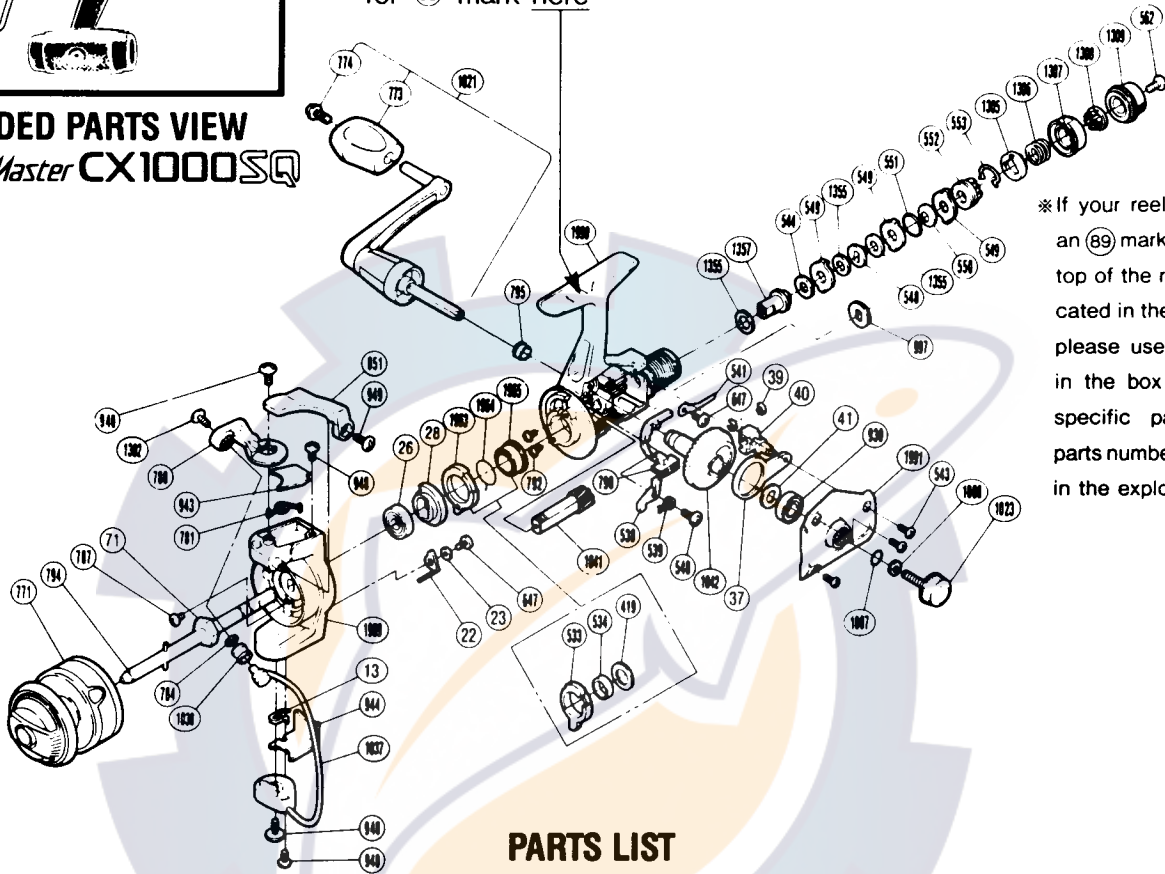

※ If your reel does not have an (89) mark molded on the top of the reel foot as indicated in the exploded view, please use the parts view in the box to order these specific parts. All other parts numbers are as shown in the exploded view.

PARTS LIST

PART # DESCRIPTION

- RD 0013 (Trip) Lever Spring
- RD 0022 (Bail) Trip Lever
- RD 0023 Trip Lever Spacer
- RD 0026 Ball Bearing
- RD 0028 Anti-Reverse Ratchet
- RD 0037 Oscillating Arm
- RD 0039 "C" Lock
- RD 0040 Oscillating Block
- RD 0041 Drive Gear Washer
- RD 0071 Rotor Nut
- RD 0419 Bushing Washer (B)
- RD 0533 Anti-Reverse Lock Out
- RD 0534 Pinion Spacer
- RD 0538 Anti-Reverse Pawl
- RD 0539 Anti-Reverse Pawl Spring
- RD 0540 Anti-Reverse Pawl Screw
- RD 0541 Drag Click
- RD 0543 Side Cover Screw (B)
- RD 0544 Drag Washer "C2" (White)
- RD 0548 Key Washer "A"
- RD 0549 Eared Washer "B"
- RD 0550 Coned Disc Spring
- RD 0551 "O" Ring

PART # DESCRIPTION

- RD 0552 Pressure Screw
- RD 0553 Hold Click Spring
- RD 0562 Drag Programmer Screw
- RD 0647 Nut Lock Screw
- RD 0771 Spool Assembly
- RD 0773 Handle Knob
- RD 0774 Handle Knob Screw
- RD 0780 Bail Arm
- RD 0781 Bail Spring
- RD 0784 Line Roller Washer
- RD 0787 Nut Lock Screw
- RD 0790 Anti-Reverse Switch (Black)
- RD 0792 Bearing Retainer Screw
- RD 0794 Main Shaft
- RD 0795 Bushing B
- RD 0851 Quick-Fire II Trigger
- RD 0930 Ball Bearing
- RD 0940 Bail Trip Cam Screw
- RD 0943 Bail Spring Cover
- RD 0944 Bail Trip Cover
- RD 0948 Bail Trip Cover Screw
- RD 0949 Trigger Screw
- RD 0997 Click Gear

PART # DESCRIPTION

- RD 1007 Lock Washer Retainer
- RD 1008 Handle Lock Washer
- RD 1021 Handle Assembly
- RD 1023 Handle Screw Cap
- RD 1037 Bail Assembly
- RD 1038 Sic Ceramic Roller
- RD 1041 Pinion Gear
- RD 1042 Drive Gear
- RD 1302 Line Roller Screw
- RD 1305 Pre-Set Spring Cover
- RD 1306 Pre-Set Spring
- RD 1307 Pre-Set Ring
- RD 1308 Pre-Set Cam
- RD 1309 Drag Knob
- RD 1355 Drag Washer "C1"
- RD 1357 Drag Shaft
- RD 1963 Anti-Reverse Lock Out
- RD 1964 Anti-Reverse Lock Out Spring
- RD 1965 Pinion Spacer
- RD 1989 Rotor
- RD 1990 Body
- RD 1991 Side Cover