

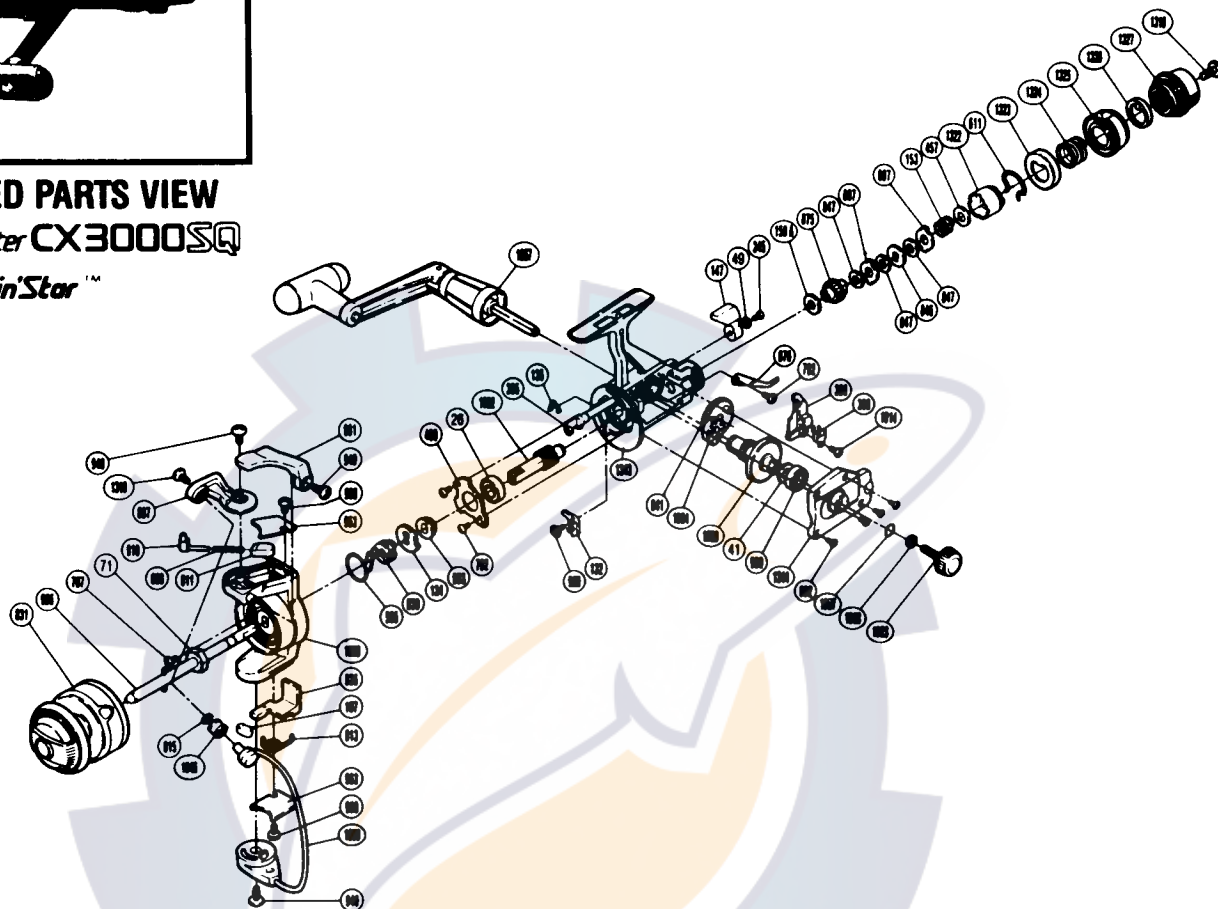

### EXPLODED PARTS VIEW

*SpeedMaster CX3000SQ*

with *Fightin' Star™*



### PARTS LIST

**PART # DESCRIPTION**

- RD 0026 Ball Bearing
- RD 0041 Drive Gear Washer
- RD 0049 Lock Washer
- RD 0071 Rotor Nut
- RD 0132 Anti-Reverse Pawl Assembly
- RD 0134 Anti-Reverse Ratchet
- RD 0136 Anti-Reverse Cam Spring
- RD 0147 Anti-Reverse Lever
- RD 0150A Drag Washer "C2" (White)
- RD 0153 Drag (Coil) Spring
- RD 0197 Bail Trip Slide Cam
- RD 0345 Anti-Reverse Lever Screw
- RD 0385 Anti-Reverse Cam
- RD 0389 Oscillating Slider Retainer
- RD 0390 Oscillating Slider
- RD 0457 Drag Spring Washer "A"
- RD 0459 Bearing Retainer
- RD 0595 Anti-Reverse Pawl Spring
- RD 0602 Side Cover Screw A
- RD 0607 Eared Washer "B"
- RD 0611 Hold Click Spring
- RD 0787 Nut Lock Screw
- RD 0792 Bearing Retainer Screw

**PART # DESCRIPTION**

- RD 0807 Bail Arm
- RD 0808 Bail Spring
- RD 0810 Bail Spring Guide A
- RD 0811 Bail Spring Guide B
- RD 0813 Lever Spring
- RD 0815 Line Roller Washer
- RD 0831 Spool Assembly (Universal)
- RD 0836 Bail Trip Lever
- RD 0839 Anti-Reverse Spring Holder
- RD 0841 Oscillating Gear
- RD 0846 Key Washer "A"
- RD 0847 Drag Washer "H1"
- RD 0861 Quick-Fire II Trigger
- RD 0875 Drag Shaft
- RD 0876 Drag Click
- RD 0903 Pinion Spacer
- RD 0930 Ball Bearing
- RD 0940 Bail Trip Cam Screw
- RD 0949 Trigger Screw
- RD 0953 Bail Spring Cover
- RD 0958 Bail Trip Cover Screw
- RD 0963 Bail Trip Cover
- RD 0966 Main Shaft

**PART # DESCRIPTION**

- RD 0999 Anti-Reverse Pawl Screw
- RD 1004 Bushing A
- RD 1007 Lock Washer Retainer
- RD 1008 Handle Lock Washer
- RD 1014 Slider Retainer Screw
- RD 1023 Handle Screw Cap
- RD 1046 Sic Ceramic Roller
- RD 1057 Handle Assembly
- RD 1058 Rotor
- RD 1059 Bail Assembly
- RD 1062 Pinion Gear
- RD 1063 Drive Gear
- RD 1310 Line Roller Screw
- RD 1319 Drag Knob Screw
- RD 1322 Pressure Screw
- RD 1323 Pre-Set Spring Cover
- RD 1324 Pre-Set Spring
- RD 1325 Pre-Set Ring
- RD 1326 Pre-Set Cam
- RD 1327 Drag Knob
- RD 1343 Body
- RD 1344 Side Cover