

# SHIMANO

*SpeedMaster*

**SPM10II**

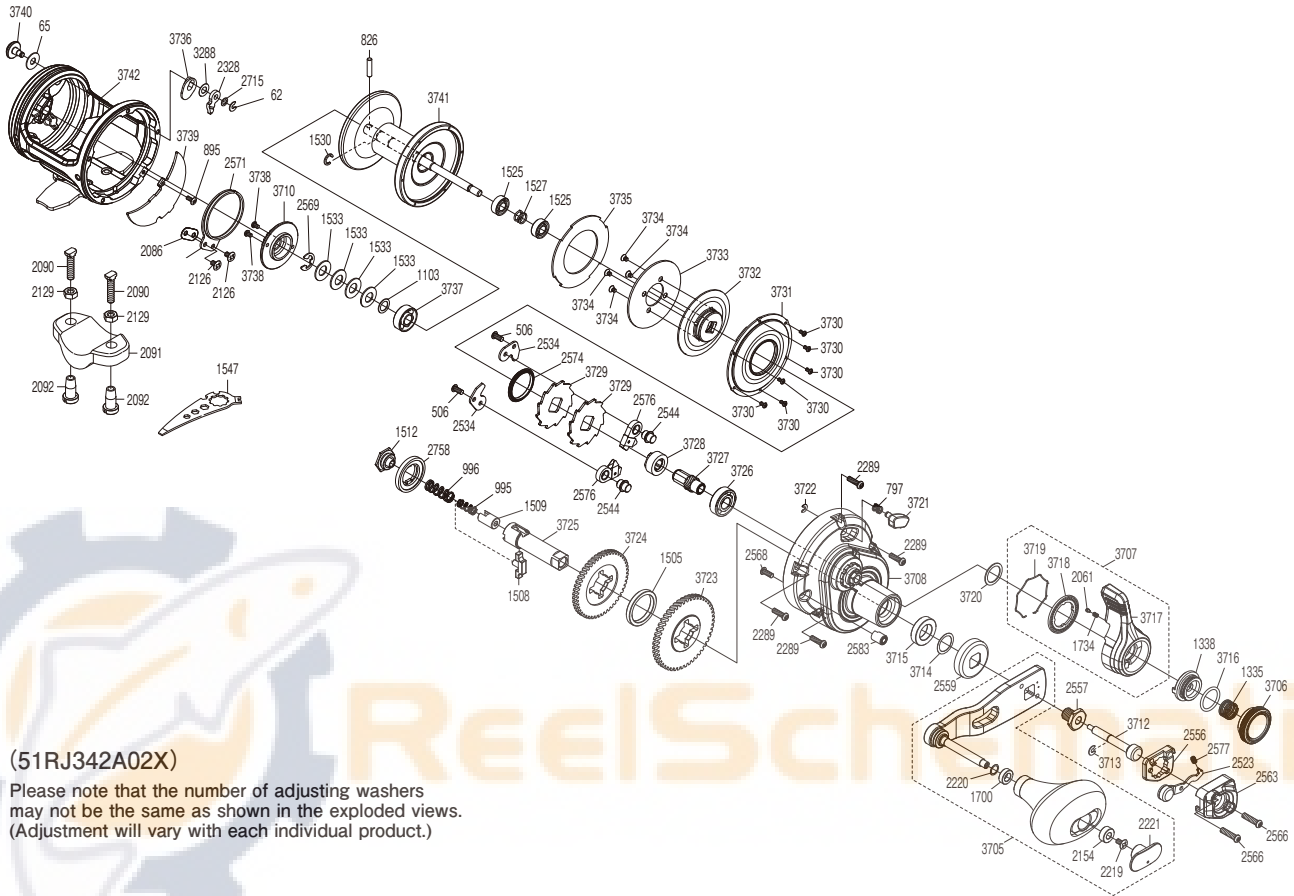

(51RJ342A02X)

Please note that the number of adjusting washers may not be the same as shown in the exploded views. (Adjustment will vary with each individual product.)

| Part No. | Description             | Part No. | Description                 | Part No. | Description                 |
|----------|-------------------------|----------|-----------------------------|----------|-----------------------------|
| TGT0062  | E Lock                  | TGT2534  | Anti Reverse Pawl Keeper    | TGT3721  | Strike Stop                 |
| TGT0065  | Washer                  | TGT2544  | Anti Reverse Pawl Pin       | TGT3722  | E Lock                      |
| TGT0506  | Screw                   | TGT2556  | Handle Nut Plate            | TGT3723  | Drive Gear A                |
| TGT0797  | Pressure Spring         | TGT2557  | Handle Bolt                 | TGT3724  | Drive Gear B                |
| TGT0826  | Cross Pin               | TGT2559  | Drive Shaft Shield          | TGT3725  | Drive Shaft                 |
| TGT0895  | Screw                   | TGT2563  | Push Button Shield          | TGT3726  | Ball Bearing                |
| TGT0995  | Drive Shaft Spring B    | TGT2566  | Screw                       | TGT3727  | Pinion Gear A               |
| TGT0996  | Drive Shaft Spring      | TGT2568  | Screw                       | TGT3728  | Pinion Gear B               |
| TGT1103  | Washer                  | TGT2569  | E Lock                      | TGT3729  | Anti Reverse Ratchet        |
| TGT1335  | Dial Spring             | TGT2571  | Click Spring                | TGT3730  | Screw                       |
| TGT1338  | Lever Shaft Body        | TGT2574  | Waterproof Ring             | TGT3731  | Cooling Shield              |
| TGT1505  | Drive Gear Washer C     | TGT2576  | Anti Reverse Pawl           | TGT3732  | Pinion Guard                |
| TGT1508  | Gear Select Cross Bar   | TGT2577  | Slide Plate Spring          | TGT3733  | Drag Plate                  |
| TGT1509  | Cross Bar Stop          | TGT2583  | Bolt Shield                 | TGT3734  | Screw                       |
| TGT1512  | Drive Shaft Screw       | TGT2715  | Washer                      | TGT3735  | Drag Washer                 |
| TGT1525  | Ball Bearing            | TGT2758  | Drive Gear Washer A         | TGT3736  | Click Switch Cam            |
| TGT1527  | Pressure Release Spring | TGT3288  | Washer                      | TGT3737  | Ball Bearing                |
| TGT1530  | C Lock                  | TGT3705  | Handle Assembly             | TGT3738  | Screw                       |
| TGT1533  | Coned Disc Spring       | TGT3706  | Pre-Program Dial Assembly   | TGT3739  | Set Plate Sticker           |
| TGT1700  | Bushing                 | TGT3707  | Drag Control Lever Assembly | TGT3740  | Click Button                |
| TGT1734  | Click Spring            | TGT3708  | Right Side Plate Assembly   | TGT3741  | Spool Assembly              |
| TGT2061  | Lever Click             | TGT3710  | Click Gear Assembly         | TGT3742  | Frame Assembly              |
| TGT2086  | Click Spring Washer     | TGT3712  | Push Low Button Shaft       |          |                             |
| TGT2126  | Screw                   | TGT3713  | E Lock                      | TGT2090  | Rod Clamp Bolt (Accessory)  |
| TGT2154  | Bushing                 | TGT3714  | Washer                      | TGT2129  | Rod Clamp Nut B (Accessory) |
| TGT2219  | Screw                   | TGT3715  | Drive Gear Bush             | TGT2091  | Rod Clamp (Accessory)       |
| TGT2220  | Washer                  | TGT3716  | O Ring                      | TGT2092  | Rod Clamp Nut A (Accessory) |
| TGT2221  | Handle Knob Seal        | TGT3717  | Drag Control Lever          |          |                             |
| TGT2289  | Screw                   | TGT3718  | Click Plate                 |          |                             |
| TGT2328  | Click Pawl              | TGT3719  | Click Plate Retainer        |          |                             |
| TGT2523  | Slide Plate             | TGT3720  | Lever Thrust Washer         | TGT1547  | Wrench                      |