

# SHIMANO

STRADIC  A-RB

ST-1000FI

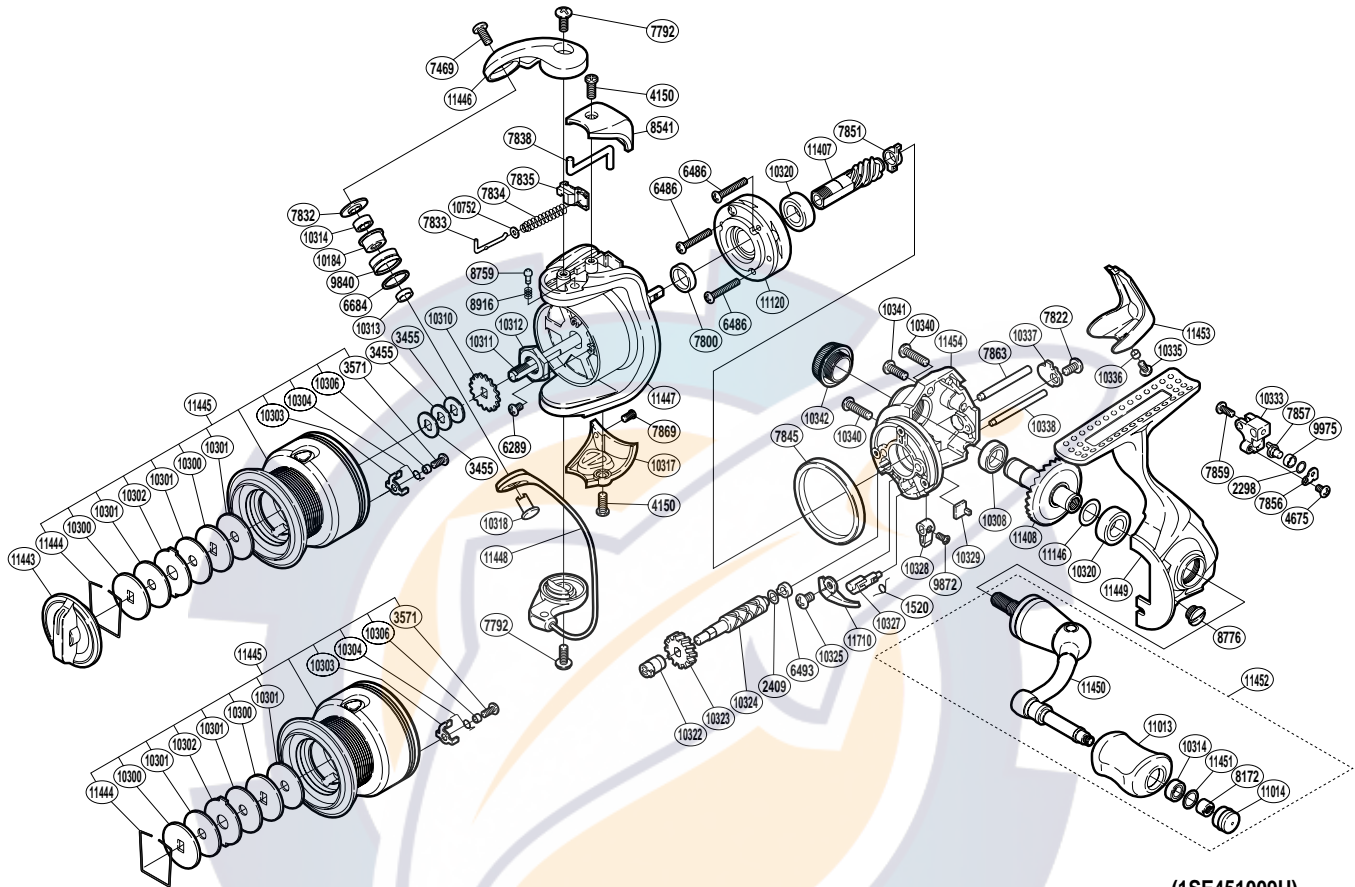

(1SE451009U)

| Part No. | Description             | Part No. | Description                | Part No. | Description            |
|----------|-------------------------|----------|----------------------------|----------|------------------------|
| RD 1520  | Anti-Reverse Cam Spring | RD 8759  | Click Pin                  | RD10333  | Oscillating Slider     |
| RD 2298  | Spacer                  | RD 8776  | Oil Cap                    | RD10335  | Screw                  |
| RD 2409  | Spacer                  | RD 8916  | Click Spring               | RD10336  | Rear Protector Collar  |
| RD 3455  | Spool Washer            | RD 9840  | Line Roller                | RD10337  | Worm Shaft Retainer    |
| RD 3571  | Screw                   | RD 9872  | Screw                      | RD10338  | Oscillating Guide B    |
| RD 4150  | Screw                   | RD 9975  | Oscillating Slider Bushing | RD10340  | Screw                  |
| RD 4675  | Screw                   | RD10184  | Line Roller Bushing        | RD10341  | Screw                  |
| RD 6289  | Screw                   | RD10300  | Key Washer                 | RD10342  | Handle Screw Cap       |
| RD 6486  | Screw                   | RD10301  | Drag Washer                | RD10752  | Spring Guide A Support |
| RD 6493  | Worm Bushing (rear)     | RD10302  | Eared Washer               | RD11013  | Handle Knob            |
| RD 6684  | Line Roller Spacer      | RD10303  | Drag Click                 | RD11014  | Handle Knob Seal       |
| RD 7469  | Screw                   | RD10304  | Drag Click Spring          | RD11120  | Roller Clutch Assembly |
| RD 7792  | Screw                   | RD10306  | Drag Click Collar          | RD11146  | Washer                 |
| RD 7800  | Rotor Ring              | RD10308  | Ball Bearing               | RD11407  | Pinion Gear            |
| RD 7822  | Screw                   | RD10310  | Spool Support              | RD11408  | Drive Gear             |
| RD 7832  | Line Roller Washer      | RD10311  | Main Shaft                 | RD11443  | Drag Knob              |
| RD 7833  | Bail Spring Guide A     | RD10312  | Rotor Nut                  | RD11444  | Drag Washers Retainer  |
| RD 7834  | Bail Spring             | RD10313  | Bearing Spacer             | RD11445  | Spool Assembly         |
| RD 7835  | Bail Spring Seat        | RD10314  | Ball Bearing               | RD11446  | Bail Arm               |
| RD 7838  | Bail Trip Lever         | RD10317  | Bail Hold Support Guard    | RD11447  | Rotor                  |
| RD 7845  | Friction Ring           | RD10318  | Line Roller Support        | RD11448  | Bail Assembly          |
| RD 7851  | Bushing                 | RD10320  | Ball Bearing               | RD11449  | Side Cover             |
| RD 7856  | Oscillating Pawl Cover  | RD10322  | Worm Bushing (front)       | RD11450  | Handle Shank Assembly  |
| RD 7857  | Oscillating Pawl        | RD10323  | Idle Gear                  | RD11451  | Washer                 |
| RD 7859  | Screw                   | RD10324  | Worm Shaft                 | RD11452  | Handle Assembly        |
| RD 7863  | Oscillating Guide A     | RD10325  | Screw                      | RD11453  | Rear Protector         |
| RD 7869  | Screw                   | RD10327  | Anti-Reverse Cam           | RD11454  | Body                   |
| RD 8172  | Handle Knob Nut         | RD10328  | Anti-Reverse Lever         | RD11710  | Bail Trip Strike       |
| RD 8541  | Bail Spring Cover       | RD10329  | Anti-Reverse Lever Cover   |          |                        |