

EXPLODED PARTS VIEW



6-10#A

SHIMANO®

1990 REPAIR MANUAL

Shimano American Corporation, One Shimano Dr. Irvine, CA 92718

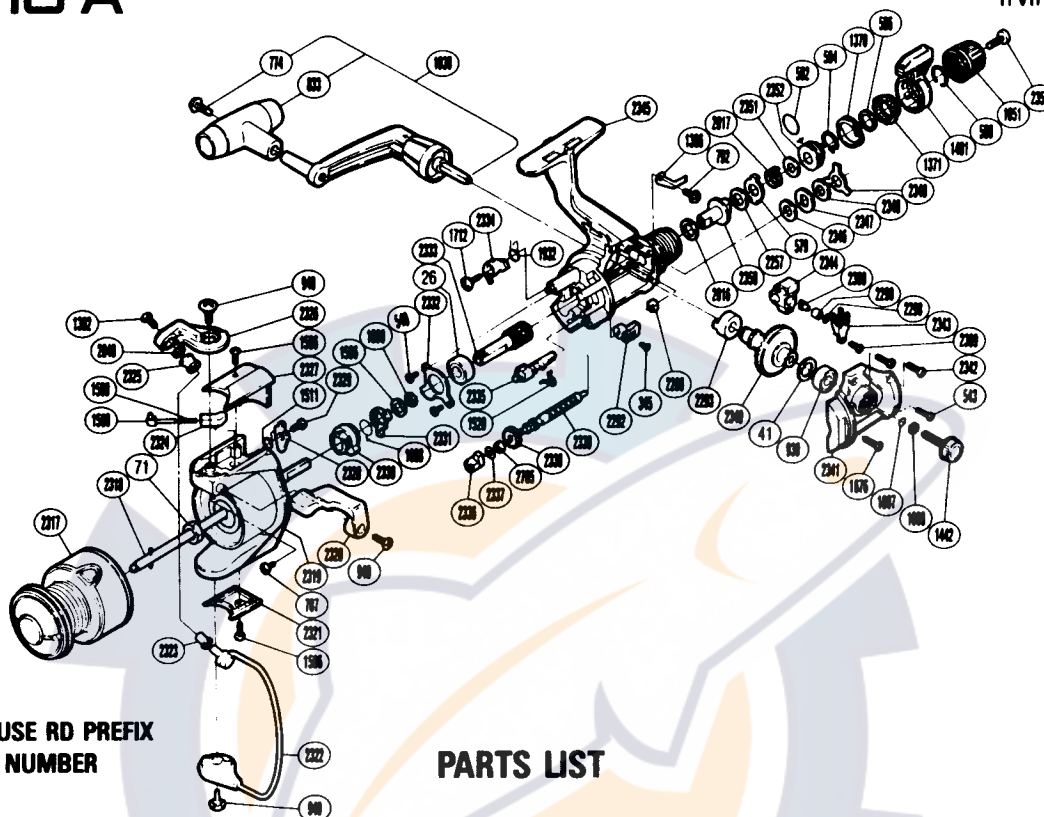

TO ORDER: USE RD PREFIX WITH PART NUMBER

PARTS LIST

| RD # | DESCRIPTION | RD # | DESCRIPTION | RD # | DESCRIPTION |
|------|--------------------------------|------|------------------------------|------|-----------------------------|
| 0026 | Ball Bearing | 1509 | Bail Spring | 2326 | Arm Cam |
| 0041 | Drive Gear Washer | 1511 | Lever Spring | 2327 | Bail Spring Cover |
| 0071 | Rotor Nut | 1520 | Anti-Reverse Cam Spring | 2328 | Bail Trip Lever |
| 0345 | Anti-Reverse Lever Screw | 1596 | Bushing Washer | 2329 | Bail Trip Lever Screw |
| 0540 | Anti-Reverse Pawl Screw | 1676 | Side Cover Screw | 2330 | Anti-Reverse Ratchet |
| 0543 | Side Cover Screw (B) | 1712 | Anti-Reverse Pawl Screw | 2331 | Anti-Reverse Lock Out |
| 0579 | Eared Washer "B" | 1888 | Anti-Reverse Lock Out Spring | 2332 | Bearing Retainer |
| 0582 | "O" Ring | 1890 | Bushing Washer | 2333 | Pinion Gear |
| 0584 | Hold Click Spring | 1932 | Anti-Reverse Pawl Spring | 2334 | Anti-Reverse Pawl |
| 0586 | Fightin' Pressure Screw Washer | 2016 | Drag Washer "H2" (White) | 2335 | Anti-Reverse Cam |
| 0589 | Lever Hold Spring | 2017 | Drag Coil Spring | 2336 | Worm Bearing (Front) |
| 0774 | Handle Knob Screw | 2048 | Line Roller Washer | 2337 | Worm Shaft Spacer |
| 0787 | Nut Lock Screw | 2257 | Drag Washer "H1" | 2338 | Idle Gear |
| 0792 | Bearing Retainer Screw | 2288 | Worm Bearing | 2339 | Worm Shaft |
| 0833 | Handle Knob | 2292 | Anti-Reverse Lever | 2340 | Drive Gear |
| 0930 | Ball Bearing | 2293 | Drive Gear Bushing | 2341 | Side Cover |
| 0940 | Bail Trip Cam Screw | 2298 | Spacer | 2342 | Side Cover Screw (B) |
| 0949 | Trigger Screw | 2299 | Oscillating Slider Bushing | 2343 | Oscillating Slider Retainer |
| 1007 | Lock Washer Retainer | 2300 | Oscillating Pawl | 2344 | Oscillating Slider |
| 1008 | Handle Lock Washer | 2309 | Slider Retainer Screw | 2345 | Body |
| 1030 | Handle Assembly | 2317 | Spool Assembly | 2346 | Drag Washer "C2" (White) |
| 1051 | Drag Knob | 2318 | Main Shaft | 2347 | Click Gear |
| 1302 | Line Roller Screw | 2319 | Rotor | 2348 | Drag Washer (C1) |
| 1366 | Drag Click | 2320 | Quick-Fire II Trigger | 2349 | Eared Washer "BF" |
| 1370 | Lever Click Gear | 2321 | Rotor Side Cover | 2350 | Drag Shaft |
| 1371 | Fightin' Pressure Screw | 2322 | Bail Assembly | 2351 | Drag Spring Washer |
| 1401 | Fightin' Drag II Lever | 2323 | Line Roller Bushing | 2352 | Pressure Screw |
| 1442 | Handle Screw Cap | 2324 | Bail Spring Guide (B) | 2353 | Drag Programmer Screw |
| 1506 | Bail Spring Cover Screw | 2325 | Sic Ceramic Roller | 2705 | Idle Gear Spacer |
| 1508 | Bail Spring Guide A | | | | |

Prices and specifications subject to change without notice.

1/1990