

EXPLODED PARTS VIEW



SHIMANO®

1990 REPAIR MANUAL

Shimano American Corporation, One Shimano Dr.  
Irvine, CA 92718

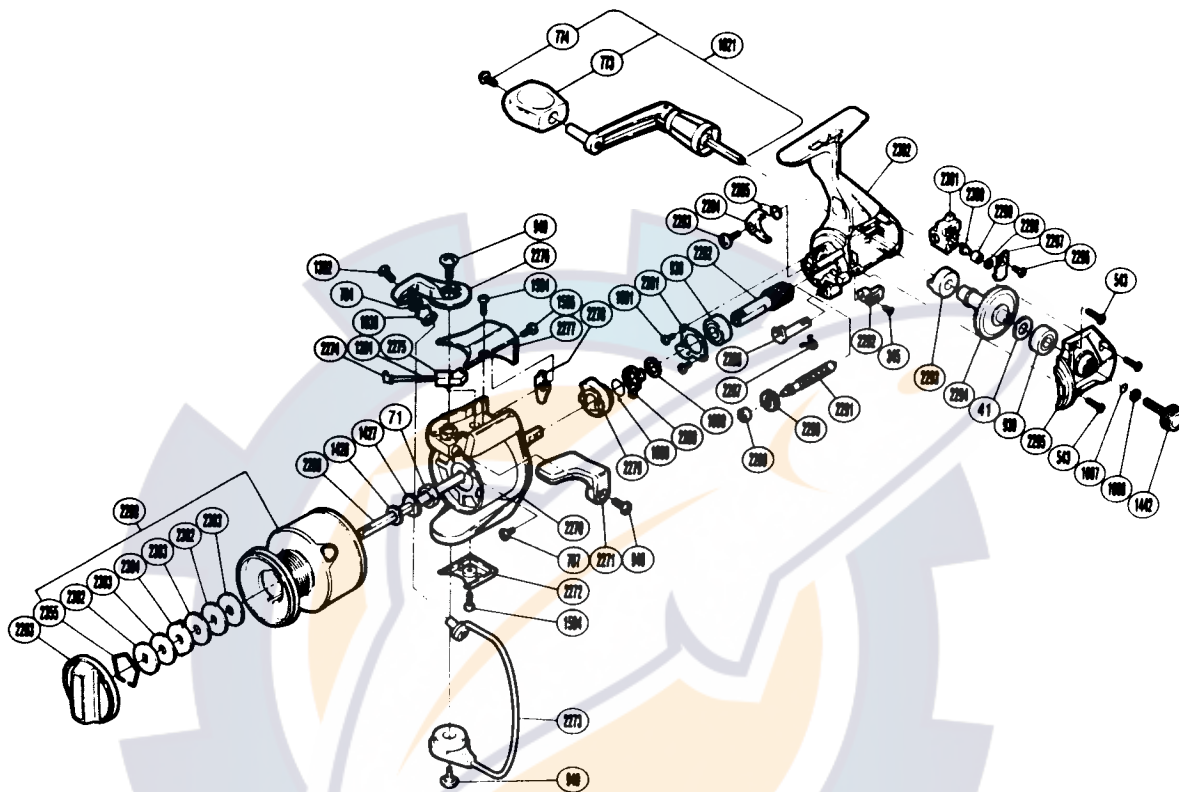

TO ORDER: USE RD PREFIX  
WITH PART NUMBER

PARTS LIST

RD #	DESCRIPTION
0041	Drive Gear Washer
0071	Rotor Nut
0345	Anti-Reverse Lever Screw
0543	Side Cover Screw (B)
0773	Handle Knob
0774	Handle Knob Screw
0784	Line Roller Washer
0787	Nut Lock Screw
0930	Ball Bearing
0940	Bail Trip Cam Screw
0949	Trigger Screw
1007	Lock Washer Retainer
1008	Handle Lock Washer
1021	Handle Assembly
1038	Sic Ceramic Roller
1201	Bail Spring
1302	Line Roller Screw
1426	Spool Washer
1427	Spool Support
1442	Handle Screw Cap
1504	Bail Hold Cover Screw
1506	Bail Spring Cover Screw

RD #	DESCRIPTION
1888	Anti-Reverse Lock Out Spring
1890	Bushing Washer
1891	Multi Purpose Screw
2263	Drag Knob
2268	Spool Assembly
2269	Main Shaft
2270	Rotor
2271	Quick-Fire II Trigger
2272	Rotor Side Cover
2273	Bail Assembly
2274	Bail Spring Guide (A)
2275	Bail Spring Guide (B)
2276	Bail Arm
2277	Bail Spring Cover
2278	Bail Trip Lever
2279	Anti-Reverse Ratchet
2280	Anti-Reverse Lock Out
2281	Bearing Retainer
2282	Pinion Gear
2283	Anti-Reverse Pawl Screw
2284	Anti-Reverse Pawl

RD #	DESCRIPTION
2285	Anti-Reverse Pawl Spring
2286	Anti-Reverse Cam
2287	Anti-Reverse Cam Spring
2288	Worm Bearing
2290	Idle Gear
2291	Worm Shaft
2292	Anti-Reverse Lever
2293	Drive Gear Bushing
2294	Drive Gear
2295	Side Cover
2296	Slider Retainer Screw
2297	Oscillating Pawl Cover
2298	Spacer
2299	Oscillating Slider Bushing
2300	Oscillating Pawl
2301	Oscillating Slider
2302	Body
2355	Drag Washers Retainer
2382	Key Washer
2383	Drag Washer
2384	Eared Washer

Prices and specifications subject to change without notice.

1/1990