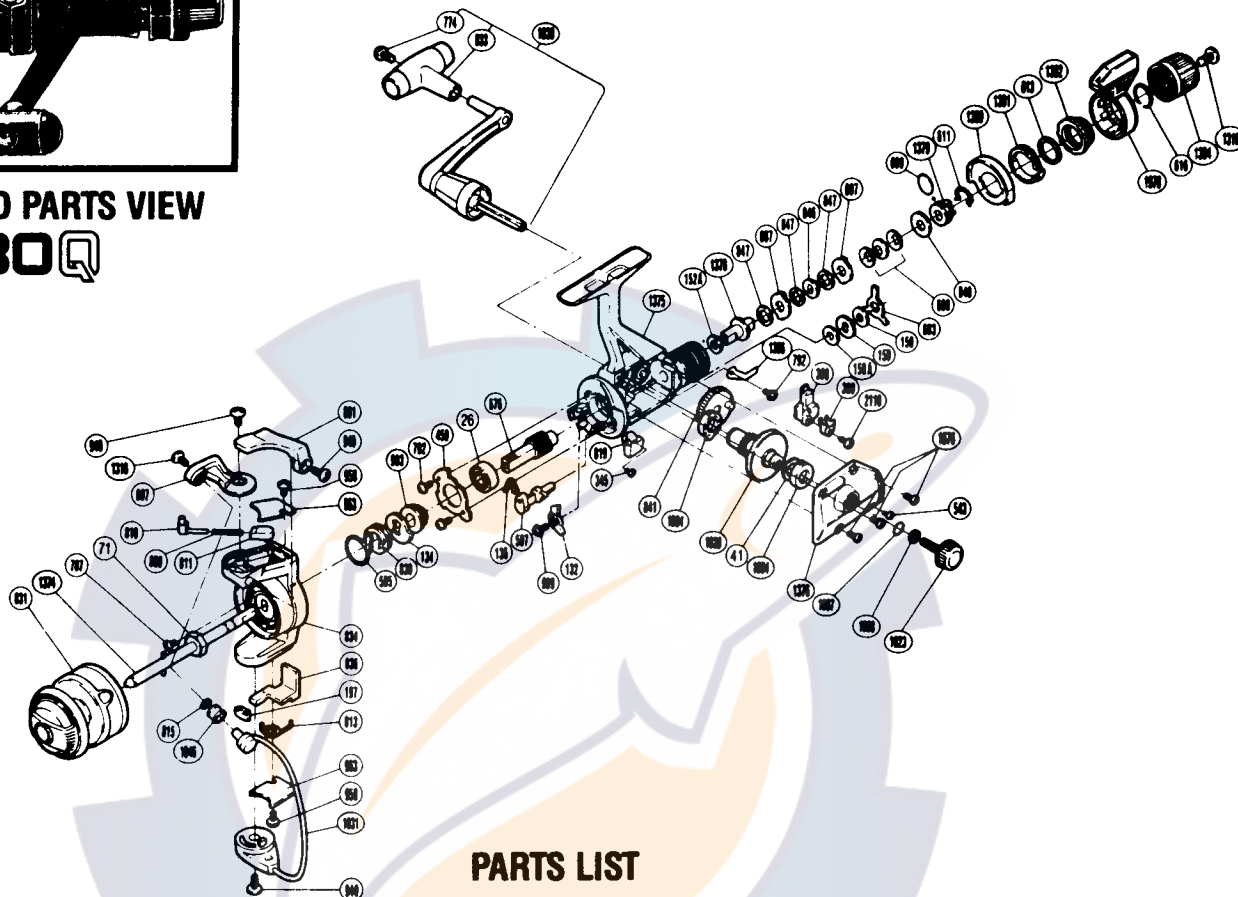
**EXPLODED PARTS VIEW****TX130Q****PARTS LIST****PART # DESCRIPTION**

| | |
|----------|--------------------------------|
| RD 0026 | Ball Bearing |
| RD 0041 | Drive Gear Washer |
| RD 0071 | Rotor Nut |
| RD 0132 | Anti-Reverse Pawl Assembly |
| RD 0134 | Anti-Reverse Ratchet |
| RD 0136 | Anti-Reverse Cam Spring |
| RD 0150 | Drag Washer "C1" (Black) |
| RD 0150A | Drag Washer "C2" (White) |
| RD 0152A | Drag Washer "D2" (White) |
| RD 0159 | Click Gear |
| RD 0197 | Bail Trip Slide Cam |
| RD 0345 | Anti-Reverse Lever Screw |
| RD 0389 | Oscillating Slider Retainer |
| RD 0390 | Oscillating Slider |
| RD 0459 | Bearing Retainer |
| RD 0543 | Side Cover Screw (B) |
| RD 0595 | Anti-Reverse Pawl Spring |
| RD 0597 | Anti-Reverse Cam |
| RD 0603 | Eared Washer "BF" |
| RD 0607 | Eared Washer "B" |
| RD 0608 | Coned Disc Spring |
| RD 0609 | "O" Ring |
| RD 0611 | Hold Click Spring |
| RD 0613 | Fightin' Pressure Screw Washer |
| RD 0616 | Lever Hold Spring |

PART # DESCRIPTION

| | |
|---------|----------------------------|
| RD 0676 | Pinion Gear |
| RD 0774 | Handle Knob Screw |
| RD 0787 | Nut Lock Screw |
| RD 0792 | Bearing Retainer Screw |
| RD 0807 | Bail Arm |
| RD 0808 | Bail Spring |
| RD 0810 | Bail Spring Guide A |
| RD 0811 | Bail Spring Guide B |
| RD 0813 | Lever Spring |
| RD 0815 | Line Roller Washer |
| RD 0819 | Anti-Reverse Lever (Black) |
| RD 0831 | Spool Assembly (Universal) |
| RD 0833 | Handle Knob |
| RD 0834 | Rotor |
| RD 0836 | Bail Trip Lever |
| RD 0839 | Anti-Reverse Spring Holder |
| RD 0841 | Oscillating Gear |
| RD 0846 | Key Washer "A" |
| RD 0847 | Drag Washer "H1" |
| RD 0848 | Drag Spring Washer "A" |
| RD 0861 | Quick-Fire II Trigger |
| RD 0903 | Pinion Spacer |
| RD 0940 | Bail Trip Cam Screw |
| RD 0949 | Trigger Screw |
| RD 0953 | Bail Spring Cover |
| RD 0958 | Bail Trip Cover Screw |

PART # DESCRIPTION

| | |
|---------|-------------------------|
| RD 0963 | Bail Trip Cover |
| RD 0999 | Anti-Reverse Pawl Screw |
| RD 1004 | Bushing A |
| RD 1007 | Lock Washer Retainer |
| RD 1008 | Handle Lock Washer |
| RD 1020 | Drive Gear |
| RD 1023 | Handle Screw Cap |
| RD 1030 | Handle Assembly |
| RD 1031 | Bail Assembly |
| RD 1046 | Sic Ceramic Roller |
| RD 1310 | Line Roller Screw |
| RD 1319 | Drag Knob Screw |
| RD 1366 | Drag Click |
| RD 1374 | Main Shaft |
| RD 1375 | Body |
| RD 1376 | Side Cover |
| RD 1378 | Drag Shaft |
| RD 1379 | Pressure Screw |
| RD 1380 | Lever Quadrant |
| RD 1381 | Lever Click Gear |
| RD 1382 | Fightin' Pressure Screw |
| RD 1384 | Drag Programmer |
| RD 1676 | Side Cover Screw |
| RD 1978 | Fightin' Drag II Lever |
| RD 2110 | Slider Retainer Screw |