

SHIMANO

TRANX SA-RB

TRX201AHG

(51RH611201X)

Please note that the number of adjusting washers may not be the same as shown in the exploded views. (Adjustment will vary with each individual product.)

The (5765) Bearing, (6074) Spool clutch pin, and (4225) Roller clutch cannot be replaced by the customer. To replace these parts, please request after-sales service.

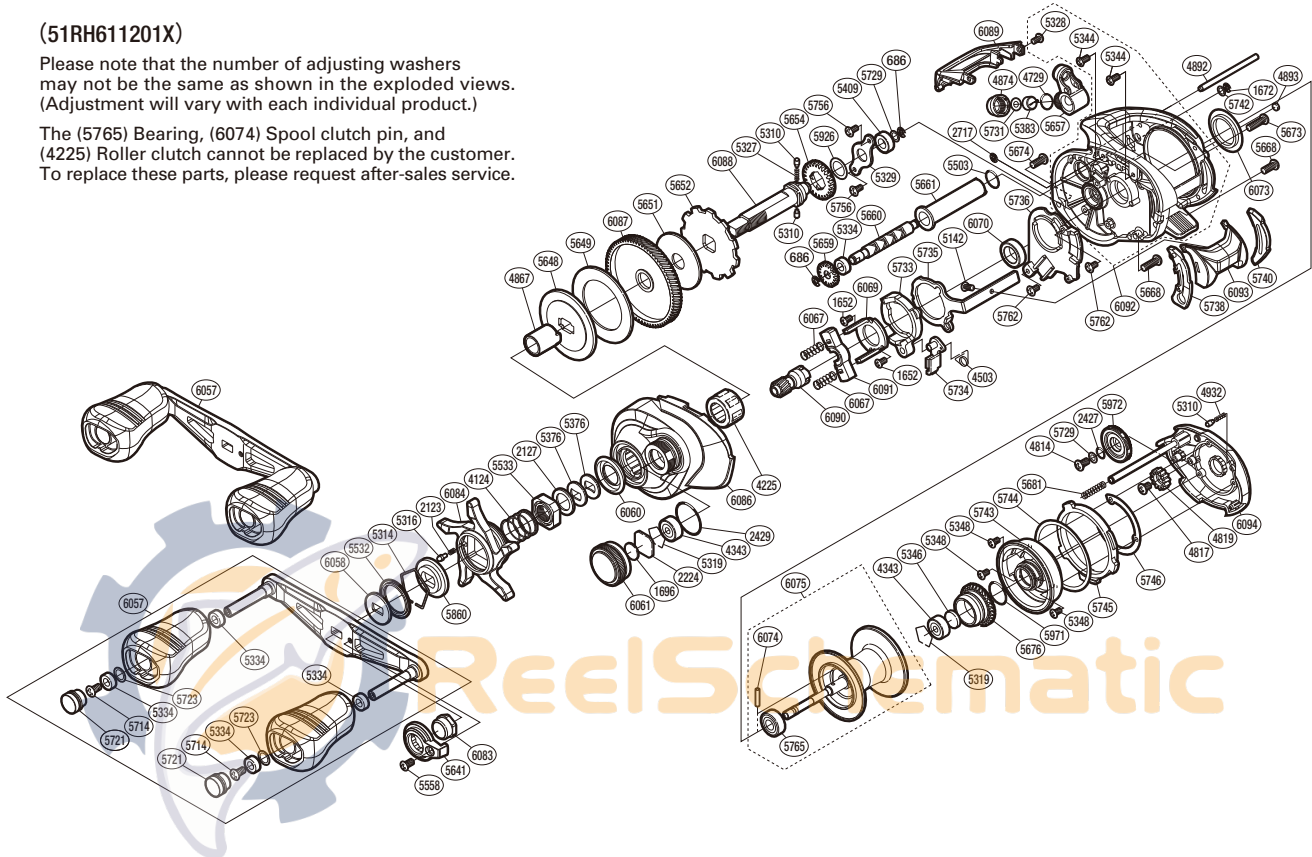

Part No.	Description	Part No.	Description	Part No.	Description
BNT0686	E Lock	BNT5376	Drag Spring Washer	BNT5744	Washer
BNT1652	Screw	BNT5383	Line Guide Pawl	BNT5745	Right Side Plate Cam Lever
BNT1672	E Lock	BNT5409	Drive Shaft Bushing	BNT5746	Washer
BNT1696	Cast Control Spacer B	BNT5503	O Ring	BNT5756	Screw
BNT2123	Click Spring	BNT5532	Star Drag Seal	BNT5762	Screw
BNT2127	Star Drag Spacer	BNT5533	Star Drag Nut	BNT5765	Ball Bearing
BNT2224	Spool Tension Spacer A	BNT5558	Screw	BNT5860	Star Drag Click Plate
BNT2427	O Ring	BNT5641	Handle Nut Plate	BNT5926	Washer
BNT2429	O Ring	BNT5648	Key Washer	BNT5971	O Ring
BNT2717	E Lock	BNT5649	Drag Washer	BNT5972	Brake Dial
BNT4124	Star Drag Spring	BNT5651	Drag Washer	BNT6057	Handle Assembly
BNT4225	Roller Clutch Bearing	BNT5652	Anti-Reverse Ratchet	BNT6058	Drive Shaft Shield
BNT4343	Ball Bearing	BNT5654	Idle Gear	BNT6060	Roller Clutch Water Proof
BNT4503	Clutch Pawl Spring	BNT5657	Line Guide Assembly	BNT6061	Cast Control Cap
BNT4729	O Ring	BNT5659	Idle Gear	BNT6067	Yoke Spring
BNT4814	Screw	BNT5660	Worm Shaft	BNT6069	Clutch Cam Retainer
BNT4817	Screw	BNT5661	Level Wind Guard	BNT6070	Pinion Gear Bushing
BNT4819	Idle Gear	BNT5668	Screw	BNT6073	Frame Center Seal
BNT4867	Roller Clutch Inner Tube	BNT5673	Screw	BNT6074	Spool Clutch Pin
BNT4874	Pawl Cap	BNT5674	Screw	BNT6075	Spool Assembly
BNT4892	Stabilizer Bar	BNT5676	Brake Ring Gear Assembly	BNT6083	Handle Nut
BNT4893	Anti-Thrust Washer	BNT5681	Spring	BNT6084	Star Drag
BNT4932	Click Spring	BNT5714	Screw	BNT6086	Left Side Plate
BNT5142	Screw	BNT5721	Handle Knob Seal	BNT6087	Drive Gear
BNT5310	Idle Gear Pin	BNT5723	Washer	BNT6088	Drive Shaft
BNT5314	Click Plate Retainer	BNT5729	Spacer	BNT6089	Level Wind Protector
BNT5316	Click Pin	BNT5731	Spacer	BNT6090	Pinion Gear
BNT5319	Bearing Retainer	BNT5733	Clutch Cam	BNT6091	Yoke
BNT5327	Idle Gear Spring	BNT5734	Clutch Pawl Assembly	BNT6092	Frame Assembly
BNT5328	Screw	BNT5735	Clutch Plate	BNT6093	Clutch Button Assembly
BNT5329	Drive Shaft Retainer	BNT5736	Clutch Guard	BNT6094	Right Side Plate Assembly
BNT5334	Bushing	BNT5738	Clutch Bar Guide B		
BNT5344	Screw	BNT5740	Clutch Bar Guide A		
BNT5346	Spacer B	BNT5742	Washer		
BNT5348	Screw	BNT5743	Brake Case Assembly	BNT4692	B-100 Oil (Accessory)