

SHIMANO

TRANX S A-RB

TRX200A

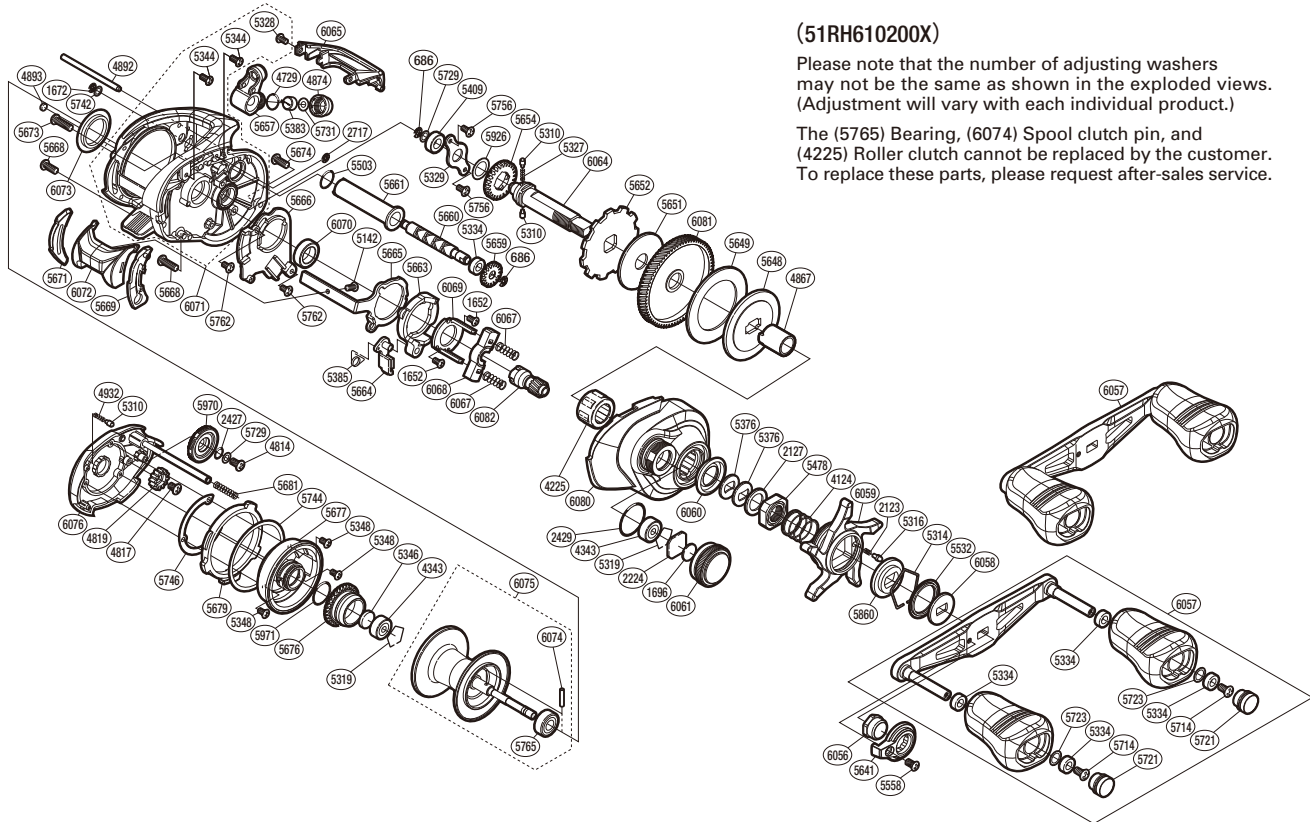

(51RH610200X)

Please note that the number of adjusting washers may not be the same as shown in the exploded views. (Adjustment will vary with each individual product.)

The (5765) Bearing, (6074) Spool clutch pin, and (4225) Roller clutch cannot be replaced by the customer. To replace these parts, please request after-sales service.

Part No.	Description	Part No.	Description	Part No.	Description
BNT0686	E Lock	BNT5383	Line Guide Pawl	BNT5742	Washer
BNT1652	Screw	BNT5385	Clutch Pawl Spring	BNT5744	Washer
BNT1672	E Lock	BNT5409	Drive Shaft Bushing	BNT5746	Washer
BNT1696	Cast Control Spacer B	BNT5478	Star Drag Nut	BNT5756	Screw
BNT2123	Click Spring	BNT5503	O Ring	BNT5762	Screw
BNT2127	Star Drag Spacer	BNT5532	Star Drag Seal	BNT5765	Ball Bearing
BNT2224	Spool Tension Spacer A	BNT5558	Screw	BNT5860	Star Drag Click Plate
BNT2427	O Ring	BNT5641	Handle Nut Plate	BNT5926	Washer
BNT2429	O Ring	BNT5648	Key Washer	BNT5970	Brake Dial
BNT2717	E Lock	BNT5649	Drag Washer	BNT5971	O Ring
BNT4124	Star Drag Spring	BNT5651	Drag Washer	BNT6056	Handle Nut
BNT4225	Roller Clutch Bearing	BNT5652	Anti-Reverse Ratchet	BNT6057	Handle Assembly
BNT4343	Ball Bearing	BNT5654	Idle Gear	BNT6058	Drive Shaft Shield
BNT4729	O Ring	BNT5657	Line Guide Assembly	BNT6059	Star Drag
BNT4814	Screw	BNT5659	Idle Gear	BNT6060	Roller Clutch Water Proof
BNT4817	Screw	BNT5660	Worm Shaft	BNT6061	Cast Control Cap
BNT4819	Idle Gear	BNT5661	Level Wind Guard	BNT6064	Drive Shaft
BNT4867	Roller Clutch Inner Tube	BNT5663	Clutch Cam	BNT6065	Level Wind Protector
BNT4874	Pawl Cap	BNT5664	Clutch Pawl Assembly	BNT6067	Yoke Spring
BNT4892	Stabilizer Bar	BNT5665	Clutch Plate	BNT6068	Yoke
BNT4893	Anti-Thrust Washer	BNT5666	Clutch Guard	BNT6069	Clutch Cam Retainer
BNT4932	Click Spring	BNT5668	Screw	BNT6070	Pinion Gear Bushing
BNT5142	Screw	BNT5669	Clutch Bar Guide B	BNT6071	Frame Assembly
BNT5310	Idle Gear Pin	BNT5671	Clutch Bar Guide A	BNT6072	Clutch Button Assembly
BNT5314	Click Plate Retainer	BNT5673	Screw	BNT6073	Frame Center Seal
BNT5316	Click Pin	BNT5674	Screw	BNT6074	Spool Clutch Pin
BNT5319	Bearing Retainer	BNT5676	Brake Ring Gear Assembly	BNT6075	Spool Assembly
BNT5327	Idle Gear Spring	BNT5677	Brake Case Assembly	BNT6076	Left Side Plate Assembly
BNT5328	Screw	BNT5679	Left Side Plate Cam Lever	BNT6080	Right Side Plate
BNT5329	Drive Shaft Retainer	BNT5681	Spring	BNT6081	Drive Gear
BNT5334	Bushing	BNT5714	Screw	BNT6082	Pinion Gear
BNT5344	Screw	BNT5721	Handle Knob Seal		
BNT5346	Spacer B	BNT5723	Washer		
BNT5348	Screw	BNT5729	Spacer		
BNT5376	Drag Spring Washer	BNT5731	Spacer	BNT4692	B-100 Oil (Accessory)