

# SHIMANO

## TYRNOS A-RB

## TYR-30

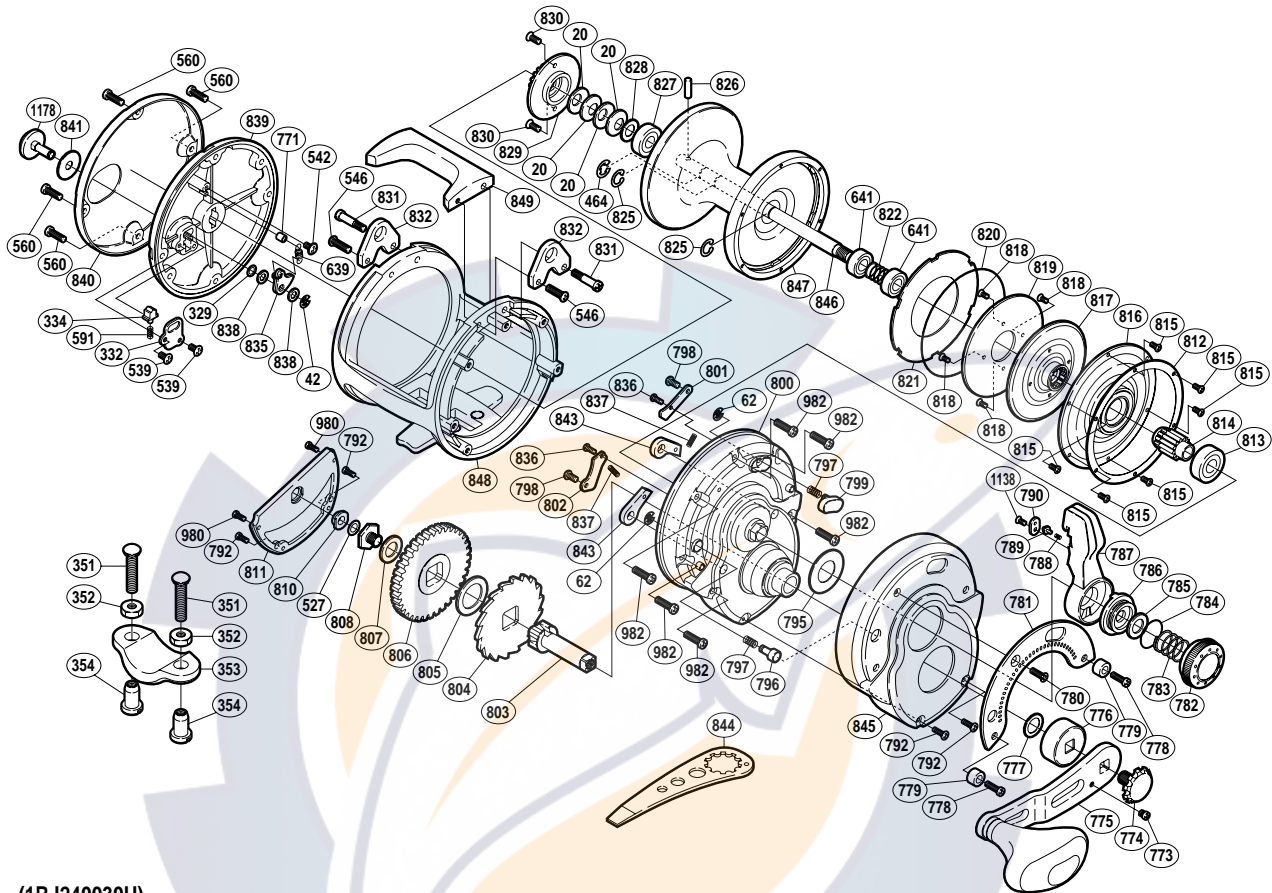

(1R240030U)

| Part No. | Description                 | Part No. | Description                 | Part No. | Description                 |
|----------|-----------------------------|----------|-----------------------------|----------|-----------------------------|
| TGT0020  | Coned Disc Spring           | TGT0789  | Lever Click                 | TGT0827  | Ball Bearing                |
| TGT0042  | E Lock                      | TGT0790  | Lever Click Cover           | TGT0828  | Bearing Thrust Washer       |
| TGT0062  | E Lock                      | TGT0792  | Screw                       | TGT0829  | Click Gear                  |
| TGT0329  | Spacer                      | TGT0795  | Lever Thrust Ring           | TGT0830  | Screw                       |
| TGT0332  | Click Spring Retainer       | TGT0796  | Free Spool Detent           | TGT0831  | Harness Lug Screw           |
| TGT0334  | Click Spring Holder         | TGT0797  | Pressure Spring             | TGT0832  | Harness Lug                 |
| TGT0464  | E Lock                      | TGT0798  | Screw                       | TGT0835  | Click Pawl                  |
| TGT0527  | Spacer                      | TGT0799  | Strike Stop                 | TGT0836  | Screw                       |
| TGT0539  | Screw                       | TGT0800  | Right Side Plate            | TGT0837  | Anti-Reverse Pawl Spring    |
| TGT0542  | Screw                       | TGT0801  | Anti-Reverse Pawl Keeper A  | TGT0838  | Spacer                      |
| TGT0546  | Screw                       | TGT0802  | Anti-Reverse Pawl Keeper B  | TGT0839  | Left Side Plate             |
| TGT0560  | Screw                       | TGT0803  | Drive Shaft                 | TGT0840  | Left Side Plate Cover       |
| TGT0591  | Click Spring                | TGT0804  | Anti-Reverse Ratchet        | TGT0841  | Click Button Spacer         |
| TGT0639  | Click Pawl Spring           | TGT0805  | Anti-Reverse Ratchet Spacer | TGT0843  | Anti-Reverse Pawl           |
| TGT0641  | Ball Bearing                | TGT0806  | Drive Gear                  | TGT0845  | Right Side Plate Cover      |
| TGT0771  | Click Pawl Spring Boss Ring | TGT0807  | Drive Gear Spacer           | TGT0846  | Spool Shaft                 |
| TGT0773  | Screw                       | TGT0808  | Drive Shaft Screw           | TGT0847  | Spool                       |
| TGT0774  | Handle Bolt                 | TGT0810  | Drive Shaft Bushing         | TGT0848  | One-Piece Frame             |
| TGT0775  | Handle                      | TGT0811  | Right Side Seal             | TGT0849  | Cross Bar                   |
| TGT0776  | Gear Shaft Shield           | TGT0812  | Cooling Shield Ring         | TGT0980  | Screw                       |
| TGT0777  | Gear Shaft Thrust Washer    | TGT0813  | Ball Bearing                | TGT0982  | Screw                       |
| TGT0778  | Screw                       | TGT0814  | Pinion Gear                 | TGT1138  | Screw                       |
| TGT0779  | Screw Shield                | TGT0815  | Screw                       | TGT1178  | Click Button                |
| TGT0780  | Screw                       | TGT0816  | Cooling Shield              |          |                             |
| TGT0781  | Lever Quadrant              | TGT0817  | Pinion Guard                |          |                             |
| TGT0782  | Pre-Program Dial            | TGT0818  | Screw                       |          |                             |
| TGT0783  | Dial Spring                 | TGT0819  | Drag Plate                  | TGT0351  | Rod Clamp Bolt (accessory)  |
| TGT0784  | O Ring                      | TGT0820  | O Ring                      | TGT0352  | Rod Clamp Nut B (accessory) |
| TGT0785  | Drag Cam Washer             | TGT0821  | Drag Washer                 | TGT0353  | Rod Clamp (accessory)       |
| TGT0786  | Lever Shaft Body            | TGT0822  | Pressure Release Spring     | TGT0354  | Rod Clamp Nut A (accessory) |
| TGT0787  | Drag Control Lever          | TGT0825  | C Lock                      |          |                             |
| TGT0788  | Lever Click Shoe            | TGT0826  | Cross Pin                   | TGT0844  | Wrench (accessory)          |