

# SILSTAR

FX50

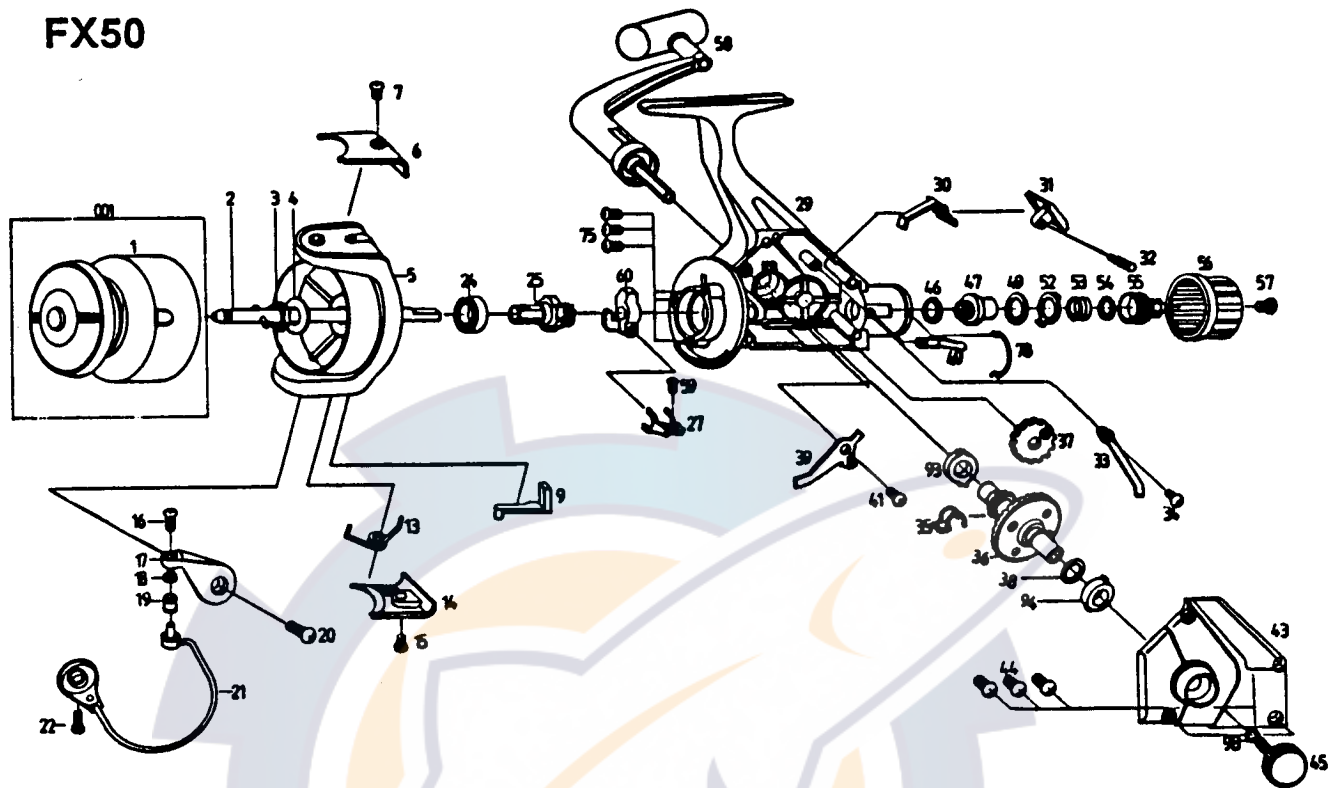

REF. NO	PART NO.	DESCRIPTION	PRICE	REF. NO.	PART NO.	DESCRIPTION	PRICE
1	001-6160	SPOOL ASSY	\$3.76	36	030-4213	A-R-CLAW ADJ. S/P	\$0.36
2	002-6160	MAIN SHAFT ASSY	\$0.60	36	036-6150	DRIVE GEAR	\$0.60
3	003-0210	ROTOR NUT	\$0.36	37	037-2810	O/S GEAR	\$0.36
4	004-0110	ROTOR W/S	\$0.36	38	038-0310	DRIVE GEAR ADJ. W/S	\$0.36
5	006-6160	ROTOR ASSY	\$1.32	39	039-6142	A-R-CLAW	\$0.36
6	006-6160	B/H C/O	\$0.36	40	040-1810	DRAG LEAF S/P	\$0.36
7	076-4213	B/H C/O S/C	\$0.36	41	041-4214	A-R-CLAW S/C	\$0.36
9	009-6160	BAIL K/L	\$0.36	43	043-6160	BODY C/O ASSY	\$0.60
13	013-4216	BAIL S/P	\$0.36	44	044-4216	BODY C/O S/C	\$0.36
14	014-6160	ARM LEVER C/O	\$0.36	45	045-6160	HANDLE S/C CAP	\$0.36
15	076-4213	ARM LEVER C/O S/C	\$0.36	46	046-6160	METAL W/S	\$0.36
16	016-0110	L-SLIDER S/C	\$0.36	47	047-6160	CLICK METAL	\$0.36
17	017-6160	ARM LEVER	\$0.36	49	049-6160	B W/S	\$0.36
18	018-6160	L-SLIDER W/S	\$0.36	52	052-6160	A W/S	\$0.36
19	019-0310	L-ROLLER	\$0.36	53	053-6160	COIL S/P	\$0.36
20	041-4214	ARM LEVER S/C	\$0.36	54	054-6160	PRESSURE W/S	\$0.36
21	021-6160	BAIL ASSY	\$0.96	55	055-6160	PRESSURE	\$0.36
22	041-4214	B/H H/C	\$0.36	56	056-6160	DRAG KNOB	\$0.60
24	024-0110	BALL BEARING	\$1.10	57	057-6160	DRAG S/C	\$0.36
25	026-6160	PINION	\$0.36	58	058-6160	HANDLE ASSY	\$1.76
27	027-6160	RETAINER	\$0.36	59	059-0110	O/S SLIDER S/C	\$0.36
29	029-6160	BODY ASSY	\$2.66	60	060-4214	O/S SLIDER	\$0.36
30	030-6160	LEAF S/P	\$0.36	75	075-6140	BEARING S/C	\$0.36
31	031-4213	A-R-LEVER	\$0.36	78	078-6160	PRESSURE RETAINER	\$0.36
32	032-0110	PIN	\$0.36	93	093-4212	BEARING	\$0.36
33	033-6160	CLICK CLAW	\$0.36	94	093-4212	BEARING	\$0.36
34	034-6160	CLICK CLAW S/C	\$0.36	98	098-4211	NYLON W/S	\$0.36

## PARTS LIST FOR SILSTAR : FX50

\* When ordering parts for your Silstar reel, be sure to include the following:

1) Complete Model Number and Letter. Example: BT 80 B

2) Specify Color for FX, BT,CX,ER,EC series reels.