

# SILSTAR

## GXB40M (Manual Trip)

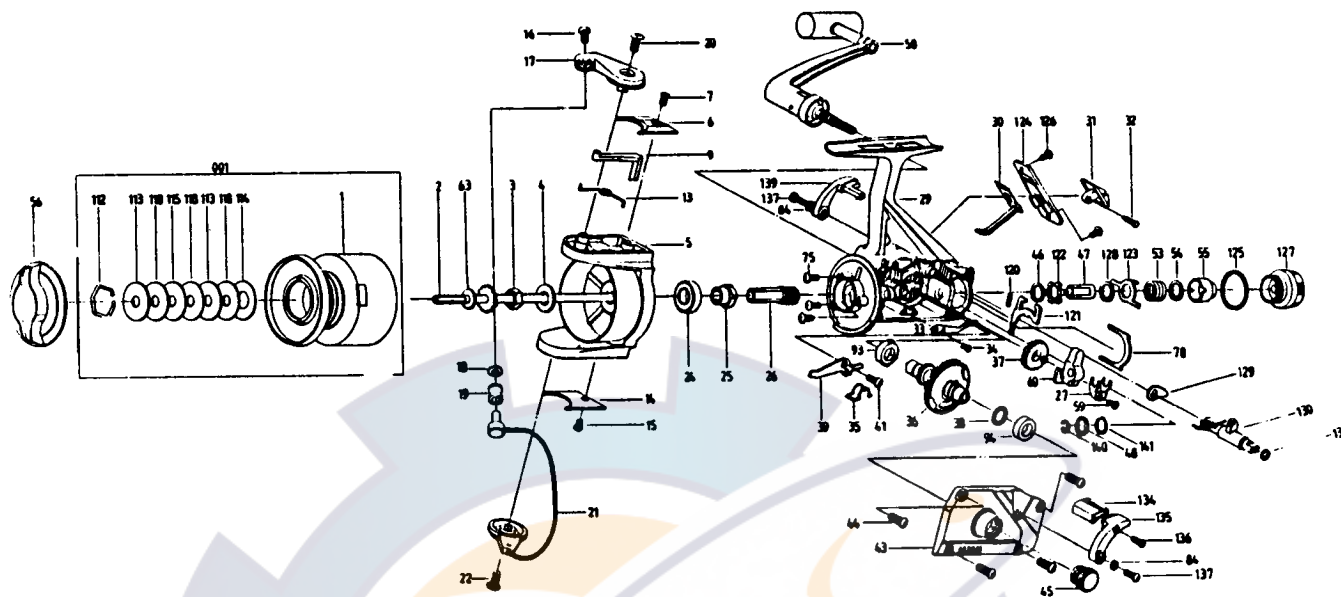

REF. NO	PART NO.	DESCRIPTION	PRICE	REF. NO.	PART NO.	DESCRIPTION	PRICE
1	001-6116	SPOOL ASSY	\$3.76	46	046-6111	W/S	\$0.36
2	002-6111	MAIN SHAFT ASSY	\$3.90	47	047-6111	CLICK METAL	\$0.36
3	003-0210	ROTOR NUT	\$0.36	48	048-6111	CLICK GEAR	\$0.36
4	004-6111	ROTOR W/S	\$0.35	53	053-6111	COIL S/P	\$0.36
5	005-6116	ROTOR	\$2.66	54	054-6111	PRESSURE W/S	\$0.36
6	006-6116	B/H C/O	\$0.36	55	055-6111	PRESSURE	\$1.10
7	007-4211	B/H C/O S/C	\$0.36	56	056-6111	DRAG KNOB ASSY	\$2.00
9	009-4217	BAIL K/L	\$0.36	58	058-4227	HANDLE ASSY	\$3.36
13	013-4216	BAIL S/P	\$0.36	59	059-0110	S/C	\$0.36
14	014-6116	ARM LEVER C/O	\$0.36	60	060-6111	O/S SLIDER	\$0.60
16	007-4211	ARM LEVER C/O S/C	\$0.36	75	075-4214	BEARING PLATE S/C	\$0.36
18	016-0410	L-SLIDER S/C	\$0.36	78	078-6111	RETAINER	\$0.36
17	017-4211	ARM LEVER	\$0.36	84	084-6111	W/S	\$0.36
18	018-4219	L-ROLLER COLLAR	\$0.36	93	093-4212	BEARING	\$0.36
19	019-1810	L-ROLLER	\$0.75	94	093-4212	BEARING	\$0.36
20	057-0710	ARM LEVER S/C	\$0.36	120	120-6111	CLUTCH S/P	\$0.36
21	021-4236	BAIL ARM	\$1.46	121	121-6111	CLUTCH	\$0.36
22	057-0710	B/H S/C	\$0.36	122	122-6111	FE RATCHET	\$0.36
24	024-4214	BALL BEARING	\$3.10	123	123-6111	A W/S	\$0.36
25	025-4214	RATCHET	\$0.36	124	124-6111	A-R-LEVER C/O	\$0.60
26	026-6111	PINION	\$1.60	125	125-6111	DRAG RING	\$0.36
27	027-6111	RETAINER	\$0.36	126	126-6111	S/C	\$0.36
29	029-6116	BODY ASSY	\$4.90	127	127-6111	TENSION DRAG	\$1.10
30	030-6111	LEAF S/P	\$0.36	128	128-6111	W/S	\$0.36
31	031-6111	A-R-LEVER	\$0.36	129	129-6111	CLUTCH CAM	\$0.36
32	032-6111	PIN	\$0.36	130	130-6111	CLUTCH ARM ASSY	\$0.60
33	033-6111	CLICK CLAW	\$0.36	131	131-6111	CLUTCH ARM W/S	\$0.36
34	007-4214	CLICK CLAW S/C	\$0.36	134	134-6111	BAIT FE BRIDGE	\$0.36
35	030-4213	A-R-CLAW ADJ S/P	\$0.36	135	135-6111	BAIT FE LEVER (L)	\$0.36
36	036-6111	DRIVE GEAR ASSY	\$2.80	136	136-6111	BRIDGE S/C	\$0.36
37	037-6111	O/S GEAR	\$0.36	137	137-6111	LEVER S/C	\$0.36
38	038-4211	DRIVE GEAR ADJ W/S	\$0.36	139	139-6111	BAIT FE LEVER (R)	\$0.36
39	039-6111	A-R-CLAW	\$0.36	140	140-6111	RETAINER	\$0.36
41	041-4214	A-R-CLAW S/C	\$0.36	141	141-6111	W/S	\$0.36
43	043-6116	BODY C/O	\$1.60	142	142-6111	CLUTCH ARM S/P	\$0.36
44	044-3010	BODY C/O S/C	\$0.36	143	143-6111	CLUTCH ARM P/L S/P	\$0.36
45	045-0310	HANDLE S/C CAP	\$0.36				

**PARTS LIST FOR SILSTAR :**

**GXB40M**

\* When ordering parts for your Silstar reel, be sure to include the following:

- 1) Complete Model Number and Letter. Example: BT 80 B
- 2) Specify Color for FX, BT, CX, ER, EC series reels.