

SILSTAR

LT35

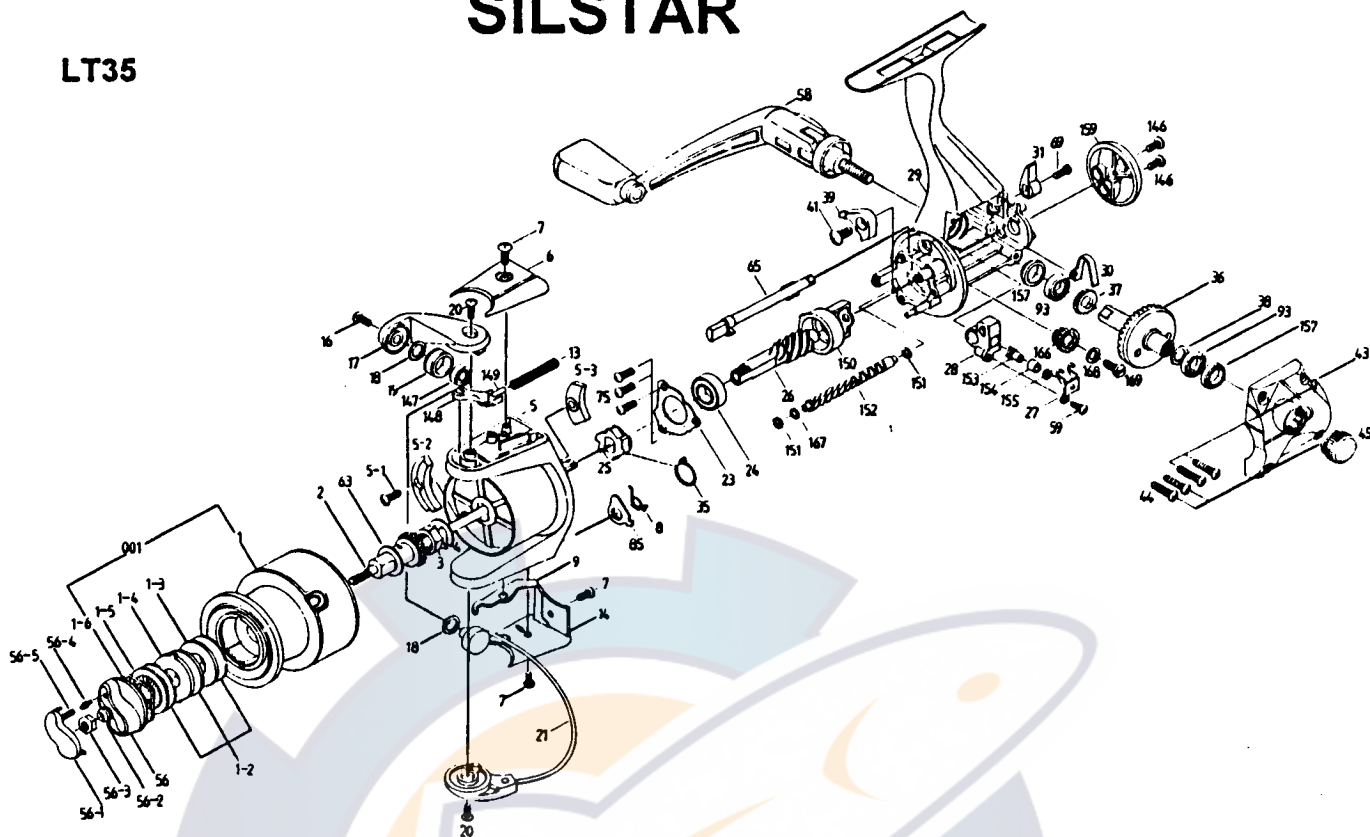

REF.NO	PART NO.	DESCRIPTION	PRICE	REF. NO.	PART NO.	DESCRIPTION	PRICE
1	001-5122	SPOOL ASSY ALUM	\$6.50	38	038-4214	DRIVE GEAR ADJ W/S	\$0.35
1	001-5522	SPOOL ASSY GHPT	\$4.00	39	039-5121	A-R-CLAW	\$0.35
2	002-5121	MAIN SHAFT ASSY	\$3.10	41	041-5121	A-R-CLAW S/C	\$0.35
3	003-0710	ROTOR NUT	\$0.35	43	043-5122	BODY C/O ASSY	\$1.75
4	004-2610	S/P WASHER	\$0.35	44	044-4217	BODY C/O S/C	\$0.35
5	005-5121	ROTOR	\$4.20	45	045-0710	HANDLE S/C CAP	\$0.35
6	006-5121	B/H C/O	\$0.35	56	056-5121	DRAG KNOB ASSY	\$1.75
7	007-4211	B/H C/O S/C	\$0.35	58	058-5121	HANDLE ASSY	\$3.75
8	008-5121	BAIL K/L S/P	\$0.35	59	059-5121	SCREW	\$0.35
9	009-5121	BAIL K/L	\$0.35	63	063-5121	SPOOL ADJ W/S	\$0.35
13	013-5121	BAIL S/P	\$0.35	65	065-5121	A-R-CAM	\$0.60
14	014-5121	ARM LEVER C/O	\$0.35	69	069-5121	A-R-LEVER S/C	\$0.35
16	016-0410	L-SLIDER S/C	\$0.35	75	075-5121	BEARING PLATE S/C	\$0.35
17	017-5121	ARM LEVER	\$0.60	85	085-5121	KICK LINK	\$0.35
18	018-5123	L-ROLLER COLLAR	\$0.35	93	024-5121	BALL BEARING	\$3.10
19	019-5123	L-ROLLER	\$1.80	146	146-5123	SCREW	\$0.35
20	020-4211	ARM LEVER S/C	\$0.35	147	147-5123	BALL BEARING	\$3.10
21	021-5121	BAIL ASSY	\$3.00	148	148-5121	BAIL S/P LINK	\$0.35
23	023-5121	BEARING PLATE	\$0.35	149	149-5121	BAIL S/P HOLDER	\$0.35
24	024-2610	BALL BEARING	\$3.10	150	150-5121	BEARING HOLDER	\$0.60
25	025-5121	RATCHET	\$0.35	151	151-5123	BEARING	\$0.35
26	026-5121	PINION	\$2.80	152	152-5121	CARRIAGE S/C	\$3.00
27	027-5121	RETAINER	\$0.35	153	153-5121	PAWL	\$1.10
28	028-5121	O/S HOLDER	\$0.35	154	154-5121	PAWL COLLAR	\$0.35
29	029-5122	BODY	\$5.00	155	155-5121	PAWL WASHER	\$0.35
30	030-5121	A-R-CAM S/P	\$0.35	156	156-5121	STOP RING	\$0.35
31	031-5121	A-R-LEVER	\$0.35	157	157-5121	SEAL	\$0.35
35	035-5121	A-R-CLAW S/P	\$0.35	158	158-5121	MAIN SHAFT PIN	\$0.35
36	036-5121	DRIVE GEAR	\$1.95	159	159-5121	REAR COVER	\$1.00
37	037-5121	O/S GEAR	\$0.35				

PARTS LIST FOR SILSTAR : LT30

* When ordering parts for your Silstar reel, be sure to include the following:

- 1) Complete Model Number and Letter. Example: BT 80 B
- 2) Specify Color for FX, BT,CX,ER,EC series reels.