

PARTS LIST

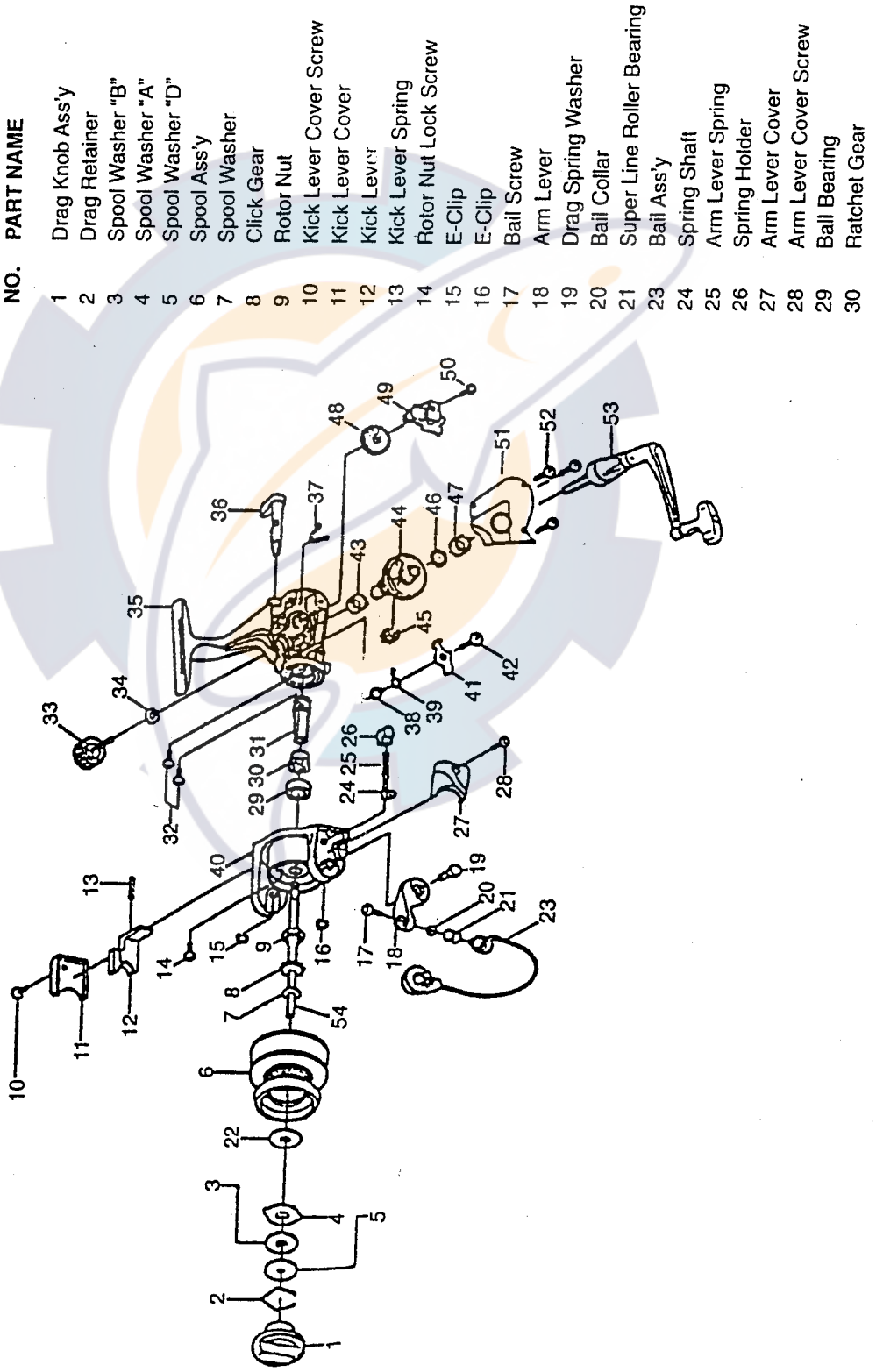

| NO. | PART NAME | NO. | PART NAME |
|-----|---------------------------|-----|------------------------|
| 1 | Drag Knob Ass'y | 31 | Pinion Gear |
| 2 | Drag Retainer | 32 | Bearing Screw |
| 3 | Spool Washer "B" | 33 | Handle Screw Cap |
| 4 | Spool Washer "A" | 34 | Handle Screw Washer |
| 5 | Spool Washer "D" | 35 | Body |
| 6 | Spool Ass'y | 36 | Stopper Lever |
| 7 | Spool Washer | 37 | Stopper Lever Spring |
| 8 | Click Gear | 38 | Stopper Bushing |
| 9 | Rotor Nut | 39 | Stopper Spring |
| 10 | Kick Lever Cover Screw | 40 | Rotor |
| 11 | Kick Lever Cover | 41 | Stopper "B" |
| 12 | Kick Lever | 42 | Stopper Screw |
| 13 | Kick Lever Spring | 43 | Ball Bearing |
| 14 | Rotor Nut Lock Screw | 44 | Drive Gear |
| 15 | E-Clip | 45 | Silent Cam |
| 16 | E-Clip | 46 | Drive Gear Adj. Washer |
| 17 | Bail Screw | 47 | Ball Bearing |
| 18 | Arm Lever | 48 | Oscillation Gear |
| 19 | Drag Spring Washer | 49 | Oscillation Slider |
| 20 | Bail Collar | 50 | Main Shaft Screw |
| 21 | Super Line Roller Bearing | 51 | Body Cover |
| 22 | Bail Ass'y | 52 | Body Cover Screw |
| 23 | Spring Shaft | 53 | Handle Ass'y |
| 24 | Arm Lever Spring | 54 | Main Shaft |
| 25 | Spring Holder | | |
| 26 | Arm Lever Cover | | |
| 27 | Arm Lever Cover Screw | | |
| 28 | Ball Bearing | | |
| 29 | Ratchet Gear | | |
| 30 | | | |