

resistant materials require minimum care.

If used in salt water, be sure to remove the spool and rinse your reel thoroughly in warm fresh water. Then, wipe dry. Do not apply water under pressure, since this simply forces salt water particles into your reel's mechanism. When used in salt water we suggest spraying the metal parts of your reel, after each trip, with a moisture absorbent spray such as WD-40.

Always remove any sand particles from your reel. Should you accidentally drop your reel in sand or gravel, it may be necessary to disassemble and thoroughly clean all parts before further use. The push button spool removal system on your reel makes this job easy. Apply a high-grade lubricant, such as South Bend "Super Reel Oil" (with Teflon), on all of your moving parts (with the exception of the disc drag system). At least once a year, remove the spool and grease the main shaft with South Bend "Super Reel Grease", which is especially formulated for fresh and salt water reels.

### LIMITED WARRANTY

Crystal River will repair or replace any product which proves defective in workmanship or materials within ninety days from the date of original purchase.

This warranty does not cover damage caused by negligence, accident, misuse, alteration of the product, or normal expected wear. Damage that is determined to be of this nature will be repaired at customer's expense.

**IMPORTANT**—Specify reel model number when ordering parts.  
**Example**—Extra spool for Crystal River Royal Coachman Rim Fly Reel CR-2101—specify CR-2101 (reel no.) - 11 (spool part no.)

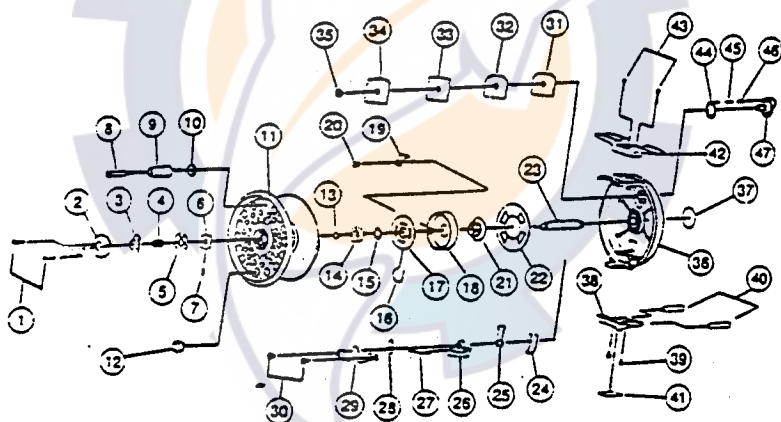

KEY NO.	DESCRIPTION	KEY NO.	DESCRIPTION
1	P/BUTTON COVER SCREW	25	
2	PUSH BUTTON COVER	26	S/P LOCK PLATE
3	PUSH BUTTON	27	CLICK PAWL S/P
4	P/BUTTON SPRING	28	CLICK PAWL
5	LOCK PLATE COVER	29	C/PAWL COVER
6	SPOOL LOCK PLATE	30	C/PAWL COVER S/C
7	LOCK PLATE SPRING	31	DRAG W/S "A"
8	HANDLE RIVET	32	DRAG W/S "B"
9	HANDLE KNOB	33	DRAG W/S "C"
10	H/KNOB COLLAR	34	DRAG W/S "D"
11	SPOOL UNIT	35	"E" - CLIP
12	BALANCE WEIGHT(ONLY AXLE II)	36	FRAME UNIT
13	"O" - RING	37	FRAME LABEL
14	SPOOL BUSH(AXLE II - BALL BEARING)	38	LINE GUIDE
15	ADJUST W/S	39	L/GUIDE S/C
16	SILENT CAM	40	LINE ROLLER
17	RATCHET	41	L/GUIDE LABEL
18	STOPPER COVER	42	STAND
19	STOPPER	43	STAND SCREW
20	STOPPER RIVET	44	D/KNOB RETAINER
21	RATCHET COVER	45	DRAG STOPPER
22	DRAG DISK	46	D/STOPPER S/P
23	MAIN SHAFT	47	DRAG KNOB
24			