

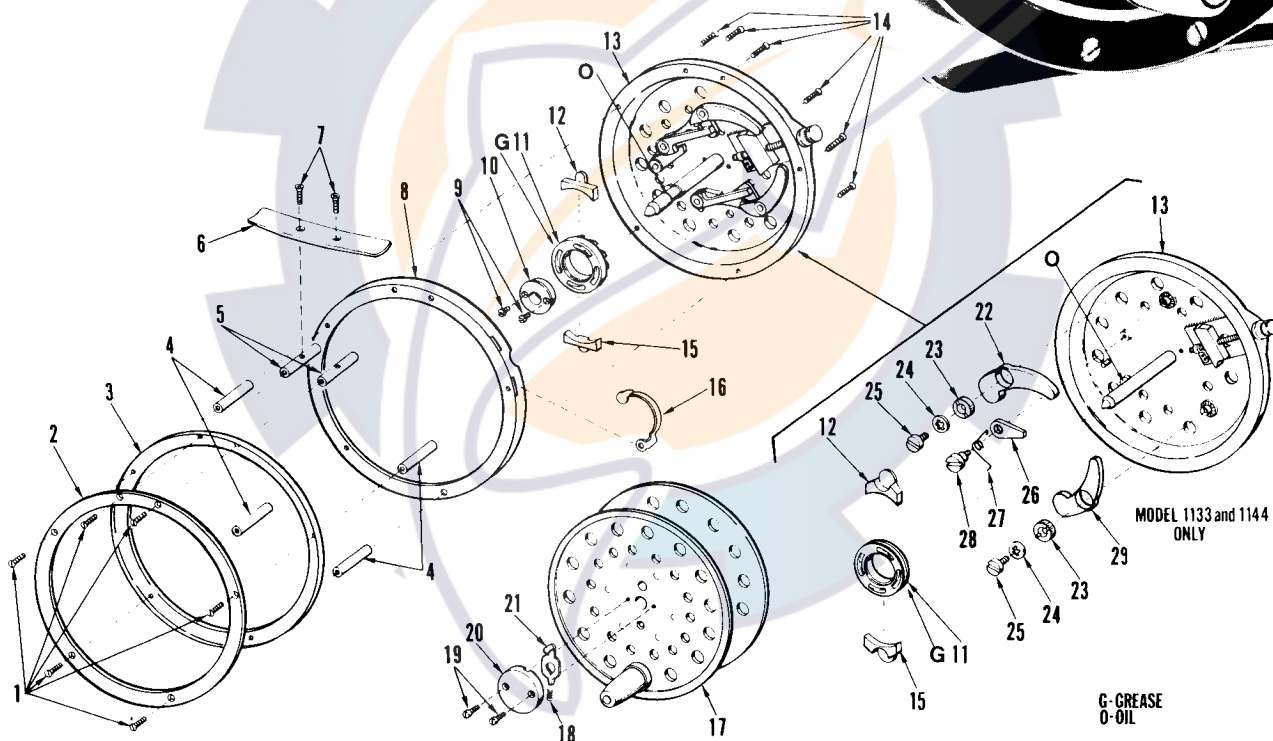

**GLADDING**  
**South Bend Tackle Co., Inc.**  
 Division of **GLADDING** Corporation

**1144**  
 3-31-1144  
**FLY REEL**



G- GREASE  
 O- OIL

Detail No.	Part Name	Part No.	Price	Detail No.	Part Name	Part No.	Price	
1	Pillar Screws	SA21-44/8	.10	17	Spool	SA55-44/1	4.50	
2	Front Plate	SA24-44/6	1.30	18	Lock Spring	SA19-44/3	.15	
3	Front Ring	SA26-44/7	1.45	19	Cap Screws	SA1-44/5	.10	
4	Side Pillars	SA29-44/9	.30	20	Spool Cap	SA66-44/4	.20	
5	Bottom Pillars	SA31-44/10	.30	21	Spool Lock	SA4-44/2	.10	
6	Rod Clip	SA33-44/11	.85	<b>COMPLETE FRAME ASSEMBLY*</b>			44/21	10.00
7	Rod Clips Screws	SA35-44/12	1.10	with Center Post, Click Pawl, Phenolic-Teflon Brake Pads, 1st and 2nd Stage Arms, Brake Arm Rivets, Drag Screw Retainer, Drag Screw Retainer Rivets, Drag Screw, Plastic Washer, Double Action Cam, 1st and 2nd Stage Levers. (Latter parts are riveted and are not available separately as spare parts.)				
8	Back Ring	SA37-44/16	1.40					
9	Drag Hub Screws	SA39-44/13	.10					
10	Drag Hub	SA40-44/14	.60					
11	Drag Drum	SA41-44/15	.45					
12	Drag Pad-1st Stage	SA43	1.00					
13	Back Plate	SA46	*					
14	Back Plate Screws	SA48-44/8	.10					
15	Drag Pad-2nd Stage	SA50	.40					
16	Knob Guard	SA52-44/19	.25					