

Teflon), to the main shaft and handle knob. And, at least once a year, remove spool and grease the main shaft with South Bend "Super Reel Grease" which is especially formulated for both fresh and salt water reels. Do not oil or lubricate the drag mechanism.

LIMITED WARRANTY

South Bend will repair or replace any product which proves defective in workmanship or materials within ninety days from the date of original purchase.

This warranty does not cover damage caused by negligence, accident, misuse, alteration of the product, or normal expected wear. Damage that is determined to be of this nature will be repaired at customer's expense.

IMPORTANT—Specify reel model number when ordering parts.
Example—Extra spool for Ginger Quill Rim Fly Reel 1154—specify 1154 (reel.no.) - 8 (spool part no.)

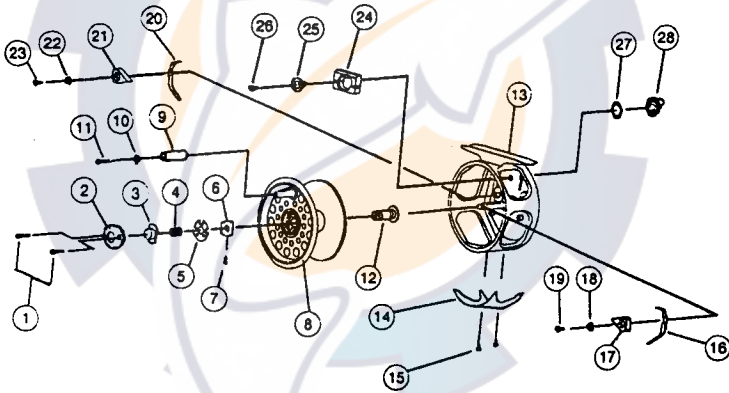

| KEY NO. | DESCRIPTION | KEY NO. | DESCRIPTION |
|---------|----------------------|---------|-------------------|
| 1 | P/BUTTON COVER SCREW | 15 | LINE GUIDE SCREW |
| 2 | PUSH BUTTON COVER | 16 | CLICK PAWL SPRING |
| 3 | PUSH BUTTON | 17 | CLICK PAWL |
| 4 | P/BUTTON SPRING | 18 | CLICK PAWL WASHER |
| 5 | LOCK PLATE COVER | 19 | CLICK PAWL SCREW |
| 6 | SPOOL LOCK PLATE | 20 | CLICK PAWL SPRING |
| 7 | LOCK PLATE SPRING | 21 | CLICK PAWL |
| 8 | SPOOL UNIT | 22 | CLICK PAWL WASHER |
| 9 | HANDLE KNOB | 23 | CLICK PAWL SCREW |
| 10 | HANDLE KNOB WASHER | 24 | DRAG CAM HOLDER |
| 11 | HANDLE KNOB SCREW | 25 | DRAG CAM |
| 12 | SPOOL BUSH | 26 | DRAG CAM SCREW |
| 13 | FRAME UNIT | 27 | DRAG CLICK CLAW |
| 14 | LINE GUIDE | 28 | DRAG KNOB |