

NORSEMAN 110

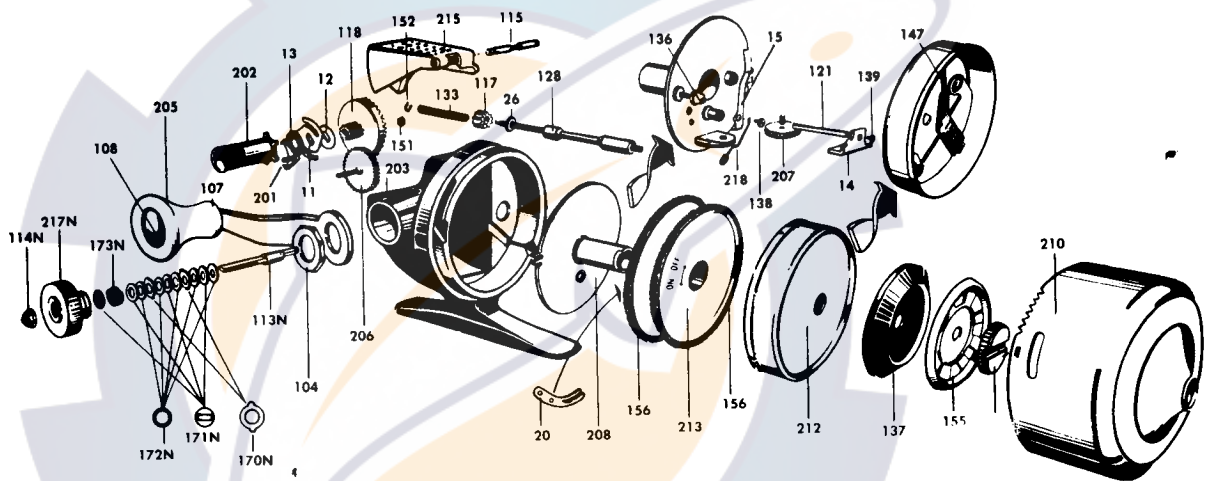

SPINCAST REEL

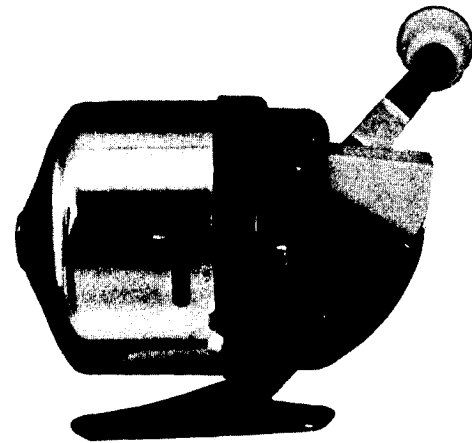

PART NO.	PART NAME	LIST PRICE	PART NO.	PART NAME	LIST PRICE
110-11	Drag Click	\$.40	110-147	Pickup Spring	.15
110-12	Click Washer	.15	110-151	Main Gear Nut	.10
110-13	Friction Washer	.10	110-152	Shaft Spring Retainer	.10
110-14	Smooth Wind Follower	.40	110-155	Feathering Ring	.25
110-15	Control Button Spring	.30	110-156	Line Retainer	.20
110-20	Spool Lock	.30	110-170N	Fixed Drag Washer	.10
110-25	Retaining Clip	.10	110-171N	Drag Washer	.10
110-26	Main Shaft Washer	.10	110-172N	Drag Friction Washer	.10
110-28*	Waffle Washer	.10	110-173N	Drag Spring	.35
110-104	Crank Nut	.25	110-201	Anti-Reverse Pawl	.25
110-107	Crank Handle	.40	110-202	Crank Sleeve	1.60
110-108	Crank Handle Rivet	.60	110-203	Housing	6.00
110-113N	Crank Shaft	1.00	110-205	Crank Assembly	2.25
110-114N	Crank Shaft Nut	.25	110-206	Inner Gear	.75
110-115	Control Button Pin	.35	110-207	Smooth Wind Gear	1.00
110-117	Pinion Gear	.40	110-208	Bearing Plate	3.85
110-118	Main Gear	.75	110-208-4*	Bushing	.05
110-118-B*	Pinion	.50	110-210	Outer Cone	2.50
110-122*	Crank Bushing	.40	110-212	Pickup Housing Complete	5.50
110-123*	Eyelet	.25	110-213	Line Spool	3.00
110-125*	Cover Locking Spring Button	.15	110-215	Control Button	.50
110-128	Main Shaft	2.00	110-217N	Drag Adjusting Nut	1.50
110-133	Main Shaft Spring	.15	110-218	Cone Locking Spring	.40
110-136	Bearing Plate Nut	.25	110-121	Smooth Wind Shaft	
110-137	Line Brake	.35	110-139	Shaft Screw	COMBINATION .50
110-138	Spring Screw	.10	B 4164*	Washer	.05
110-142	Main Shaft Nut	.35	110-.020*	Washer	.10

*NOT ILLUSTRATED

DISASSEMBLY and OILING INSTRUCTIONS

1. Depress Outer Cone Locking Spring (218) and remove Outer Cone (210) with a counter-clockwise quarter turn. 2. Remove Main Shaft Nut (142) with coin or screwdriver and lift off Pickup Housing. Note: Rubber Line Brake (137) and Feathering Ring (155) are cemented to Pickup Housing. 3. Turn Spool (213) to "off" position, disengaging Spool Lock (20), and slide from bushing. 4. Press out Control Button Snap-Lock Pin (115) and lift out Control Button (215). 5. Unscrew Bearing Plate Nut (136) and, by

turning slightly to disengage locking fork, remove Bearing Plate (208) from Housing (203). Main Shaft (128) now slides free from bearing. 6. Smooth Wind Assembly is dismantled by removing Shaft Screw (138). To avoid loss of parts or incorrect reassembly, disassembly beyond this point is not recommended. For a periodic servicing of the reel, return it to your dealer for complete breakdown, cleansing and lubrication.

NOTE: When ordering parts, give reel part name, reel number and model.