

*SeaMatic*  
**808**

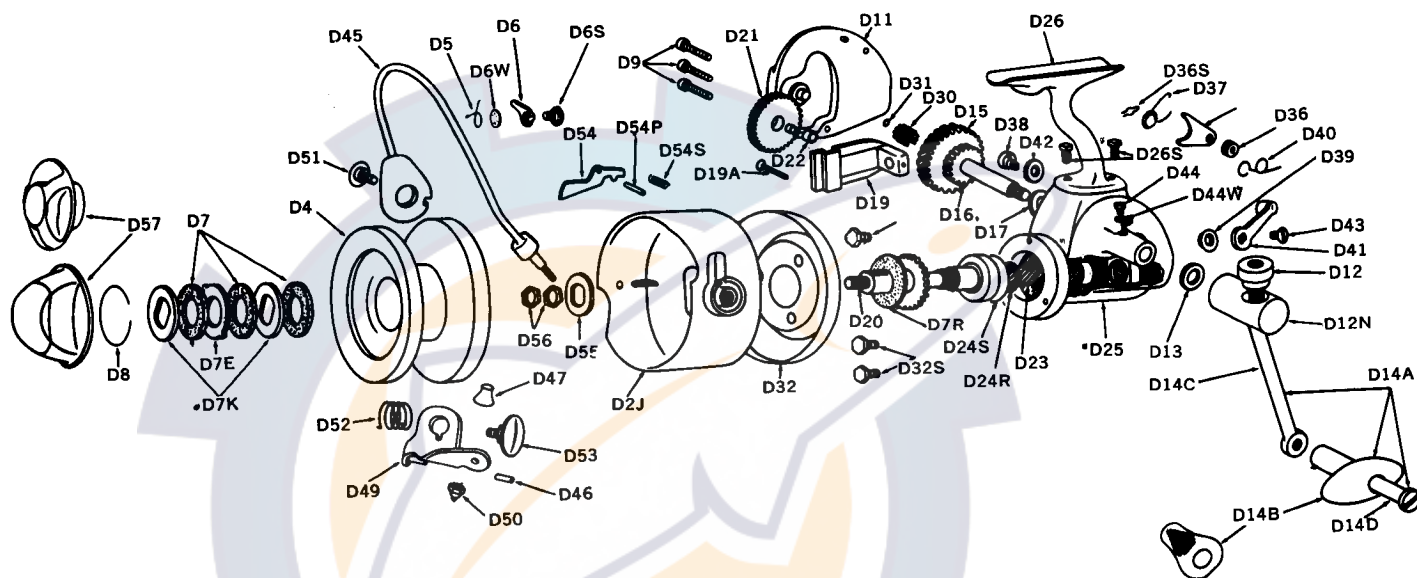
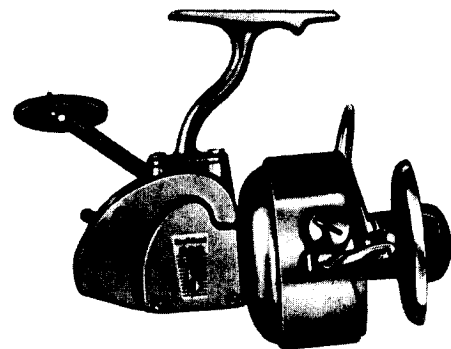

**PARTS BREAKDOWN FOR THE** *SeaMatic* **REELS**

Part Name	Part No.	Price	Part Name	Part No.	Price		
Pickup Housing Assembly	D2J	DA4742TV	\$5.00	Frame Assembly	D25	DA4704TV	7.75
Spool Assembly	D4	DA4778TV	6.00	Rod Clip	D26	DA4705TV	1.45
(Includes Clutch Washers)				Rod Clip Screw	D26S	E4828	.15
Click Spring	D5	E4847	.05	Level Wind Pinion	D30	E854	.50
Click Pawl	D6	E780	.10	Level Wind Pinion Ret. Ring	D31	P896	.02
Click Screw	D6S	E5015	.15	Bearing Cover	D32	A4711TV	.75
Lock Washer	D6W	E5078	.05	Bearing Cover Screw	D32S	E4712	.10
Drag Washer Leather	D7	L2155	.15	Bail Trip Screw	D33	E4713	.35
Drag Eared Washer	D7E	B2154K	.15	Non-Reverse Pawl	D34	E4796	.25
Drag Keyed Washer	D7K	B3952K	.15	Non-Reverse Spring Washer	D36	E4891	.10
Drag Washer, Rear	D7R	L4824	.15	Retainer Spring	D36S	E4475	.02
Clutch Retaining Spring	D8	E4775	.03	Non-Reverse Pawl Spring	D37	E4716	.05
Cover Screw	D9	B4728K	.05	Non-Reverse Pawl Throwout	D38	E4717	.45
Cover Assembly, opposite crank	D11	Order by Reel Name, No.	2.10	Non-Reverse Throwout Bushing	D39	N4823	.25
Crank Locking Nut	D12	A4733GJ	.30	Throwout Tension Spring	D40	E4814	.10
Crank Mounting Nut	D12N	A4734GJ	1.00	Throwout Lever Assembly	D41	B4798K	.60
Crank Mounting Nut	D13	E4736	.05	Throwout Washer	D42	B4817	.05
Thrust Washer				Throwout Lever Screw	D43	B1493K	.10
Crank Assembly	D14A	A4732GJ	2.95	Oiling Screw	D44	B4720K	.20
Crank Handle	D148	JK4802	.60	Oiling Screw Washer	D44N	R4799	.15
Crank Shaft	D14C	A4727GJ	1.90	Bail Wire Assembly	D45	NE5626	3.45
Handle Stud	D14D	A4731NJ	.35	Bail Stop	D46	R4906	.18
Drive Gear Assembly	D15	E4724	3.15	Line Roller	D47	CY4903	1.75
Non-Reverse Ratchet	D16	E4816	.55	Roller Mounting Bracket Assembly	D49	B5348K	1.25
Drive Gear Thrust Washer	D17	E4726	.05	Roller Lock Nut	D50	B4750N	.25
Level Wind Yoke	D19	DA4761	1.25	Bail Trip Bracket Screw	D51	B4899K	.35
Level Wind Yoke Screw	D19A	E4762	.20	Bail Torsion Spring	D52	E5345	.20
Main Shaft Assembly	D20	E4759	1.90	Roller Mounting Bracket Screw	D53	B5346K	.50
Level Wind Gear Assembly	D21	A4765	.95	Bail Trip Lever	D54	*E4739K	.05
Level Wind Roller	D22	E4766	.15	Bail Trip Lever Pin	D54P	*E4740	.03
Helical Pinion and BB Assembly	D23	E4879	4.35	Bail Trip Lever Spring	D54S	E4741	.10
Helical Pinion Assembly	D23A	**E4709	2.00	Pickup Housing Lock Washer	D55	E4754	.25
Pinion Ball Bearing	D24	**E4710	2.35	Pickup Housing Nut	D56	E4755	.15
Bearing Shield Ring	D24R	R5308	.15	Drag Adjusting Nut Assembly	D57	JK4782	1.45
Bearing Shield	D24S	TF5229	.10				

**DISASSEMBLY and ASSEMBLY INSTRUCTIONS**

1. Unscrew the drag adjusting nut (D57) from the main shaft (D20), then slide spool (D4) off the main shaft. 2. Next, put non-reverse lever (D41) into the forward "ON" position. Remove crank (D14A) by unloosening it with a backward turn and unthreading. Loosen crank locking nut (D12) from crank shaft. Now, your SeaMatic is ready for washing. 3. Using fresh water and brush, scrub exposed parts thoroughly. Be sure to scrub the bail (D45) where it connects to the pickup housing (D2J). When reel has been washed free of salt, dry

all parts carefully with a soft cloth. 4. With reel completely dry, you're ready to begin the lubrication of your reel. Remove oiling screw (D44). Using a light reel oil and grease, following diagram above, oil all parts marked by letter "O" and grease all parts marked by letter "G". Now, replace crank thrust washer, (D13) . . . followed by crank and oil screw. 5. Replace spool (D4) on main shaft (D20) with a rotating movement until it is properly seated. Then replace the drag adjusting nut. Turn crank to see if assembled reel operates properly.

Numbers shown in red common to both South Bend and Shakespeare.

**NOTE: When ordering parts, give reel part name, reel number and model.**