

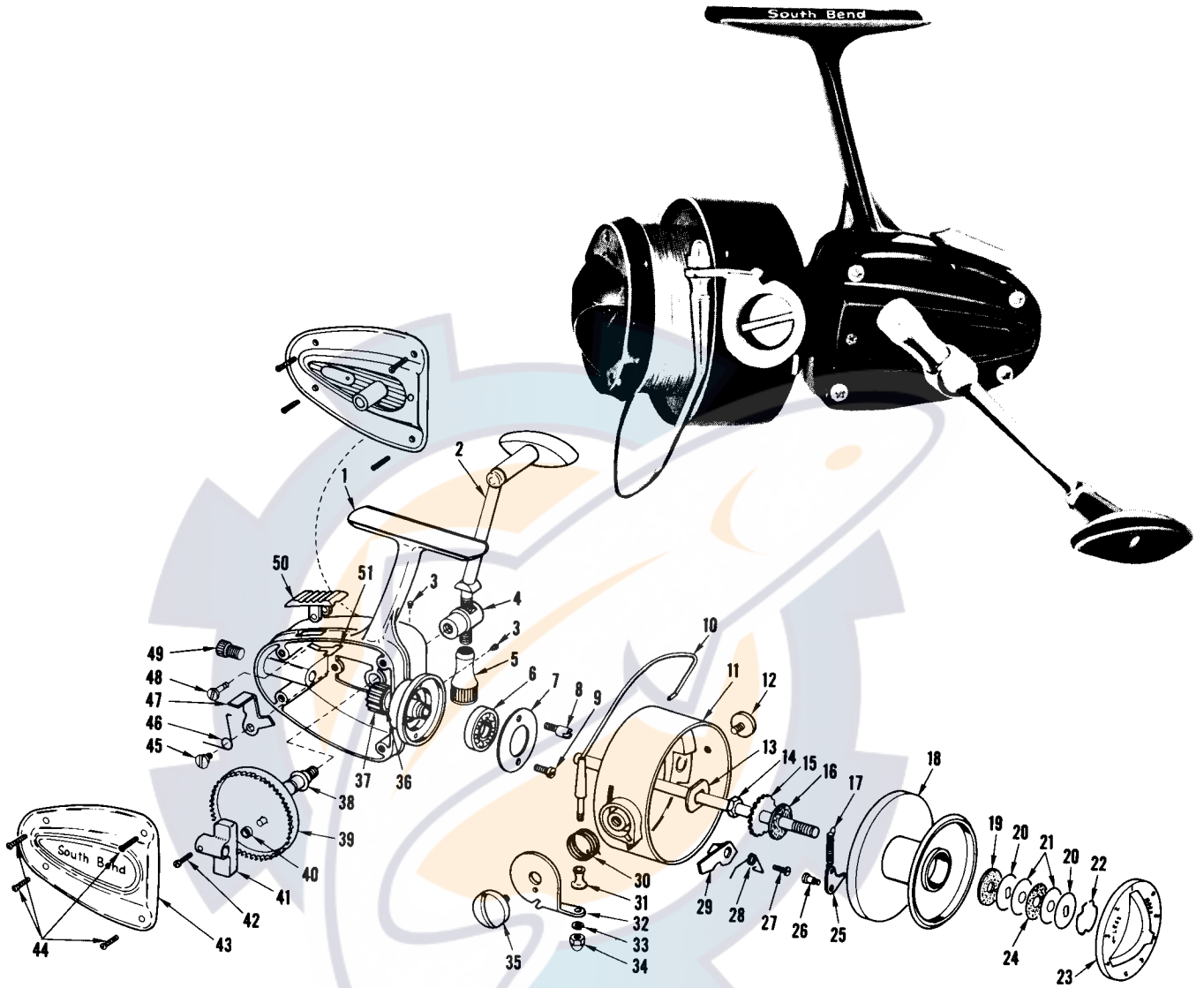

GLADDING
South Bend Tackle Co., Inc.
 Division of **GLADDING** Corporation

740
 3-210-740
SPINNING REEL



Detail No.	Part Name	Part No.	Price	Detail No.	Part Name	Part No.	Price
23	Brake Nut	740/23	.50	33	Lock Washer	740/33	.10
22	Safety Ring	740/22	.10	34	Round Head Nut	740/34	.15
20	Keyed Steel Washer	740/20	.10	30	Changing Spring	740/30	.15
21	Spring Washer	740/21	.15	1	Frame Assembly	740/1	3.00
24	Fiber Washer	740/24	.10	41	Slide	740/41	.25
21	Spring Washer	740/21	.15	40	Washer	740/40	.10
20	Keyed Steel Washer	740/20	.10	42	Screw for Slide	740/42	.10
19	Leather Washer	740/19	.10	38	Roller for Drive Gear	740/38	.10
17	Click Spring	740/17	.15	39	Drive Gear Assembly	740/39	.50
25	Click Tongue	740/25	.15	44	Cover Screw	740/44	.10
26	Lug Screw for Click Tongue	740/26	.10	2	Crank Arm Complete	740/2	1.65
18	Complete Spool Assembly	740/18	2.98	43	Side Plate Cover	740/43	1.00
16	Washer	740/16	.10	47	Anti-Reverse	740/47	.10
12	Bearing Screw	740/12	.20	46	Anti-Reverse Spring	740/46	.10
27	Lug Screw for Stop Lever	740/27	.15	45	Lug Screw for Anti-Reverse	740/45	.10
28	Stop Lever Spring	740/28	.10	48	Anti-Reverse Thumb Lever Pin	740/48	.10
29	Stop Lever	740/29	.25	51	Anti-Reverse Thumb Lever Spring	740/51	.10
13-16	Axle, Complete	740/13-16	.50	49	Guide Screw	740/49	.10
14	Hexagon Nut	740/14	.10	50	Anti-Reverse Thumb Lever	740/50	.50
13	Tongue Washer	740/13	.10	37	Drive Pinion	740/37	.85
11	Flange	740/11	2.25	6	Ball Bearing	740/6	1.50
10	Pick-Up Arm	740/10	.85	7	Ball Bearing Washer	740/7	.20
31	Line Guide	740/31	.25	8	Ball Bearing Large Screw	740/8	.15
32	Angle Lever	740/32	.25	9	Ball Bearing Small Screw	740/9	.10
35	Bearing Screw for Angle Lever	740/35	.40	3	Oiler Cap	740/3	2@.05