

STAR DRAG TROLLING REEL

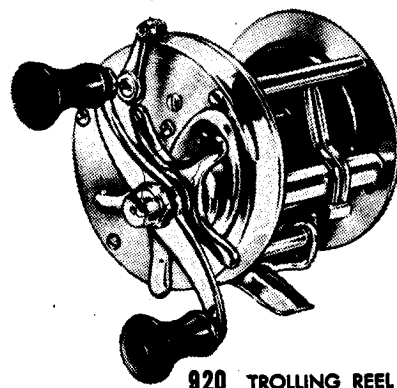

920 TROLLING REEL

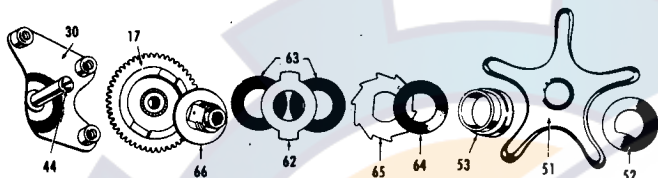
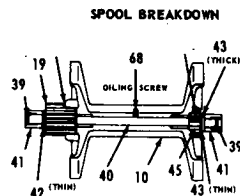

DRIVE GEAR AND STAR DRAG PARTS

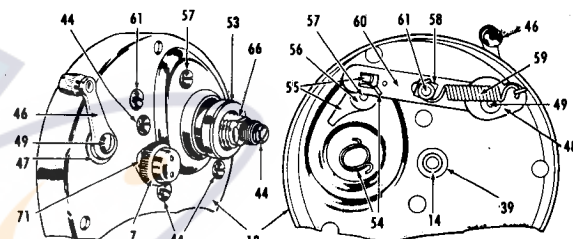

THROWOUT PARTS FOR NON-REVERSING CRANK

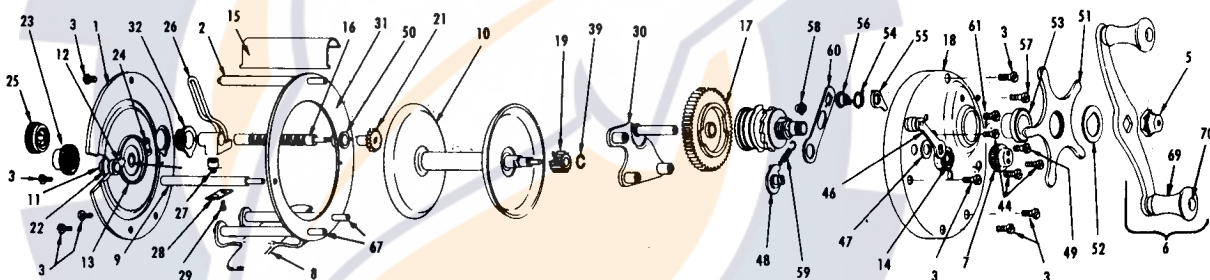

Diagram No.	Part Name	Reel 920			Diagram No.	Part Name	Reel 920		
		Part No.		Price			Part No.		Price
1	Tail Plate Assembly	RH-36	B5283CNK	\$2.10	41	Spool Axis Bushing	R-53		.25
2	Top Pillar	RA-33	B1241K	.35	42	Spool Thrust Washer — Thin	R-54	NE5280	.05
3	Pillar Screw	R-18	B840K	.03	43	Spool Thrust Washer — Thick	RA-54	N5281	.05
5	Crank Nut Assembly	RD-11	B2993N	.40	44	Bridge Screw	R-2	N5282	.03
6	Crank Assembly	RT-12	BP3183K	1.90	45	Click Ratchet	R-50	B-555K	.25
7	Spool Cap Assembly (Head)	RG-20	B5262K	1.45	46	Throw Out Lever Assembly	R-55	E4977	.30
8	Rod Clip	RE-31	B4050K	.45	47	Throw Out Lever Washer	R-56	B795K	.10
9	Side Pillar	RA-32	B1242K	.30	48	Throw Out Lever Cam. Assembly	R-57	B107K	.45
10	Spool Assembly	RW-19		4.05	49	Throw Out Lever Screw	R-2	B685	.03
11	Click Button Stem	RB-26	E-S18	.10	50	Carriage Screw Head Bushing	RB-47	B-555K	.15
12	Click Pawl	E1310		.05	51	Gear Drag Star	RA-43	PB919	.85
13	Click Spring	RA-10	E1402	.10	52	Gear Drag Star Washer	R-58	B-S237K	.10
14	Spool Bushing Insert	RA-45		.15	53	Gear Drag Spacing Sleeve	R-59	PB-S340N	.25
15	Line Protector	R-21	B813K	.20	54	Gear Drag Pawl Spring	R-60	B3171N	.15
16	Line Carriage Screw	RJ-7	B928K	.55	55	Gear Drag Pawl	R-62	NE781	.10
17	Drive Gear Assembly	RA-16	B793	1.05	56	Gear Drag Pawl Stud	R-63	E780	.10
18	Head Cap Assembly	RH-28		2.85	57	Gear Drag Pawl Screw	R-2	B783	.03
19	Spool Pinion	RK-17	E4978	.40	58	Gear Drag Slide Nut	R-65	B-555K	.10
21	Carriage Screw Pinion	RD-8	PB929	.40	59	Gear Drag Throw Out Spring	R-64	B790	.15
22	Click Button	RA-37	B-S17N	.10	60	Gear Drag Throw Out Slide	R-66	NE910	.10
23	Spool Cap Assembly (Tail)	RG-20T	B5270K	.55	61	Gear Drag Slide Screw	R-2	B789	.03
24	Click Spring Rivet	CC-43		.03	62	Gear Drag Eared Washer	R-67	B-555K	.10
25	Carriage Screw Tail Bushing Cap	RA-25	B962K	.45	63	Gear Drag Friction Washer	R-68	PB779	.03
26	Carriage	RB-3	MB2705K	.85	64	Gear Drag Spring Washer	R-69	FR-S232	.10
27	Carriage Pawl	R-4	E2551CA	.15	65	Gear Drag Ratchet	R-70	PB-S264	.15
28	Carriage Pawl Retainer	R-5	B1022K	.05	66	Drive Gear Stem	RE-16	B784	.95
29	Carriage Pawl Retainer Screw	R-6	B1012K	.03	67	Bottom Pillar Use with RE-31	R-71	B3169	.30
30	Bridge Assembly	RE-22		1.50	68	Line Hole Screw	R-72	B4051K	.10
31	Head Ring Assembly	RJ-29		2.15	69	Crank Handle	RA-39	A4045	.55
32	Carriage Screw Tail Bushing	R-24	B958N	.20	70	Crank Stud	RA-40	BP2891	.15
39	Spool Pinion Ring	R-51	PB96	.02	71	Spool Cap Friction Grip	R-73	B-S120	.02
40	Spool Axis	R-52	NE5279	.25					

OILING and GREASING

OILING your reel is necessary to insure proper operation and performance satisfaction. Oil parts indicated in diagram above. A light household oil is recommended.

GREASING is also necessary for proper reel performance. Using a light grease, such as Lubriplate, grease parts as indicated in diagram.

It is a good policy to take good care of your tackle. At the end of a fishing season disassemble your reel, clean thoroughly with a grease solvent, grease and oil the parts and reassemble. At the same time check parts for wear and replace worn parts. (See How to Order Repair Parts for buying new parts.)

Numbers shown in red common to both South Bend and Shakespeare.

NOTE: When ordering parts, give reel part name, reel number and model.