

South Bend

Division of GLADDING Corporation

Quick Super #270

SPARE PARTS CATALOG AND PRICE LIST

Effective 8/1/66

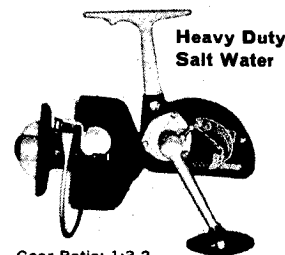
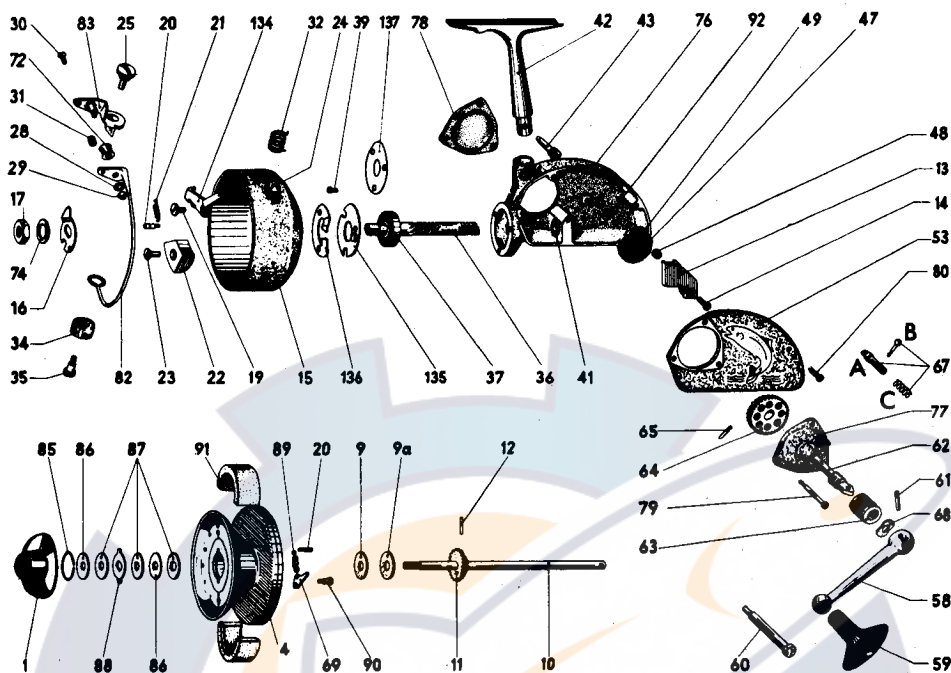

Gear Ratio: 1:3.2
Weight: 21 oz.
Capacity:
350 yds. 15 lb. line
260 yds. 20 lb. line



PART NO.	DESCRIPTION	PRICE	PART NO.	DESCRIPTION	PRICE	PART NO.	DESCRIPTION	PRICE
270/1	Brake Nut, Complete	\$2.25	270/30	Screw for Angle Lever	\$.10	270/67B	Ball Pin for Anti-Reverse Clutch	\$.30
* 270/2	Security Ring	\$.10	270/31	Spacing Bushing	\$.25	270/67C	Spring for Anti-Reverse Clutch	\$.10
* 270/3	Tongue Washer	\$.15	270/32	Changing Spring	\$.25	270/68	Spring Ring	\$.15
270/4	Line Spool, without Brake Nut (Specify Deep or Shallow)	\$5.00	270/34	Cap for Pick-up Arm	\$.15	270/69	Ratchet	\$.15
* 270/5	Ratchet	\$.15	270/35	Bearing Screw	\$.25	270/70	Plastic Line Clip	\$.25
* 270/6	Ratchet Spring	\$.10	270/36	Driving Shaft	\$4.75	270/72	Line Guide	\$2.75
* 270/7	Screw for Ratchet	\$.15	270/37	Ball Bearing	\$3.00	* 270/73	Screw for Ratchet	\$.10
* 270/8	Screw for Ratchet Spring	\$.10	* 270/38	Switch Ring (Use Part No. 270/135, 136 and 137)		270/74	Spring Washer	\$.10
270/9	Washer (Resitex)	\$.10	270/39	Screw for Switch Ring	\$.15	270/75	Bearing Cover (Use 270/77)	
270/9A	Washer (Metal)	\$.10	270/41	Bearing Bushing	\$.30	270/76	Case with Bushing	\$5.25
270/10K	Axle, Complete	\$1.50	270/42	Reel Stand	\$2.00	270/77	Bearing Cover with Bushing and Oiler	\$2.75
270/11	Ratchet Wheel	\$.25	270/43	Cone Screw	\$.50	270/78	Plate Cover	\$.80
270/12	Pin for Ratchet Wheel	\$.10	270/47	Worm Wheel with Pin	\$2.10	270/79	Screw for Bearing Cover	\$.15
270/13	Slide	\$.60	270/48	Roller	\$.15	270/80	Screw for Case Cover	\$.10
270/14	Screw for Slide	\$.10	270/49	Screw for Roller	\$.15	270/82	Pick-up Arm	\$4.50
270/15	Flange, with Parts No. 22 & 23	\$4.25	270/53	Case Cover	\$1.50	270/83	Angle Lever	\$1.30
270/16	Driving Washer	\$.25	* 270/57	Oil Screw	\$.10	270/85	Spring Ring	\$.10
270/17	Hexagon Nut	\$.25	270/58	Crank Arm	\$2.50	270/86	Tongue Washer	\$.15
* 270/18	Stop Lever (Use Part No. 270/134)		270/59	Handle Grip	\$.50	270/87	Washer (Resitex)	\$.10
270/19	Lug Screw	\$.40	270/60	Grip Screw	\$.60	270/88	Tongue Washer	\$.15
270/20	Stop Pin	\$.10	270/61	Pin for Crank Arm	\$.15	270/89	Ratchet Spring	\$.15
270/21	Spring	\$.15	270/62	Driving Axle	\$1.00	270/90	Pin for Ratchet	\$.10
270/22	Counter - Weight	\$.60	270/63	Handle Nut	\$.50	270/91	Cork Ring (2 Halves)	\$.30
270/23	Screw for Counter - Weight	\$.10	270/64	Driving Wheel	\$2.25	270/92	Washer	\$.10
270/24	Rubber Buffer with Spring	\$.15	270/65	Pin for Driving Wheel	\$.10	270/134	Stop Lever	\$.50
270/25	Bearing Screw	\$.35	* 270/66	Anti-Reverse Clutch, Old Model	\$.50	270/135	Switch Ring	\$.40
* 270/26	Angle Lever (Use 270/83)		270/67	Anti-Reverse Clutch, Complete		270/136	Braking Ring	\$.30
270/28	Lock Washer	\$.10		New Model	\$.80	270/137	Gasket	\$.10
270/29	Hexagon Nut	\$.15	270/67A	Bolt for Anti-Reverse Clutch	\$.40			

* Parts marked by a Star are not used on current Quick Super #270 Models but are available as Spare Parts.

A new series of spare parts have recently been introduced to prevent the pick-up arm from tripping prematurely during the cast. The new bail switch components may also be used on older Quick Super #270 models. The new bail switch may be installed by replacing the old spare part number 270/38 - switch ring, with the new spare part numbers 270/135 - switch ring, 270/136 - braking ring, and 270/137 - gasket. When making this conversion, the old spare part number 270/18 must also be replaced by the new spare part number 270/134 - stop lever.

South Bend Tackle Company, Inc.
Division of GLADDING Corporation
South Otsell, New York 13155

