

ZEBCO 608

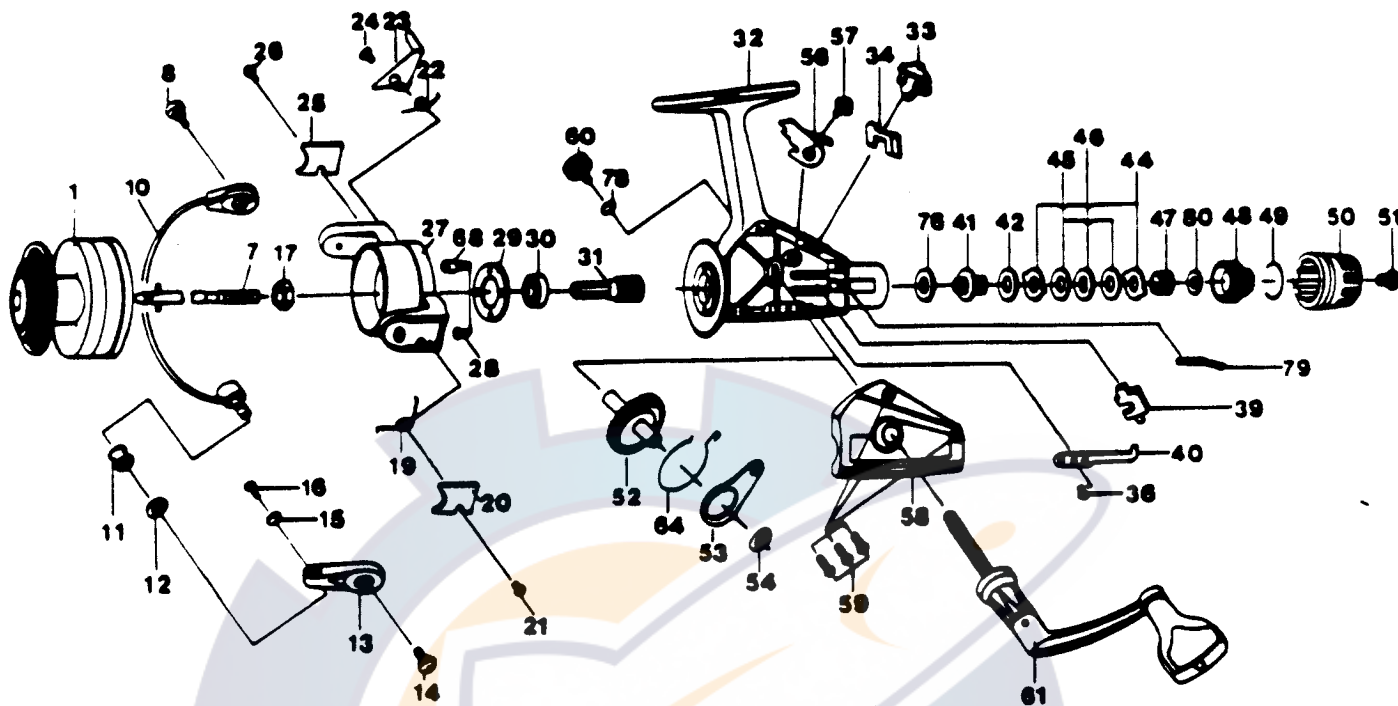

KEY PART NO. NO.	DESCRIPTION	PRICE	KEY PART NO. NO.	DESCRIPTION	PRICE
1 JS321	SPOOL ASSY.	6.02	39 FS081	PIN SLIDER	1.14
7 GS315	CTR SHAFT ASSY.	2.93	40 FS068	CLICK CLAM	1.14
8 GS048	BAIL SCREW B	1.12	41 FS104	SLIDER HOLDER	.85
10 GS347	BAIL ASS'Y	6.02	42 FS046	DRAG WASHER C	.46
11 NB004	LINE ROLLER	1.09	44 FS030	DRAG WASHER A	.85
12 FS016	LN/ROLLER/BUSH.	1.09	45 VB039	DRAG WASHER B	.46
13 GS007	BAIL ARM A	1.72	46 VB071	DRAG WASHER D	.34
14 GS051	BAIL SCREW A	1.09	47 VB031	DRAG COIL SPR	.80
15 FS102	BAIL AXLE WASH	.58	48 FS112	DRAG NUT	.85
16 FS108	BAIL AXLE SCREW	.39	49 VB070	DRAG RET. RING	.52
17 RB006	ROTOR NUT	.58	50 JS032	DRAG KNOB	1.55
19 RB022	BAIL SPR. PS20	.52	51 FS079	DRAG SCREW	.63
20 JS087	BAIL SPRING COVER	.85	52 FS012	CRANK GEAR 4110-20	2.41
21 FS085	BAIL TRIP LVR CVR	.39	53 FS025	OSCILLATOR SLIDER	1.32
22 RB049	TRIP LVR. SPR.	.69	54 RB026	CRANK GEAR SKIN	.29
23 RB019	TRIP LVR. PS20	.39	56 FS063	A/R PAML	1.72
24 RB037	TRIP LEVER SCREW	.85	57 FS089	A/R SCREW	.58
25 JS024	TRIP LVR. COVER	.39	58 JS323	SIDE PLATE ASSY.	5.16
26 FS085	BAIL TRIP LVR CVR	.39	59 FS057	SLIDE PLATE SCR.	.85
27 JS009	ROTOR	6.08	60 FS073	HANDLE CAP	1.09
28 NB080	BEARING RET. SCR.	.29	61 FS318	HANDLE ASSY	6.31
29 RB040	BEARING RET.	.58	64 RB086	SLIDER SPRING	.39
30 FS028	BALL BEARING	8.60	68 RB062	KICK LEVER PIN	.29
31 FS011	PIN.GEAR 4110,20	3.78	76 FS035	DRAG WASHER E	.46
32 JS301	BODY ASSY.	5.85	78 FS105	HNDLE SCR. WASH	.46
33 FS059	A/R LEVER	.63	79 FS033	BACK CLAM	1.09
34 FS090	A/R LVR. SP.	1.09	80 FS036	REAR DRAG WASH	.46
36 NB080	BEARING RET. SCR.	.29			

Prices subject to change without notice. Prices do not include postage and handling.

PLEASE ORDER BY PART NUMBER

Rev. 11/90

Zebco Division Brunswick Corporation, Box 270, Tulsa, OK 74101 USA 918-686-6881

